



B

# MCR-E410

(RX-E410 + CDX-E410 + NX-E800)

*RECEIVER/CD PLAYER*



OWNER'S MANUAL

# CAUTION: READ THIS BEFORE OPERATING YOUR UNIT.

- 1 To assure the finest performance, please read this manual carefully. Keep it in a safe place for future reference.
- 2 Install this unit (RX-E410 and CDX-E410) in a well ventilated, cool, dry, clean place with at least 10 cm on the top (except for CDX-E410), 10 cm on the left and right, and 10 cm at the back of this unit — away from direct sunlight, heat sources, vibration, dust, moisture, and/or cold.
- 3 Locate this unit away from other electrical appliances, motors, or transformers to avoid humming sounds.
- 4 Do not expose this unit to sudden temperature changes from cold to hot, and do not locate this unit in an environment with high humidity (i.e. a room with a humidifier) to prevent condensation inside this unit, which may cause an electrical shock, fire, damage to this unit, and/or personal injury.
- 5 Avoid installing this unit where foreign object may fall onto this unit and/or this unit may be exposed to liquid dripping or splashing. On the top of this unit, do not place:
  - Other components, as they may cause damage and/or discoloration on the surface of this unit.
  - Burning objects (i.e. candles), as they may cause fire, damage to this unit, and/or personal injury.
  - Containers with liquid in them, as they may fall and liquid may cause electrical shock to the user and/or damage to this unit.
- 6 Do not cover this unit with a newspaper, tablecloth, curtain, etc. in order not to obstruct heat radiation. If the temperature inside this unit rises, it may cause fire, damage to this unit, and/or personal injury.
- 7 Do not plug in this unit to a wall outlet until all connections are complete.
- 8 Do not operate this unit upside-down. It may overheat, possibly causing damage.
- 9 Do not use force on switches, knobs and/or cords.
- 10 When disconnecting the power cable from the wall outlet, grasp the plug; do not pull the cable.
- 11 Do not clean this unit with chemical solvents; this might damage the finish. Use a clean, dry cloth.
- 12 Only voltage specified on this unit must be used. Using this unit with a higher voltage than specified is dangerous and may cause fire, damage to this unit, and/or personal injury. YAMAHA will not be held responsible for any damage resulting from use of this unit with a voltage other than specified.
- 13 Do not attempt to modify or fix this unit. Contact qualified YAMAHA service personnel when any service is needed. The cabinet should never be opened for any reasons.
- 14 When not planning to use this unit for long periods of time (i.e. vacation), disconnect the AC power plug from the wall outlet.
- 15 Be sure to read the “Troubleshooting” section on common operating errors before concluding that this unit is faulty.
- 16 Before moving this unit, press STANDBY/ON to set this unit in standby mode, and disconnect the AC power plug from the wall outlet.
- 17 Condensation will form when the surrounding temperature changes suddenly. Disconnect the power cable from the outlet, then leave the unit alone.
- 18 When using the unit for a long time, the unit may become warm. Turn the power off, then leave the unit alone for cooling.
- 19 Install this unit near the wall outlet and where the AC power plug can be reached easily.

This unit is not disconnected from the AC power source as long as it is connected to the wall outlet, even if this unit itself is turned off. This state is called the standby mode. In this state, this unit is designed to consume a very small quantity of power.

## CAUTION

Use of controls or adjustments or performance of procedures other than those specified herein may result in hazardous radiation exposure.

## DANGER

When this unit is plugged to the wall outlet, do not place your eyes close to the opening of the disc tray and other openings to look into inside.

The laser component in this product is capable of emitting radiation exceeding the limit for Class 1.

## WARNING

TO REDUCE THE RISK OF FIRE OR ELECTRIC SHOCK, DO NOT EXPOSE THIS APPLIANCE TO RAIN OR MOISTURE.

## ■ For U.K. customers

If the socket outlets in the home are not suitable for the plug supplied with this appliance, it should be cut off and an appropriate 3 pin plug fitted. For details, refer to the instructions described below.

### Note

The plug severed from the mains lead must be destroyed, as a plug with bared flexible cord is hazardous if engaged in a live socket outlet.

## ■ Special Instructions for U.K. Model

### IMPORTANT

THE WIRES IN MAINS LEAD ARE COLOURED IN ACCORDANCE WITH THE FOLLOWING CODE:

Blue: NEUTRAL

Brown: LIVE

As the colours of the wires in the mains lead of this apparatus may not correspond with the coloured markings identifying the terminals in your plug, proceed as follows: The wire which is coloured BLUE must be connected to the terminal which is marked with the letter N or coloured BLACK. The wire which is coloured BROWN must be connected to the terminal which is marked with the letter L or coloured RED.

Making sure that neither core is connected to the earth terminal of the three pin plug.

# Contents

## INTRODUCTION

<b>Features</b> .....	2
<b>Supplied Accessories</b> .....	2
<b>Controls and Functions</b> .....	3
Receiver (RX-E410) .....	3
CD player (CDX-E410) .....	6
Remote control .....	8

## PREPARATION

<b>Connecting the System</b> .....	12
<b>Connecting Antennas</b> .....	14
Connecting the AM loop antenna .....	14
Connecting the FM antenna .....	14
<b>Connecting External Components</b> .....	15
Connecting an MD player or a tape deck .....	15
Connecting an MD recorder or a CD recorder .....	15
Connecting a YAMAHA iPod universal dock .....	16
<b>Connecting the Power Cables</b> .....	17
<b>Adjusting the Clock</b> .....	18

## BASIC OPERATIONS

<b>Basic Receiver Operations</b> .....	19
Changing the front panel display settings .....	20
<b>Basic Disc Playback Operations</b> .....	21
Switching the playback information display .....	22
Repeating playback (Repeat Play) .....	24
Playing back randomly (Random Play) .....	24
Customizing playback order (Program Play) .....	25

## TUNER OPERATIONS

<b>FM/AM Tuning</b> .....	26
Automatic tuning .....	26
Manual tuning .....	26
Automatic preset tuning .....	27
Manual preset tuning .....	27
Selecting preset stations .....	28
<b>Radio Data System Tuning (U.K. and Europe Models Only)</b> .....	29
Selecting the Radio Data System program .....	29
Displaying the Radio Data System information .....	30

## OTHER OPERATIONS

<b>Setting the Timer</b> .....	32
Setting the clock timer .....	32
Setting the sleep timer .....	33
<b>Setting the auto-standby mode</b> .....	34
<b>Controlling iPod</b> .....	35
Available iPod operations .....	35
Using iPod .....	36

## ADDITIONAL INFORMATION

<b>Troubleshooting</b> .....	38
Receiver (RX-E410) .....	38
CD player (CDX-E410) .....	41
Remote control .....	41
<b>Notes on Discs</b> .....	42
Disc information .....	42
Handling a disc .....	42
<b>Glossary</b> .....	43
Audio information .....	43
Copyright and logo marks .....	43
<b>Specifications</b> .....	44

INTRODUCTION

PREPARATION

BASIC  
OPERATIONS

TUNER  
OPERATIONS

OTHER  
OPERATIONS

ADDITIONAL  
INFORMATION

English

# Features

## Receiver (RX-E410)

- Maximum RMS output power per channel  
65W + 65W (1% THD, 1 kHz, 6Ω)
- 40-station FM/AM preset tuning
- iPod dock terminal
- Pure Direct mode

## CD player (CDX-E410)

- Plays Audio CDs, MP3 CDs, and WMA CDs.
- CD Text data display
- Optical and coaxial digital output jacks

## ■ About this manual

- In this manual, “RX-E410” is described as “receiver” and “CDX-E410” is described as “CD player”.
- This manual describes how to operate the system using a remote control except when it is not available. Some of these operations are also available using the front panel buttons.
- ✨ indicates a tip for your operation.
- Notes contain important information about safety and operating instructions.
- This manual is printed prior to production. Design and specifications are subject to change in part as a result of improvements, etc. In case of differences between the manual and the product, the product has priority.

# Supplied Accessories

This product includes the following accessories. Before connecting this system, make sure you received all of the following parts.

Remote control

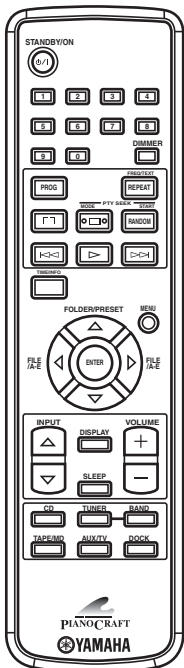

Batteries (x2)  
(AA, R06, UM-3)

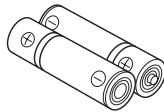

Indoor FM antenna

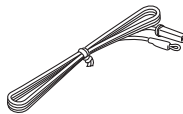

Audio pin cable (1.5 m)

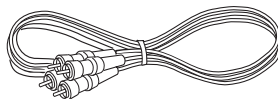

System control cable (0.6 m)

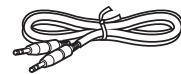

AM loop antenna

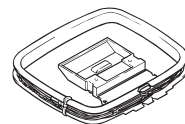

# Controls and Functions

## Receiver (RX-E410)

### ■ Front panel

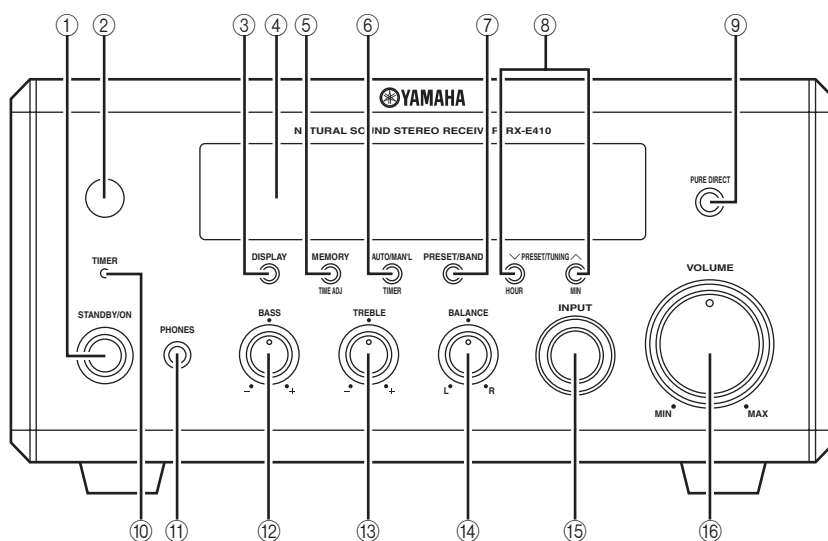

#### ① STANDBY/ON

Turns the receiver on or sets it to the standby mode.

#### ② Remote control sensor

Receives signals from the remote control.

#### ③ DISPLAY

Switches the information shown in the front panel display (see page 20).

#### ④ Front panel display

Shows the various information such as the clock time or the tuning frequency.

#### ⑤ MEMORY (TIME ADJ)

- Stores a preset station in the memory. Hold down this key for more than 2 seconds to preset radio stations automatically (see page 27).
- Sets the clock before using the timer function (see page 18).

#### ⑥ AUTO/MAN'L (TIMER)

- Switches between Automatic Tuning mode and Manual Tuning mode when tuner is selected as an input source (see page 26).
- Turns the clock timer function on or off (see page 32).

#### ⑦ PRESET/BAND

Switches between FM, AM, and the preset mode when tuner is selected as an input source.

#### ⑧ PRESET/TUNING $\checkmark$ / $\wedge$ (HOUR, MIN)

Selects a tuning frequency when tuner is selected as an input source.

#### ⑨ PURE DIRECT

Turns on or off the Pure Direct mode (see page 19).

#### ⑩ TIMER indicator

Lights up when the clock timer is on (see page 32).

#### ⑪ PHONES

Outputs audio signals for private listening with headphones.

#### ⑫ BASS

Adjusts the low frequency response (see page 19).

#### ⑬ TREBLE

Adjusts the high frequency response (see page 19).

#### ⑭ BALANCE

Adjusts the volume level of each left and right speaker channel (see page 19).

#### ⑮ INPUT

Selects an input source.

#### ⑯ VOLUME

Adjusts the volume level.

■ Rear panel

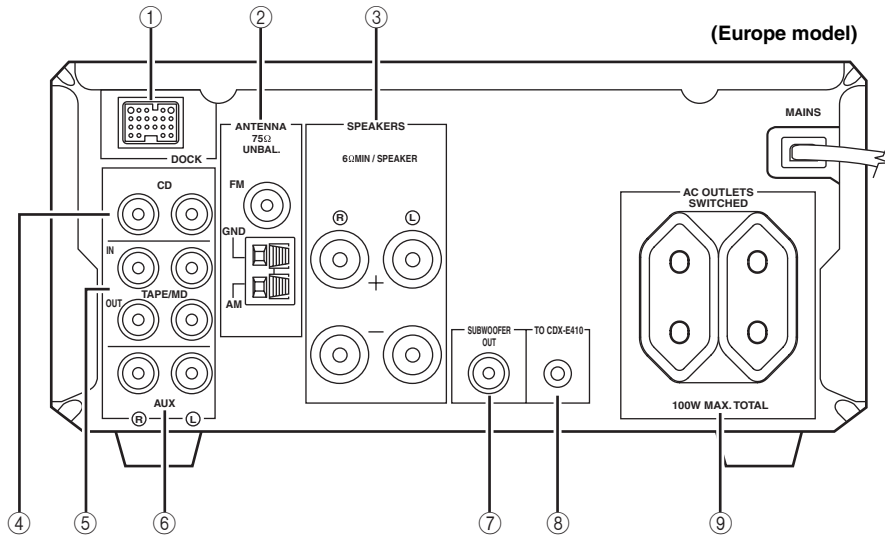

① **DOCK terminal**

Use to connect a YAMAHA iPod universal dock (such as YDS-10 sold separately) where your iPod can be stationed (see page 16).

② **Antenna terminals**

See page 14 for connection information.

③ **Speaker terminals**

See page 13 for connection information.

④ **CD jacks**

See page 12 for connection information.

⑤ **TAPE/MD IN/OUT jacks**

See page 15 for connection information.

⑥ **AUX jacks**

Use to connect the external components.

⑦ **SUBWOOFER OUT jack**

Use to connect the subwoofer.

⑧ **System connector (TO CDX-E410) jack**

See page 12 for connection information.

⑨ **AC OUTLET(S)**

See page 17 for connection information.

## ■ Front panel display

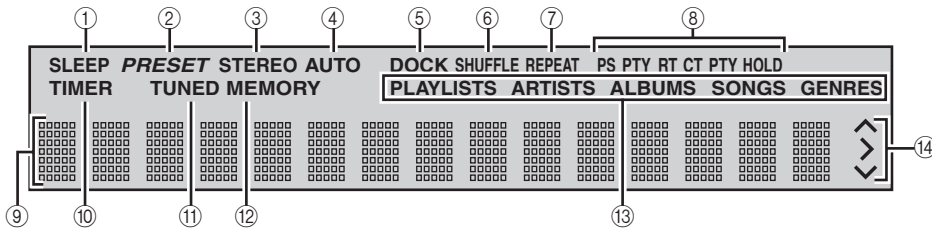

### ① SLEEP indicator

Lights up when the sleep timer is on (see page 33).

### ② PRESET indicator

Lights up when you preset radio stations manually (see page 27).

### ③ STEREO indicator

Lights up when the receiver is receiving a strong signal from an FM stereo broadcast.

### ④ AUTO indicator

Lights up when the receiver is in the Automatic Tuning mode (see page 26).

### ⑤ DOCK indicator

Lights up when you station your iPod in a YAMAHA iPod universal dock (such as YDS-10 sold separately) connected to the DOCK terminal of the receiver (see page 16).

### ⑥ SHUFFLE indicator

Lights up when you set your iPod in shuffle mode.

### ⑦ REPEAT indicator

Lights up when you set your iPod in repeat mode.

### ⑧ Radio Data System indicators

The name of the Radio Data System data offered by the currently received Radio Data System station lights up.

### PTY HOLD indicator

Lights up when the receiver is searching for the Radio Data System stations in the PTY SEEK mode (see page 29).

### ⑨ Multi-information display

Shows the various information such as the clock time or the tuning frequency.

### ⑩ TIMER indicator

Flashes when the receiver is in the clock timer setting mode (see page 32).

### ⑪ TUNED indicator

Lights up when the receiver is tuned into a station.

### ⑫ MEMORY indicator

Lights up or flashes when you preset radio stations.

### ⑬ iPod menu indicators

Light up the iPod menu currently selected (see page 36).

### ⑭ iPod operation indicators

Show operable cursor keys when operating the iPod menu with the menu browse mode (see page 36).

## CD player (CDX-E410)

### ■ Front panel

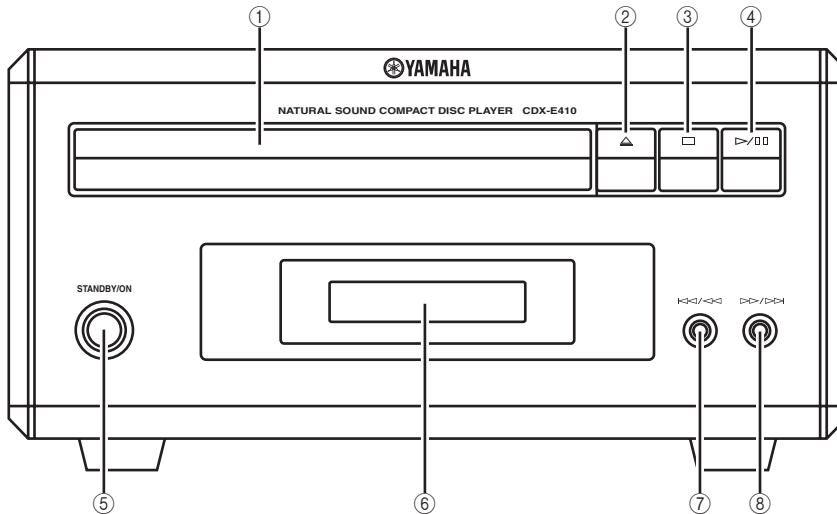

① **Disc tray**

Holds a disc to be played back.



Opens and closes the disc tray.



Stops playback (see page 21).



Starts or pauses playback (see page 21).

⑤ **STANDBY/ON**

Turns the CD player on or sets it to the standby mode.

⑥ **Front panel display**

Shows the current status of the CD player.



Skips to the beginning of the current track. Press and hold to fast reverse (see page 21).



Skips to the next track. Press and hold to fast forward (see page 21).



## ■ Rear panel

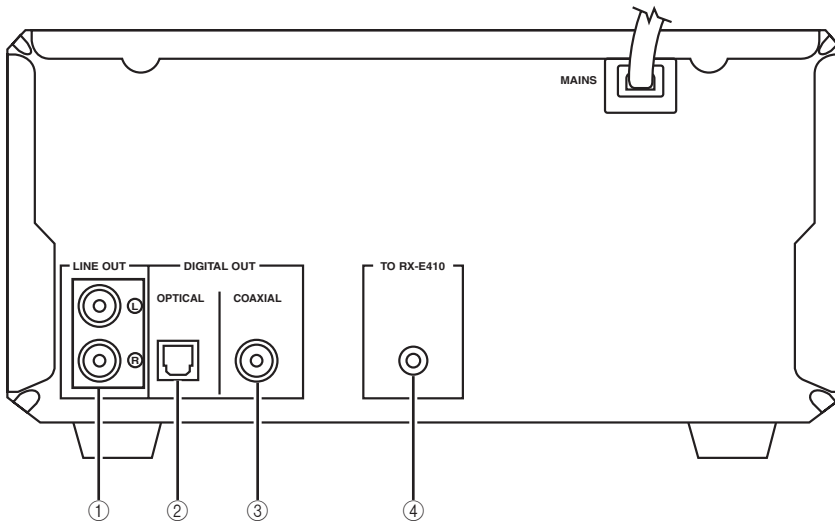

### ① LINE OUT jacks

See page 12 for connection information.

### ② OPTICAL jack

See page 15 for connection information.

### ③ COAXIAL jack

See page 15 for connection information.

### ④ System connector (TO RX-E410) jack

See page 12 for connection information.

## Remote control

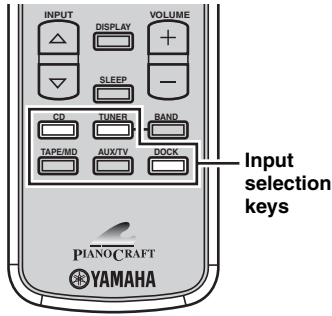

This remote control can operate the PianoCraft system components (including tuner functions) and an iPod stationed in a YAMAHA iPod universal dock connected to the receiver.

To operate the CD player, tuner functions, or an iPod using the remote control, you need to set the receiver to the corresponding input mode.

### To switch the input mode of the receiver

Press the corresponding input selection key on the remote control (or INPUT on the front panel).

The name of the corresponding input source appears in the front panel display of the receiver.



For a complete list of the remote control functions used to control your iPod, refer to “Available iPod operations” (see page 35).

### Common functions

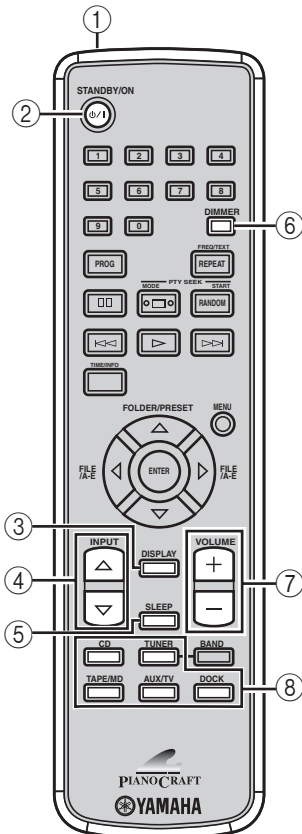

### Operations common to all modes

The following operations are available for the receiver when it is set to any input mode.

#### ① Infrared signal transmitter

Sends signals to the component you want to control.

#### ② STANDBY/ON (⏻/⏻)

Turns the receiver on or sets it to the standby mode.

#### ③ DISPLAY

Switches the information shown in the front panel display (see page 20).

#### ④ INPUT $\triangle$ / $\nabla$

Selects the input source on the receiver.

#### ⑤ SLEEP

Sets the sleep timer on the receiver (see page 33).

#### ⑥ DIMMER

Changes the brightness of the receiver’s front panel display (see page 20).

#### ⑦ VOLUME +/-

Adjusts the overall volume level on the receiver.

#### ⑧ Input selection keys

Select the input source on the receiver.



STANDBY/ON, DIMMER and SLEEP operations also control the CD player by the system control connection (see page 12).

## ■ CD mode

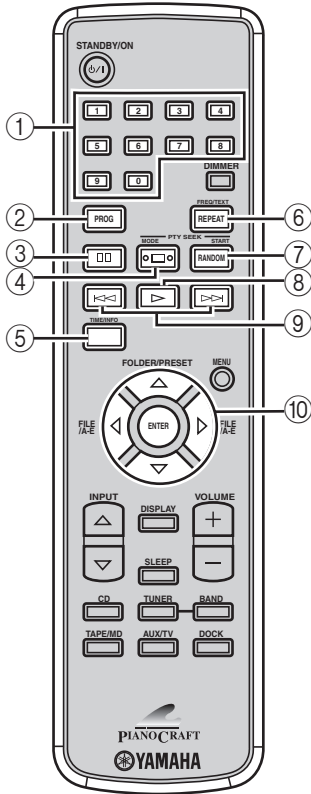

## Operations available in CD mode

The following operations are available for the CD player if the CD player is connected to the receiver with the system control connection (see page 12).



Press CD to set the receiver to the CD mode before carrying out the following operations.

### ① Number keys (1 to 9, 0)

Input numerals to specify track numbers.

### ② PROG

Sets the CD player to the track program mode (see page 25).

### ③ ■■

Pauses playback (see page 21).

### ④ □

Stops playback (see page 21).

### ⑤ TIME/INFO

Switches the disc information shown in the CD player's front panel display (see page 22).

### ⑥ REPEAT

Selects the Repeat Play mode (see page 24).

### ⑦ RANDOM

Turns on/off the Random Play feature (see page 24).

### ⑧ ▷

Starts playback (see page 21).

### ⑨ ◀◀, ▶▶

Skips to the beginning of the current track or next track. Press and hold to fast reverse or fast forward (see page 21).

### ⑩ FOLDER ▲ / ▼, FILE ◀ / ▶, ENTER

Press FOLDER ▲ / ▼ to select a folder and FILE ◀ / ▶ to select a file for an MP3 or a WMA disc (see page 21).

■ TUNER mode

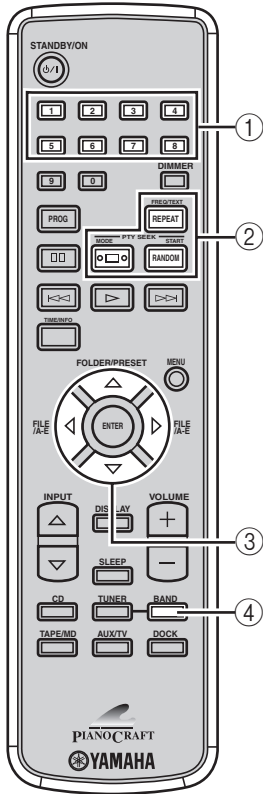

**Operations available in TUNER mode**

The following operations are available for the receiver.



Press TUNER to set the receiver to the TUNER mode before carrying out the following operations.

① **Number keys (1 to 8)**  
Selects preset station number (see page 28).

② **Radio Data System tuning keys**

**FREQ/TEXT**

Switches the Radio Data System display between the PS mode, PTY mode, RT mode, CT mode (if the station offers the corresponding data services) and the frequency display (see page 30).

**PTY SEEK MODE**

Sets the receiver to the PTY SEEK mode (see page 29).

**PTY SEEK START**

Starts searching for a station once the desired program type is selected in the PTY SEEK mode (see page 29).

③ **A-E** , **PRESET** /

Press A-E to select a preset station group (A to E) and PRESET / to select a preset station number (1 to 8) (see page 28).

④ **BAND**

Switches the radio reception mode between FM, AM and the preset mode.

## ■ Installing the batteries in the remote control

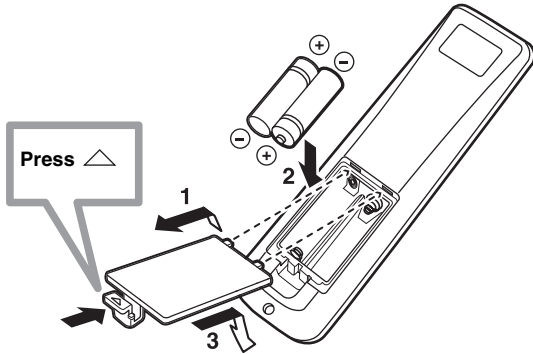

**1** Press the  $\triangle$  mark on the battery cover and open the cover.

**2** Insert the two supplied batteries (AA, R06, UM-3) into the battery compartment.

Make sure you insert the batteries according to the polarity markings (+ and -).

**3** Close the battery cover.

### Notes

- Do not use an old battery together with new one.
- Do not use different types of batteries (for example, alkaline and manganese) together. Each type of battery has its own characteristics even if they are similar in shape.
- If the batteries run out, immediately remove them from the remote control to prevent an explosion or acid leak.
- Dispose of the batteries according to the regional regulations.
- If a battery starts leaking, dispose of it immediately. Be careful not to let leaking battery acid come into contact with your skin or clothing. Before inserting new batteries, wipe the compartment clean.

## ■ Using the remote control

Use the remote control within 6 m (20 feet) of the component you want to control and point it toward its remote control sensor (see page 3).

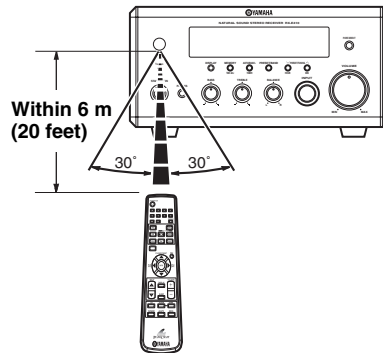

### Notes

- Be careful not to spill liquid on the remote control.
- Be careful not to drop the remote control.
- Do not leave the remote control in the following places:
  - hot or humid places, such as near a heater or in a bathroom
  - extremely cold places
  - dusty places

# Connecting the System

Make sure you read the following procedure and notes carefully before connecting the system. For information on the speakers (NX-E800), refer to the owner's manual supplied with it.

## Note

Do not connect the power cable of the receiver, CD player, or other components to the wall outlet until all cable connections are completed.

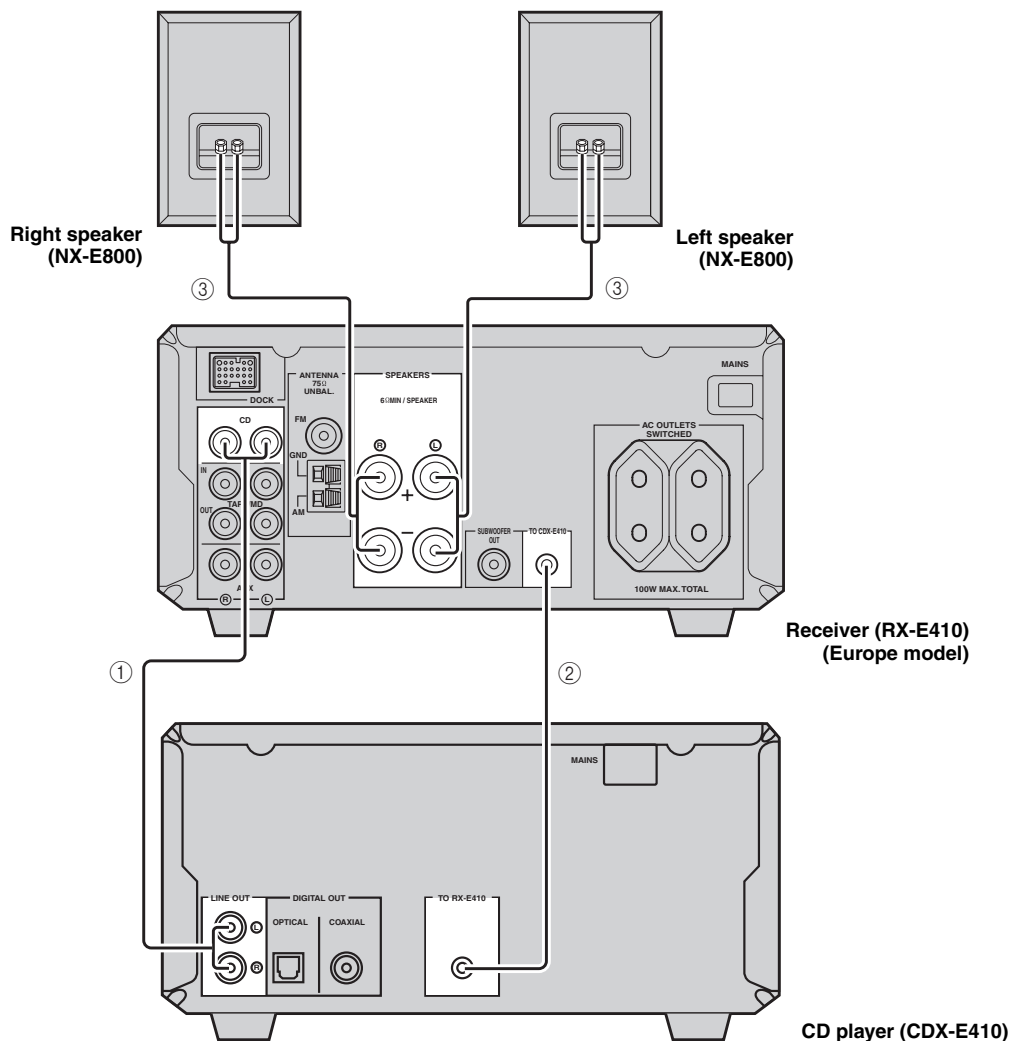

- ① Connect the CD (L/R) jacks of the receiver to the LINE OUT (L/R) jacks of the CD player using the supplied audio pin cable.
- ② Connect the system connector (TO CDX-E410) jack of the receiver to the system connector (TO RX-E410) jack of the CD player using the supplied system control cable.
- ③ Connect the speaker terminals (L) of the receiver to the speaker terminals of the left speaker and the speaker terminals (R) of the receiver to the speaker terminals of the right speaker using the speaker cables supplied with the speaker set (NX-E800). See page 13 for details.



- The system control connection is used to transmit the remote control signals from the receiver to the CD player.
- If you want to connect an amplifier with a digital input instead of the RX-E410, use the DIGITAL OUT (COAXIAL or OPTICAL) jacks of the CD player.

## ■ Connecting the speaker cable

### Notes

- Be sure to connect the left channel (L), right channel (R), “+” (red) and “-” (black) properly. If the connections are faulty, no sound will be heard from the speakers, and if the polarity of the speaker connections is incorrect, the sound will be unnatural and lack bass.
- Do not let the bare speaker wires touch each other or do not let them touch any metal part of the receiver. This could damage the receiver and/or the speakers.
- When connecting another speaker set instead of the NX-E800, be sure to use speakers with the specified impedance shown on the rear panel of the receiver and magnetically shielded. In case the magnetically shielded speakers interfere with the monitor, place the speakers away from the monitor.

- 1 Remove approximately 10 mm (3/8 in) of insulation from the end of each speaker cable and then twist the exposed wires of the cable together to prevent short circuits.

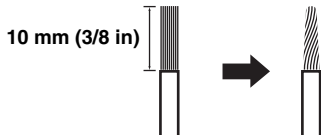

- 2 Unscrew the knob.

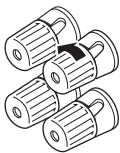

Red: positive (+)  
Black: negative (-)

- 3 Insert the bare wire into the terminal.

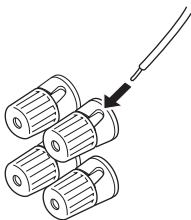

Red: positive (+)  
Black: negative (-)

- 4 Tighten the knob to secure the wire.

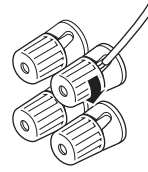

Red: positive (+)  
Black: negative (-)

# Connecting Antennas

To enjoy radio on the receiver, connect the supplied AM and FM antennas to the designated terminals. If there is a problem of weak radio wave reception in your area or you want to improve radio reception, we recommend that you use optional outdoor antennas. For details, consult the nearest authorized YAMAHA dealer or service center.

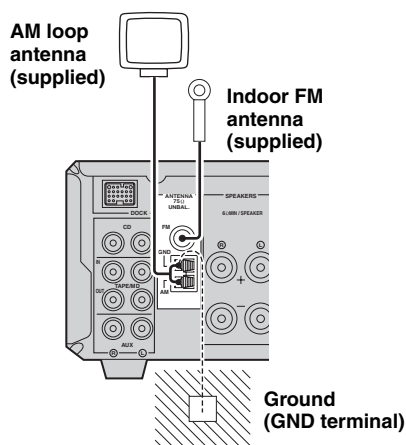

## About grounding

For maximum safety and minimum interference, connect the antenna GND terminal to a good earth ground. A good earth ground is a metal stake driven into moist earth.

## Connecting the AM loop antenna

### 1 Attach the antenna stand to the antenna.

When attaching the antenna to the wall, you do not need to use the antenna stand.

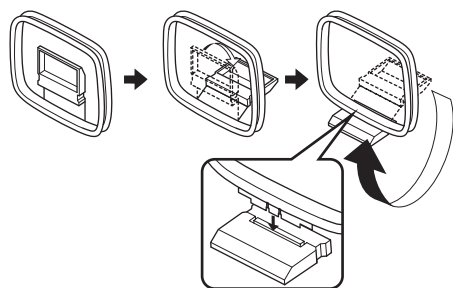

### 2 Press down the tab of the AM terminal.

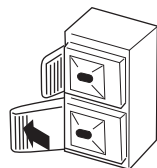

### 3 Insert the AM loop antenna lead wires into the AM terminal.

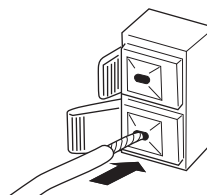

### 4 Replace the tab back to secure the wire.

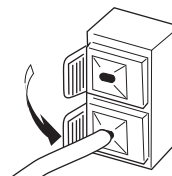

### 5 Repeat steps 2 to 4 to insert the AM loop antenna lead wires into the GND terminal.

### 6 Place the antenna away from the receiver and speaker cables.

While listening to the radio, rotate the antenna head to find the best angle for reception.

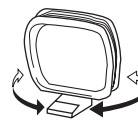

## Connecting the FM antenna

### 1 Connect the supplied indoor FM antenna to the FM jack of the receiver.

### 2 Place the antenna away from the receiver and speaker cables.

## Note

Depending on the product, the shape of the tab is different from the described illust.



# Connecting External Components

You can connect various audio components, such as an MD player, a tape deck or a YAMAHA iPod universal dock to the receiver. Also you can connect an MD recorder or a CD recorder to the CD player using the DIGITAL OUT jacks. For information on your external component, refer to the owner's manual supplied with each component.

## Note

Do not connect the power cable of the receiver, CD player, or other components to the wall outlet until all cable connections are completed.

## Connecting an MD player or a tape deck

If you connect an MD player or a tape deck to the receiver, you can enjoy audio sources played on the component.

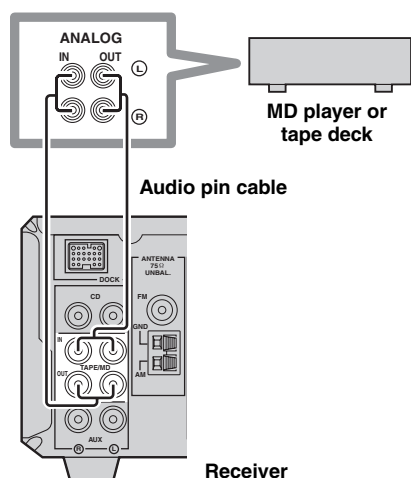

## Connecting an MD recorder or a CD recorder

If you connect an MD recorder or a CD recorder to the CD player with a digital connection, you can make a digital recording.

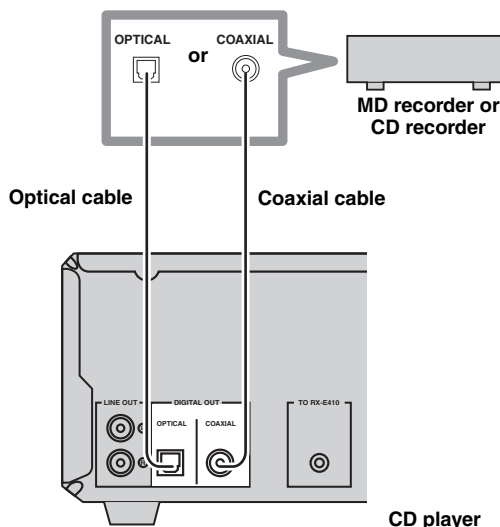

**1** Connect the TAPE/MD IN (L/R) jacks of the receiver to the analog output jacks of an MD player or a tape deck using a commercially available audio pin cable.

**2** To record audio output from the receiver, connect the TAPE/MD OUT (L/R) jacks of the receiver to the analog input jacks of an MD player or a tape deck using a commercially available audio pin cable.

Connect the DIGITAL OUT (COAXIAL or OPTICAL) jack of the CD player to the digital input (coaxial or optical) jack of an MD recorder or a CD recorder using a commercially available coaxial or optical cable.

## Notes

- The DIGITAL OUT jacks are compatible with PCM signals.
- The DIGITAL OUT (OPTICAL) jack is designed based on EIA standards. To make a digital connection, use an optical cable that meets EIA standards.

## Connecting a YAMAHA iPod universal dock

The receiver (RX-E410) is equipped with the DOCK terminal on the rear panel that allows you to connect a YAMAHA iPod universal dock (such as YDS-10 sold separately) where you can station your iPod and control playback of your iPod using the supplied remote control. Connect a YAMAHA iPod universal dock (such as YDS-10 sold separately) to the DOCK terminal on the rear of the receiver using its dedicated cables. Once the connection is complete, station your iPod in the YAMAHA iPod universal dock.

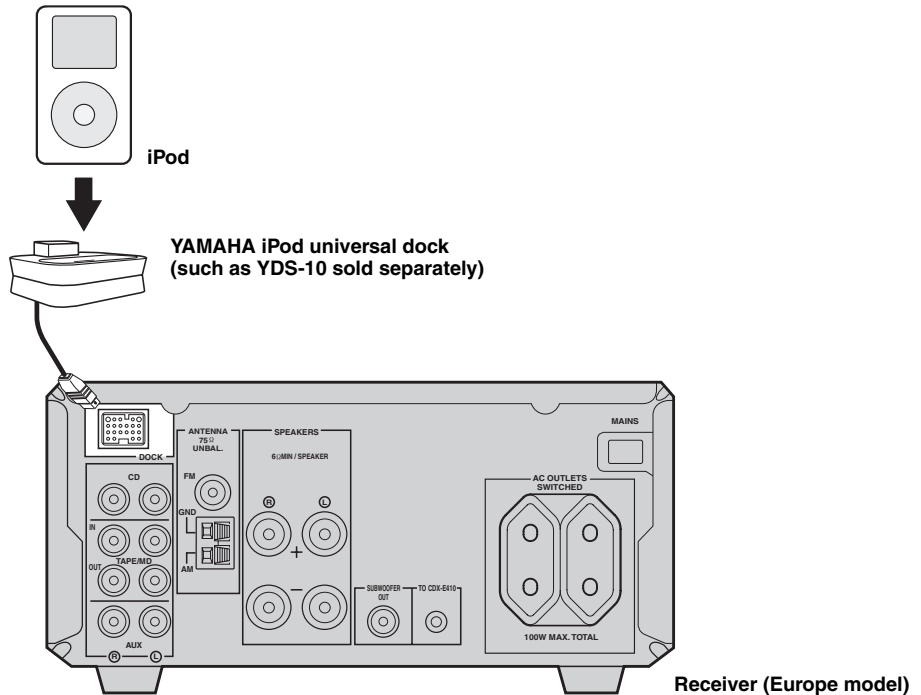

### Notes

- Do not connect the power cable of the receiver, CD player, or other components to the wall outlet until all cable connections are completed.
- Only iPod (Click and Wheel), iPod nano, and iPod mini are supported.
- You need a YAMAHA iPod universal dock (such as YDS-10 sold separately) and its dedicated cable compatible with the DOCK terminal of the receiver.
- Do not connect any iPod accessories (such as headphones, a wired remote control, or an FM transmitter) to your iPod when it is stationed in a YAMAHA iPod universal dock (such as YDS-10 sold separately).
- Unless your iPod is firmly stationed in a YAMAHA iPod universal dock (such as YDS-10 sold separately) connected to the DOCK terminal of the receiver, audio signals may not be output properly.
- Once the connection between your iPod and the receiver is complete and the receiver is set to DOCK mode (see page 8), “iPod connected” appears in the front panel display. If the connection between your iPod and the receiver fails, a status message appears in the front panel display. For a complete list of connection status message, see the iPod section in “Troubleshooting” on page 38.
- Your iPod battery is automatically charged when your iPod is stationed in a YAMAHA iPod universal dock (such as YDS-10 sold separately) connected to the DOCK terminal of the receiver as long as the receiver is turned on.
- Depending on the type of the iPod, you may need to insert one of the iPod adapters supplied with a YAMAHA iPod universal dock (such as YDS-10 sold separately) into the dock slot before you station your iPod.

# Connecting the Power Cables

Once all connections are complete, connect the power cable of the CD player to the AC OUTLET(S) terminal on the rear of the receiver (or the AC wall outlet if the AC OUTLET(S) terminal is not available), and then plug the power cable of the receiver into the AC wall outlet.

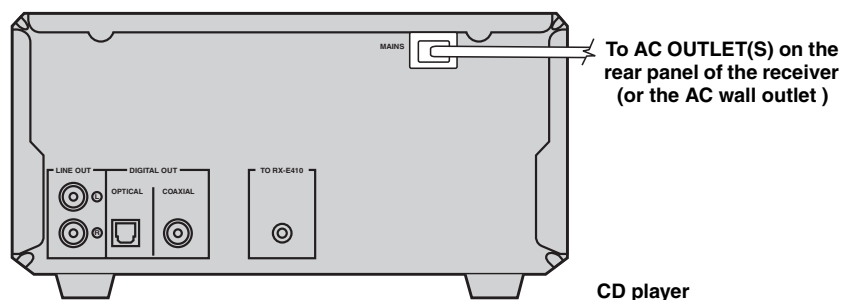
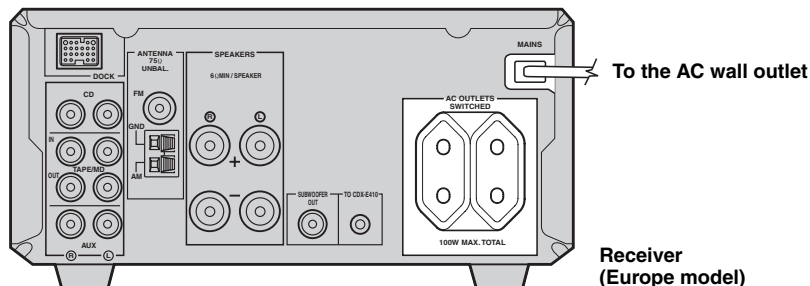

PREPARATION

## ■ AC OUTLET(S) (SWITCHED)

- U.K. model..... 1 outlet
- Other models..... 2 outlets

Use these outlet(s) to supply power to the CD player or any connected components. Connect the power cable of your other components to these outlet(s). Power to these outlet(s) is supplied when the receiver is turned on. For information on the maximum power or the total power consumption of the components that can be connected to these outlet(s), see “Specifications” on page 44.

English

# Adjusting the Clock

Before starting playback operation, follow the procedure below to adjust the clock setting of the receiver.

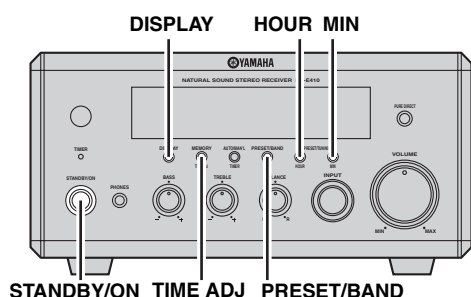

- 1 Press STANDBY/ON on the front panel of the receiver to turn on it.**

The front panel display lights up.

- 2 Press DISPLAY.**

“Clock Time” appears in the front panel display for a few seconds, and then “Set Clock” appears.



- 3 Press TIME ADJ for about two seconds to enter the clock setting mode.**



- 4 To set the hour setting ahead, press HOUR repeatedly. To set the hour setting backward, press HOUR repeatedly while holding down PRESET/BAND.**

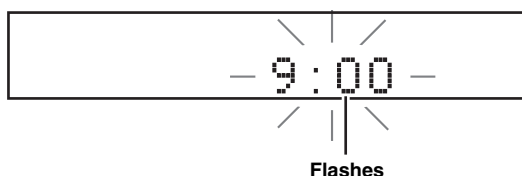

- 5 To set the minute setting ahead, press MIN repeatedly. To set the minute setting backward, press MIN repeatedly while holding down PRESET/BAND.**

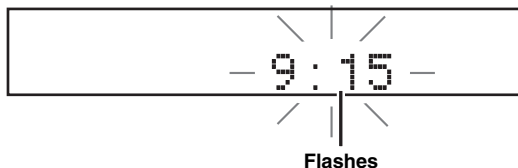

- 6 Press TIME ADJ once again to confirm the clock setting.**

“Adjusted” appears in the front panel display for a few seconds, and then the clock appears.



You can switch between 12-hour (AM/PM) format and 24-hour format by pressing HOUR or MIN while the clock is displayed in the front panel display.

# Basic Receiver Operations

Follow the procedure below to select an input source and adjust the sound settings on the receiver.

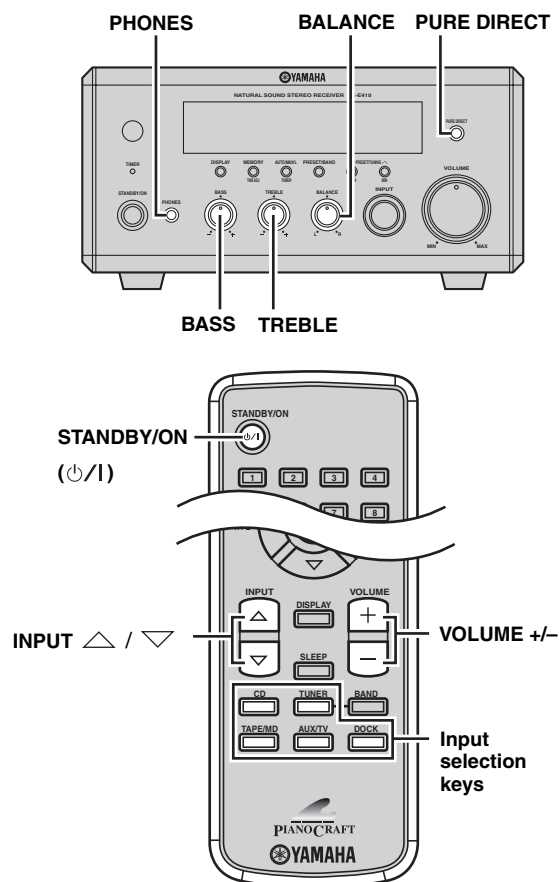

## 1 Press STANDBY/ON to turn on the receiver.

The CD player also turns on by the system control connection (see page 12). The front panel display lights up.



This system has the auto-standby function (see page 34) which automatically set to the system to the standby mode if you do not operate the system for 30 minutes while the receiver is set to the CD input mode.

## 2 Press one of the input selection keys or INPUT $\triangle$ / $\nabla$ to select the desired input source.

## 3 Start playback on the selected source component or select a broadcast station.

For information on the disc playback, see page 21, and for information on tuning, see page 26.

## 4 Press VOLUME +/- to adjust the volume to the desired output level.

## 5 Rotate BASS, TREBLE, or BALANCE on the front panel of the receiver to adjust the following settings.

**BASS:** Adjusts the low frequency response.

**TREBLE:** Adjusts the high frequency response.

**BALANCE:** Adjusts the volume level of each left and right speaker channel.

### ■ Pure Direct mode

The Pure Direct mode shuts down the tone control circuitry, allowing you to enjoy pure high-fidelity sounds from analog sources.

### Press PURE DIRECT on the front panel of the receiver to turn on the Pure Direct mode.

PURE DIRECT lights up, and the front panel display automatically dims.

### Notes

- While the Pure Direct mode is turned on, neither BASS, TREBLE, nor BALANCE are available.
- If you carry out any operation while the Pure Direct mode is turned on, the front panel display lights up briefly to acknowledge the command and dims again.

### To turn off the Pure Direct mode

Press PURE DIRECT again so that PURE DIRECT turns off and the front panel display lights up.

### ■ To use headphones

Connect the headphones to the PHONES jack. You can listen to the sound to be output from the speakers through the headphones.

## Changing the front panel display settings

Follow the procedure below to change the settings of the receiver's front panel display.

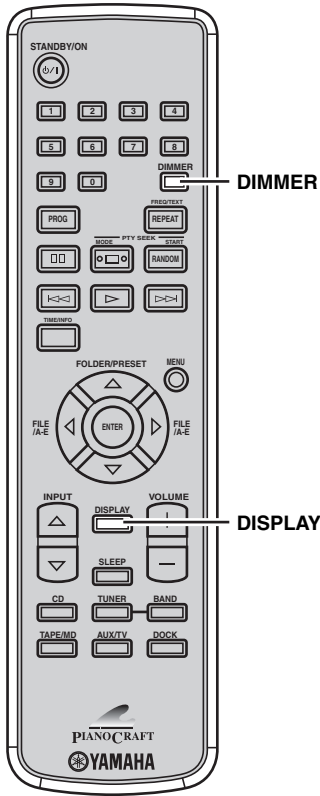

### ■ To switch the display mode

You can switch the information displayed in the receiver's front panel display between the current input and clock.

#### Note

You cannot display the clock unless you adjust it (see page 18).

**Press DISPLAY repeatedly to select the desired display mode.**

Each time you press the key, the display changes as follows.

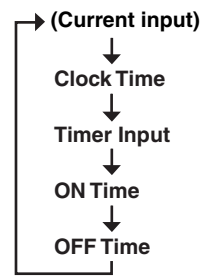

"Timer Input", "ON Time", and "OFF Time" are used to set the clock timer (see page 32).

### ■ To dim the display

You can dim the front panel display of the receiver. The front panel display of the CD player also dims by the system control connection (see page 12). (The default setting is "DIMMER OFF".)

**Press DIMMER to select "DIMMER ON".**

### To return to normal brightness

Press DIMMER to select "DIMMER OFF".

# Basic Disc Playback Operations

You can enjoy playback of audio CDs, MP3 CDs, and WMA CDs with the CD player. However, depending on a disc format, some discs may not be compatible with the CD player. Before loading a disc into the CD player, be sure to check the disc compatibility of the CD player (see page 42).

## Note

Depending on the disc, some operations may be different or restricted.

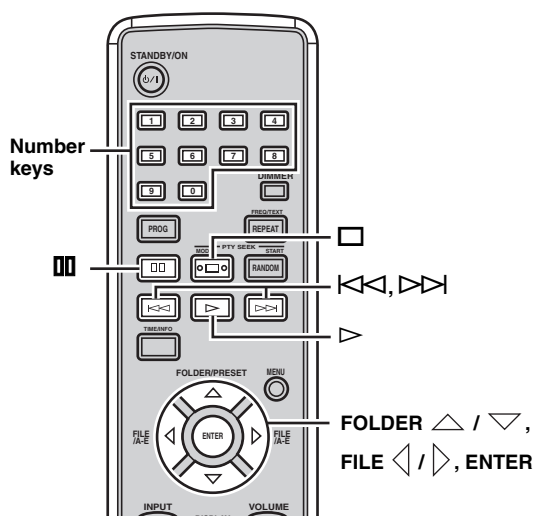

## To start playback

Press  $\triangleright$  while a disc is loaded.



When you open the disc tray by pressing  $\triangle$  on the front panel of the CD player, you can also close the disc tray by pressing  $\triangleright$ , a numeric key, or RANDOM other than  $\triangle$ . In this case, disc playback starts automatically after the disc tray is closed.

## To stop playback

Press  $\square$ .

## To pause playback

Press  $\square$ .

To return to normal playback, press  $\triangleright$ .

## To fast reverse or fast forward

To fast reverse, hold down  $\lll$ .

To fast forward, hold down  $\ggg$ .

## To skip tracks

To skip to the start of the current track, press  $\lll$ .

To skip to the next track, press  $\ggg$ .

To skip to the previous track, quickly press  $\lll$  twice.

## To specify a track for playback

Use the number keys to enter the track number you want to play.

Example: To select the track number 8, press 8, and then wait a few seconds so that 8 is confirmed, or press 0, and then 8.

## Note

The track number for an MP3, or WMA disc is recognized per a disc, not per folder. The number assigned to each track corresponds to sequence of a disc.

## To select a folder/file for an MP3 or WMA disc

To select a folder, press FOLDER  $\triangle$  /  $\nabla$ .

To select a file, press FILE  $\triangleleft$  /  $\triangleright$ .

To start playback of the selected folder/file, press ENTER.

## About MP3 and WMA discs

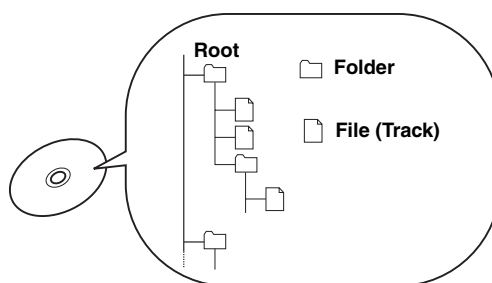

You can play back MP3 and WMA format files recorded on a CD-R/RW with similar uses as a music CD. The CD player regards files in the disc as tracks (as shown above).

## Note

Depending on recording conditions such as recording software settings, the CD player may not be able to play the disc at all, or may not play tracks in the order they were recorded. For information on disc compatibility of the CD player, see page 42.

## Switching the playback information display

You can switch the disc playback information shown in the CD player's front panel display. Available information differs depending on a disc type.

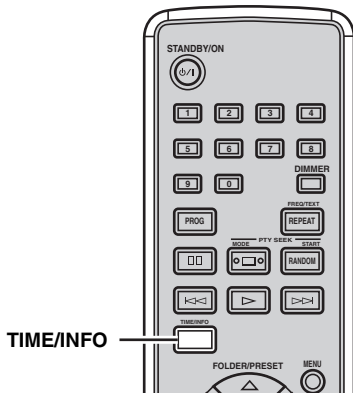

**Press TIME/INFO repeatedly while playing back a disc.**

Each time you press the key, the information display changes as described in "Playback information for audio CDs" and "Playback information for MP3 and WMA discs".

### Notes

- Some information may not be available depending on a disc.
- Some special characters may not be shown properly.

### ■ Playback information for audio CDs

The following information is available during playback of an audio CD. "Disc title", "Artist name", and "Track name" are available only for a CD TEXT disc.

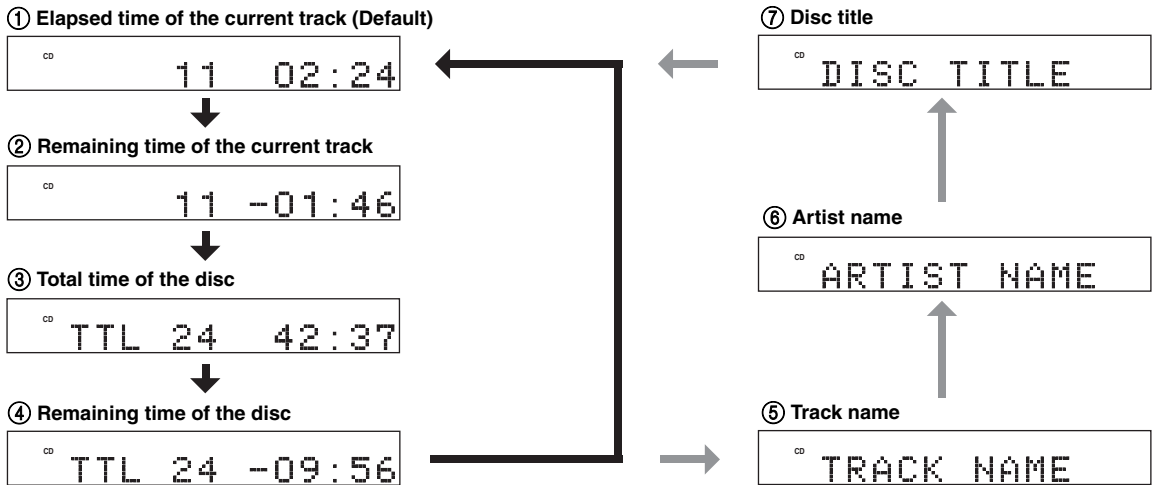



## ■ Playback information for MP3 and WMA discs

The following information is available during playback of an MP3 or WMA disc.

### ① Scrolling display (Default)

MP3  
SONG TITLE

### ② Elapsed time of the current file

MP3  
12 02:31

### ③ Remaining time of the current file

MP3  
12 -01:27

### ④ File name

MP3  
FILE NAME

### ⑤ Song title

MP3  
SONG TITLE

### ⑨ Comment

MP3  
COMMENT

### ⑧ Year

MP3  
YEAR

### ⑦ Album name

MP3  
ALBUM NAME

### ⑥ Artist name

MP3  
ARTIST NAME



Scrolling display shows the song title, artist name, and album name of the selected item in sequence.

## Repeating playback (Repeat Play)

You can repeat the playback of the selected item in a disc.

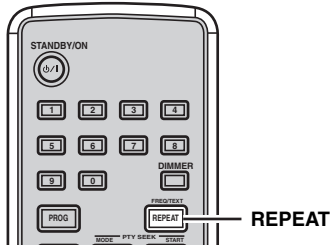

**1** Play back the disc or track you want to repeat.

**2** Press REPEAT to select the desired Repeat Play mode.

Each time you press the key, the Repeat Play mode indicator in the CD player's front panel display changes as follows.

### Audio CD

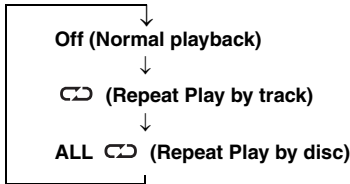

### MP3/WMA disc

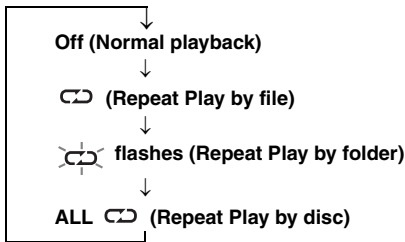

### To cancel Repeat Play

Press REPEAT repeatedly so that the Repeat Play mode indicator disappears from the front panel display.

## Playing back randomly (Random Play)

You can play back tracks in the disc in random order.

### Note

When playing back an audio CD with Random Play, the remaining time of the disc cannot be displayed.

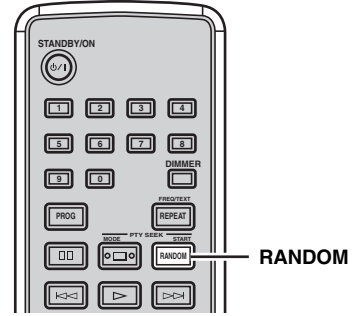

**While the disc is loaded into the CD player, press RANDOM.**

The RANDOM indicator lights up in the CD player's front panel display and Random Play starts.

### To cancel Random Play

Press RANDOM so that the RANDOM indicator disappears from the front panel display.

## Customizing playback order (Program Play)

You can customize the playback order for 40 tracks stored in the disc.

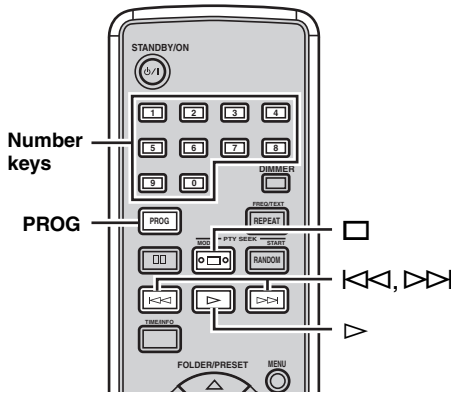

### 1 While the disc is loaded into the CD player, press PROG.

The PROG indicator lights up and the program display appears in the CD player's front panel display.

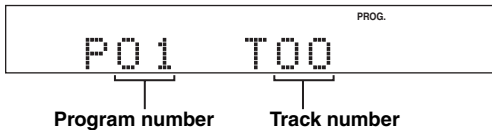

### 2 Use the number keys to enter the track number you want to program.

Example: To select the track number 8, press 8, and then wait a few seconds so that 8 is confirmed, or press 0, and then 8.

The front panel display shows the total number and total time of the programmed tracks for a few seconds, and then returns to the program display.

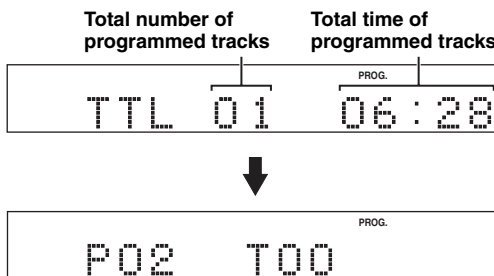

In case of MP3 or WMA disc



#### Note

The total number of programmed tracks and the total time of programmed tracks are not displayed for MP3 or WMA disc.



The track number for an MP3 or WMA disc is recognized per disc, not per folder. The number assigned to each track corresponds to sequence of a disc.

### 3 Repeat step 2 until you program all desired tracks.

### 4 To finish programming tracks, press PROG.

The program display disappears and the playback information of the first programmed track appears in the front panel display.

### 5 To start Program Play, press ▷.

#### ■ To clear the program order

While the playback is stopped, press ◻.

#### Note

If you open the disc tray or set the CD player to the standby mode, the programmed order is automatically cleared.

#### ■ To check or correct the programmed tracks

### 1 While the playback is stopped, press PROG.

The program display appears in the CD player's front panel display.

### 2 Press ◀◀ or ▶▶ to check the program order.

### 3 To replace a programmed track with new one, display the program number to be corrected in step 2, and then use the number keys to enter the track number to be programmed.

### 4 To finish checking or correcting the programmed tracks, press PROG.

# FM/AM Tuning

There are 2 tuning methods: automatic and manual. Automatic tuning is effective when station signals are strong and there is no interference. If the signal from the station you want to select is weak, tune into it manually. You can also use the automatic and manual preset tuning features to store up to 40 stations (A1 to E8: 8 preset station numbers in each of the 5 preset station groups).

## Automatic tuning

Automatic tuning is effective when station signals are strong and there is no interference.

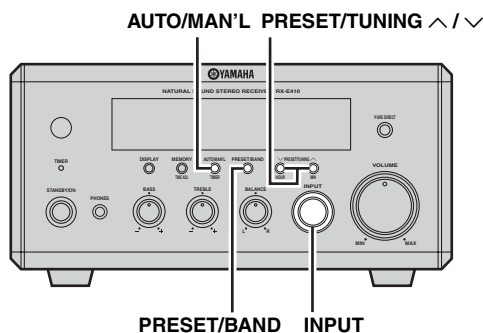

**1** Rotate **INPUT** on the front panel of the receiver to select “TUNER” as an input source.

**2** Press **PRESET/BAND** repeatedly to select “FM” or “AM”.



When the preset indicator lights up, the receiver is in the preset mode. For details, see pages 27 and 28.

**3** Press **AUTO/MAN'L** so that the **AUTO** indicator lights up in the front panel display.

**4** Press **PRESET/TUNING ^ / v** to begin automatic tuning.

When the receiver is tuned into a station, the **TUNED** indicator lights up and the frequency of the received station is shown in the front panel display.

- Press **^** to tune into a higher frequency.
- Press **v** to tune into a lower frequency.

## Manual tuning

If the signal received from the station you want to select is weak, tune into it manually.

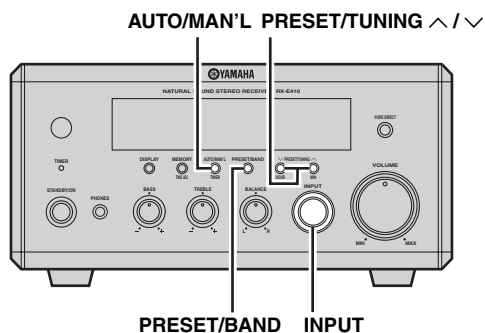

**1** Rotate **INPUT** on the front panel of the receiver to select “TUNER” as an input source.

**2** Press **PRESET/BAND** to select “FM” or “AM”.



When the preset indicator lights up, the receiver is in the preset mode. For details, see pages 27 and 28.

**3** Press **AUTO/MAN'L** so that the **AUTO** indicator disappears from the front panel display.

**4** Press **PRESET/TUNING ^ / v** to tune into the desired station manually.

Hold down the button to continue searching.

## Automatic preset tuning

Follow the procedure below to preset radio stations automatically.

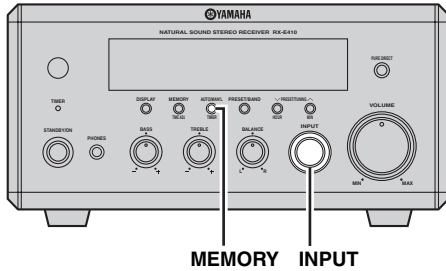

**1** Rotate **INPUT** on the front panel of the receiver to select “TUNER” as an input source.

**2** Hold down **MEMORY** for more than two seconds.

The AUTO and MEMORY indicator flash in the front panel display.

- Auto Preset starts at the lowest frequency toward the highest frequency.
- The receiver automatically applies a preset number to each detected station.

### Note

You can preset up to 40 of AM and FM stations with Auto Preset.

## Manual preset tuning

You can also store up to 40 stations (A1 to E8: 8 preset station numbers in each of the 5 preset station groups) manually.

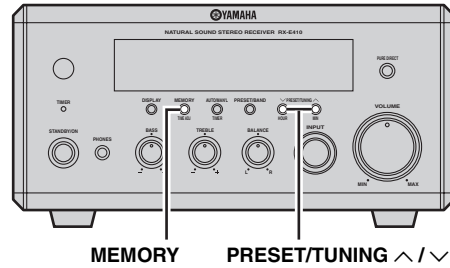

**1** Tune into a radio station you want to preset.  
See page 26 for tuning instructions.

**2** Press **MEMORY**.

The MEMORY indicator flashes in the front panel display for about 5 seconds.

**3** Hold down **PRESET/TUNING ^ / v** to select a preset station group (A to E) while the MEMORY indicator is flashing.

**4** Press **PRESET/TUNING ^ / v** repeatedly to select a preset station number (1 to 8) while the MEMORY indicator is flashing.

**5** Press **MEMORY** while the MEMORY indicator is flashing.

The PRESET and MEMORY indicators light up in the front panel display.

**6** Repeat steps 1 to 5 until all desired stations are preset.

## Selecting preset stations

You can tune into any desired station simply by selecting the preset station group and number under which it was stored (see page 27).

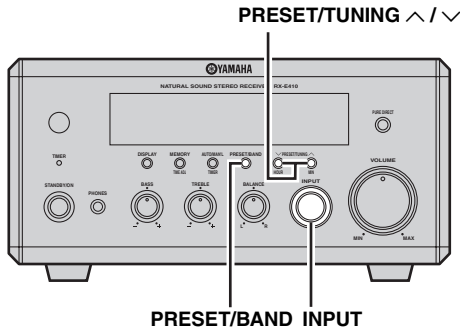

- 1** Rotate **INPUT** on the front panel of the receiver to select **"TUNER"** as an input source.
- 2** Press **PRESET/BAND** repeatedly so that the preset indicator lights up in the front panel display.
- 3** Hold down **PRESET/TUNING ^ / v** to select a preset station group (**A to E**), and then press **PRESET/TUNING ^ / v** repeatedly to select a preset station number (**1 to 8**).



You can also use the remote control to select preset stations. While the receiver is set to the **TUNER** mode (see page 8), press **BAND** repeatedly to select **"PRESET"**. To select a preset station group (**A to E**), press **A-E**  $\triangleleft / \triangleright$  repeatedly. To select a preset station number (**1 to 8**), press **PRESET**  $\triangle / \nabla$  repeatedly or use the number keys (**1 to 8**).

# Radio Data System Tuning (U.K. and Europe Models Only)

Radio Data System (U.K. and Europe models only) is a data transmission system used by FM stations in many countries. The Radio Data System function is carried out among the network stations. This unit can receive various Radio Data System data such as PS (program service), PTY (program type), RT (radio text), CT (clock time), and EON (enhanced other networks) when receiving Radio Data System broadcasting stations.

## Selecting the Radio Data System program

Use this feature to select one of the 15 Radio Data System program types and search for all the available preset stations of the selected program type.

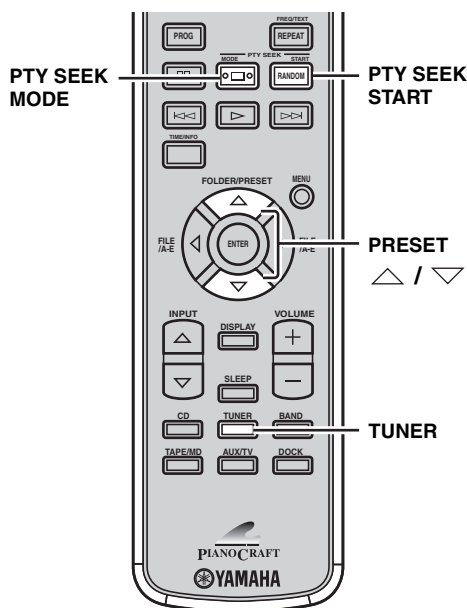

**1 Set the receiver to the “FM” tuning mode.**  
See page 26 for tuning instructions.

**2 Press PTY SEEK MODE to set the receiver to the PTY SEEK mode.**

The PTY indicator and the name of the program type flash in the front panel display of the receiver.



- To cancel the PTY SEEK mode, press PTY SEEK MODE once again.
- The PTY SEEK mode is automatically cancelled if you do not operate any key for about 20 seconds.

**3 Press PRESET  $\triangle$  /  $\nabla$  repeatedly to select the desired program type.**

The name of the selected program type appears in the front panel display.

Program type	Descriptions
NEWS	News
AFFAIRS	Current affairs
INFO	General information
SPORT	Sports
EDUCATE	Education
DRAMA	Drama
CULTURE	Culture
SCIENCE	Science
VARIED	Light entertainment
POP M	Popular music
ROCK M	Rock music
M.O.R. M	Middle-of-the-road music (easy-listening)
LIGHT M	Light classics
CLASSICS	Serious classics
OTHER M	Other music

**4 Press PTY SEEK START to start searching for available Radio Data System preset stations.**

If a station broadcasting the selected program type is found, the receiver stops searching, and then program service name and the PTY HOLD indicator lights up in the front panel display.

If there is no station broadcasting the selected program type, the frequency currently selected appears.



To stop searching for stations, press PTY SEEK START once again.

**5 Repeat step 4 until the desired station is found.**

**Displaying the Radio Data System information**

Use this feature to display the 4 types of the Radio Data System information: PS (program service), PTY (program type), RT (radio text) and CT (clock time). The corresponding indicators light up in the front panel display.

**Notes**

- You can select one of the Radio Data System modes only when the corresponding Radio Data System indicator lights up in the front panel display. It may take a while for the receiver to receive all of the Radio Data System data from the station.
- You can select only the available Radio Data System modes being offered by the station.
- If the signals being received are not strong enough, the receiver may not be able to utilize the Radio Data System data. In particular, the “RT” mode requires a large amount of data and may not be available even when the other Radio Data System modes are available.
- In case of poor reception conditions, press AUTO/MAN’L on the front panel of the receiver so that the AUTO indicator disappears from the front panel display.
- If the signal strength is weakened by external interference while the receiver is receiving the Radio Data System data, the reception may be cut off unexpectedly and “...WAIT” appears in the front panel display.
- When the “RT” mode is selected, the receiver can display the program information by a maximum of 64 alphanumeric characters, including the umlaut symbol. Unavailable characters are displayed with the “\_” (underscore).

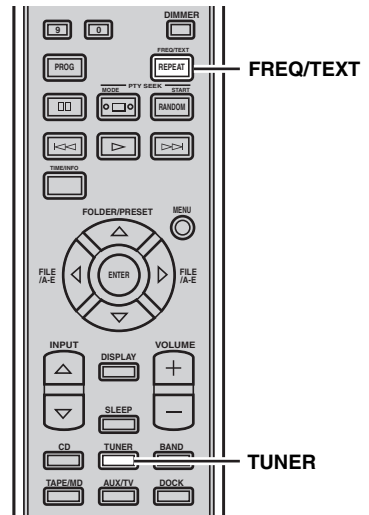

While tuning into a Radio Data System station, press FREQ/TEXT repeatedly to select the desired Radio Data System display mode.

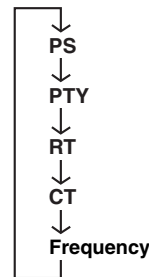

- Select “PS” to display the name of the Radio Data System program currently being received.
- Select “PTY” to display the type of the Radio Data System program currently being received.
- Select “RT” to display the information on the Radio Data System program currently being received.
- Select “CT” to display the current time.



## ■ Additional CT (clock time) settings

You can use CT information received from the Radio Data System stations to adjust the built-in clock of the receiver.

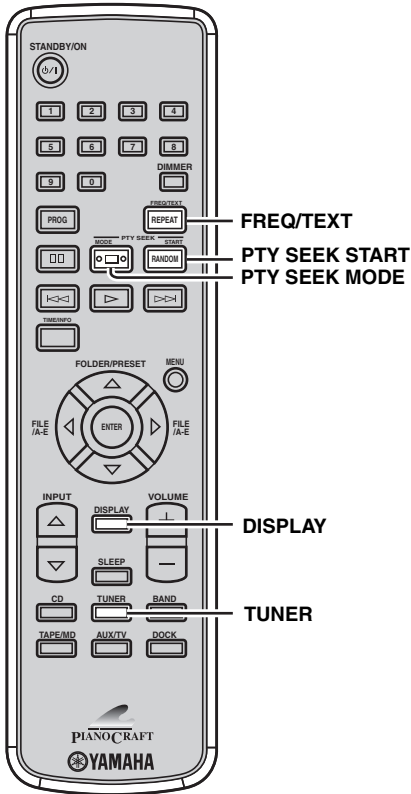

- Press **PTY SEEK MODE** repeatedly to select “CT→Clock” or “Local CT”, and then press **PTY SEEK START** to switch the setting between “ON” and “OFF”.

### CT→Clock

Set this to “ON” if you want to apply CT information received from the Radio Data System stations to the built-in clock of the receiver. (The default setting is “ON”.)

### Local CT

Set this to “ON” if you want to apply the daylight saving time or summer time to CT information received from the Radio Data System stations. (The default setting is “ON”.)

- Press **FREQ/TEXT** to confirm the settings.

- While tuning into a Radio Data System station, press **DISPLAY** repeatedly so that the clock appears in the front panel display of the receiver.

- Press **FREQ/TEXT** once.  
“CT→Clock” appears in the front panel display.

# Setting the Timer

The receiver is equipped with 2 types of timer functions: clock timer and sleep timer. The clock timer automatically turns the receiver on or sets it to the standby mode at the specified time. The sleep timer sets the receiver to the standby mode after the specified time elapses. The CD player also turns on or sets to the standby mode automatically by the system control connection (see page 12).

## Setting the clock timer

The clock timer automatically turns the receiver on or sets it to the standby mode at the specified time. You can also specify an input which the receiver automatically selects when the clock timer turns it on.

### Notes

- You cannot set the clock timer unless you adjust the clock (see page 18).
- If you do not touch any key for more than 30 seconds after the previous key operation, the operations you made are cleared from the memory and the normal display reappears.

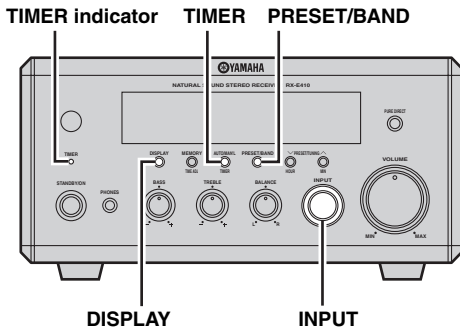

- 1 Press DISPLAY on the front panel of the receiver repeatedly to select “Timer Input”.**

The TIMER indicator flashes in the front panel display.

- 2 Rotate INPUT to select an input which the receiver automatically selects when the clock timer turns it on.**

If you select “TUNER”, you can select a band by pressing PRESET/BAND. To select a preset station, carry out steps 2 and 3 in the “Selecting preset stations” procedure (see page 28).

- 3 Press DISPLAY again to select “ON Time”.**

- 4 Specify the time when you want to turn on the receiver.**

Carry out the steps 4 and 5 in “Adjusting the Clock” (see page 18) to adjust the hour and minute settings.

- 5 Press DISPLAY again to select “OFF Time”, and then specify the time when you want to turn off the receiver as well as step 4.**

- 6 To turn off the receiver now with the clock timer set, press TIMER.**

The TIMER indicator lights up. The receiver will be turned on or set to the standby mode automatically at the specified time.



If you want to turn off the receiver by “OFF Time”, press DISPLAY repeatedly to display the clock in the front panel display, and then press TIMER. The TIMER indicator lights up in the front panel display.

### To set or cancel the clock timer

Press TIMER on the front panel while the clock is displayed or the receiver is in the standby mode.

## Setting the sleep timer

The sleep timer sets the receiver to the standby mode after the specified time elapses.

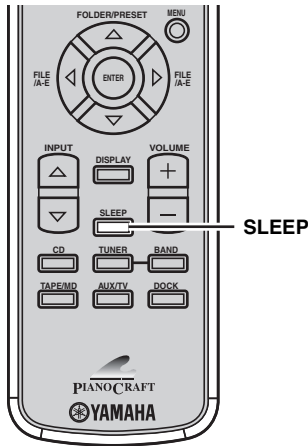

**Press SLEEP repeatedly to select the desired duration.**

Each time you press the key, the duration changes as follows.

The SLEEP indicator lights up in the front panel display.

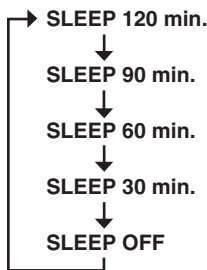

- The sleep timer is canceled if you set the receiver to the standby mode.
- If you press SLEEP once while the sleep timer is set, the ongoing duration appears in the front panel display.

### To cancel the sleep timer

Press SLEEP repeatedly to select "SLEEP OFF".

## Setting the auto-standby mode

You can turn on/off the auto-standby feature which automatically set the system to the standby mode if you do not operate the system for 30 minutes while the receiver is set to the CD input mode. (The default setting is “AUTO STANDBY ON”.)

### Notes

- Unless you connect the receiver and the CD player with the supplied system control cable properly (see page 12), this feature does not function for the system.
- This feature does not function for the system during playback.

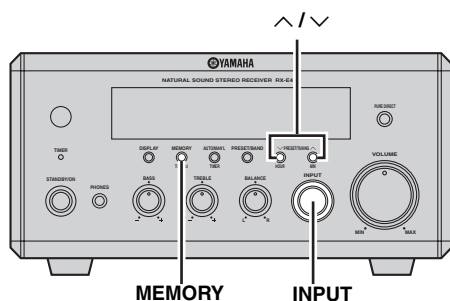

- 1 Rotate INPUT on the front panel of the receiver to select “CD” as an input source.**
- 2 Press MEMORY.**

The current setting appears in the receiver’s front panel display for about five seconds.
- 3 While the current setting is displayed in the front panel display, press  $\wedge$  or  $\vee$  to switch between “AUTO STANDBY ON” or “AUTO STANDBY OFF”.**
- 4 Press MEMORY or wait for five seconds without any operation to confirm the setting.**

# Controlling iPod

In addition to controlling the receiver (RX-E410) and CD player (CDX-E410), you can operate your iPod stationed in a YAMAHA iPod universal dock connected to the receiver using the supplied remote control.

## Available iPod operations

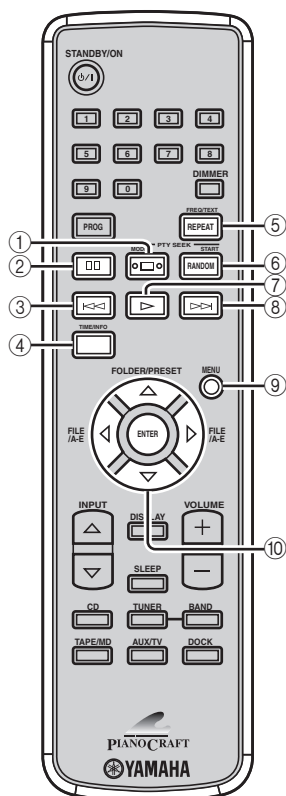

### Operations available in DOCK mode

The following operations are available for the iPod connected with a YAMAHA iPod universal dock (such as YDS-10 sold separately). For details on iPod operations, see “Using iPod” on page 36.



Press DOCK to set the receiver to the DOCK mode before carrying out the following operations.



Stops playback.



Pauses playback.



Skips to the previous track. Press and hold to fast reverse.



Switches between the simple remote mode and menu browse mode.



Selects the repeat playback mode during playback in the menu browse mode.



Selects the shuffle playback mode during playback in the menu browse mode.



Starts playback.



Skips to the next track. Press and hold to fast forward.



Returns to the upper level in the iPod menu.



Press ◀ to return to the upper level in the iPod menu.  
Press ▲ or ▼ to select an item in the selected group.  
Press ▶ or ENTER to enter the selected group. (Pressing ENTER starts playback when a song is selected.)

## Using iPod

Once you have stationed your iPod in a YAMAHA iPod universal dock (such as YDS-10 sold separately) connected to the DOCK terminal of the receiver (see page 16), you can enjoy playback of your iPod using the supplied remote control. The operations of your iPod are available with the aid of the receiver's front panel display (menu browse mode) or without it (simple remote mode).

### Notes

- Only iPod (Click and Wheel), iPod nano, and iPod mini are supported.
- Some features may not be compatible depending on the model or the software version of your iPod.



- For a complete list of the remote control functions used to control your iPod, refer to “Available iPod operations” (see page 35).
- For a complete list of status messages that appear in the front panel display, refer to the “iPod” section in “Troubleshooting” (see page 40).

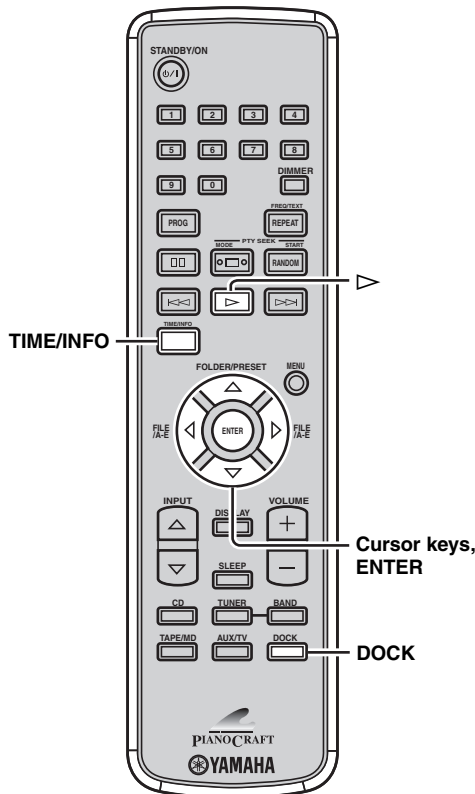

**1 Press DOCK to select the iPod as the input source.**

**2 Press TIME/INFO to switch between the simple remote mode and menu browse mode.**

#### Simple remote mode

- View the screen of the iPod to control the menu.
- Operate the iPod using the iPod controls or the supplied remote control.

#### Menu browse mode

- View the front panel of the receiver to control the menu.
- Operate the iPod using the supplied remote control.
- You can configure the “Setup” parameters of the iPod.

**3 Use the cursor keys to operate the iPod menu, and then press ENTER to start playback of the selected song (or group).**

For details on how to operate the iPod menu with the menu browse mode, refer to “Menu browse mode” (see page 37).



In the simple remote mode, you can also use the iPod controllers to operate the menu.

## ■ Menu browse mode

In the menu browse mode, you can operate the iPod menu using the receiver's front panel display. Also you can configure the "Setup" parameters with the menu browse mode.

### Note

There are some characters that cannot be displayed in the front panel display of the receiver. Those characters are replaced with underscore "\_".

### iPod menu



## 1 Select the menu browse mode (see page 36).

The top of the iPod menu appears in the front panel display.

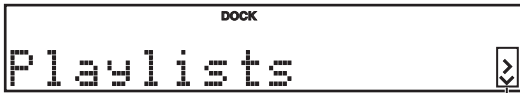

iPod operation indicators



The iPod operation indicators (see page 5) show the operable cursor keys in each step.

## 2 Press $\triangle$ or $\nabla$ to select the menu, and then press $\triangleright$ or ENTER to enter the selected menu.

The name of the first item stored in the selected menu appears.

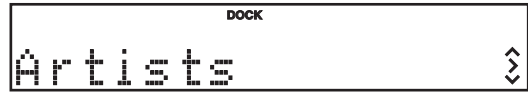

- The iPod menu indicators (see page 5) show the iPod menu currently selected.
- To return to the upper level in the iPod menu, press  $\triangleleft$  or MENU.

## 3 Repeat step 2 until you select the desired item, and then press $\triangleright$ to start playback of the desired item (group or song).

If you select "Setup" in step 2, press  $\triangle$  or  $\nabla$  to select the desired setup menu, and then press ENTER repeatedly to configure the parameter.

### Setup menu

**Shuffle:** Off, **Songs** (Shuffle Play by song), **Albums** (Shuffle Play by album)

**Repeat:** Off, **One** (Repeat Play by song), **ALL** (Repeat Play by selected group)

**FL Scroll:** **Cont** (Scrolls the song name continuously, default setting), **Once** (Scrolls the song name once)



While playing back a track (or group) with the menu browse mode, you can switch the playback information (such as song name, elapsed time, artist name, or album name) displayed in the front panel display by pressing  $\triangle$  or  $\nabla$ .

# Troubleshooting

Refer to the table below when this unit does not function properly. If the problem you are experiencing is not listed below or if the instruction below does not help, turn off this unit, disconnect the power cable, and contact the nearest authorized YAMAHA dealer or service center.

## Receiver (RX-E410)

### ■ General

Problem	Cause	Remedy	See page
<b>The receiver fails to turn on or enters the standby mode soon after the power is turned on.</b>	The power cable is not connected or the plug is not completely inserted.	Connect the power cable firmly.	17
	The receiver has been exposed to a strong external electric shock (such as lightning or strong static electricity).	Set the receiver to the standby mode, disconnect the power cable, plug it back in after 30 seconds and then use it normally.	—
<b>No sound</b>	Incorrect input or output cable connections.	Connect the cables properly. If the problem persists, the cables may be defective.	12
	No appropriate input source has been selected.	Select an appropriate input source with the INPUT selector on the front panel (or the input selection keys on the remote control).	—
	Speaker connections are not secure.	Secure the connections.	13
	The volume is turned down.	Turn up the volume.	—
	Signals the receiver cannot reproduce are being input from a source component, such as a CD-ROM.	Play a source whose signals can be reproduced by the receiver.	—
<b>The sound suddenly goes off.</b>	The timer has turned off the receiver.	Turn on the receiver, and play the source again.	—
<b>Sound is heard from the speaker on one side only.</b>	Incorrect cable connections.	Connect the cables properly. If the problem persists, the cables may be defective.	13
<b>There is noise interference from digital or radio frequency equipment.</b>	The receiver is too close to the digital or high-frequency equipment.	Move the receiver further away from such equipment.	—



■ Tuner

	Problem	Cause	Remedy	See page
FM	<b>FM stereo reception is noisy.</b>	The characteristics of FM stereo broadcasts may cause this problem when the transmitter is too far away or the antenna input is poor.	Check the antenna connections.	14
			Try using a high-quality directional FM antenna.	—
			Use the manual tuning method.	26
	<b>There is distortion, and clear reception cannot be obtained even with a good FM antenna.</b>	There is multi-path interference.	Adjust the antenna position to eliminate multi-path interference.	—
	<b>The desired station cannot be tuned into with the automatic tuning method.</b>	The signal is too weak.	Use a high-quality directional FM antenna.	—
			Use the manual tuning method.	26
	<b>Previously preset stations can no longer be tuned into.</b>	The receiver has been disconnected for a long period.	Set preset stations	27
AM	<b>The desired station cannot be tuned into with the automatic tuning method.</b>	The signal is weak or the antenna connections are loose.	Tighten the AM loop antenna connections and orient it for the best reception.	14
			Use the manual tuning method.	26
	<b>There are continuous crackling and hissing noises.</b>	Noises result from lightning, fluorescent lamps, motors, thermostats and other electrical equipment.	Use an outdoor antenna and a ground wire. This will help somewhat, but it is difficult to eliminate all noise.	—
	<b>There are buzzing and whining noises.</b>	A TV set is being used nearby.	Move the receiver away from the TV set.	—

■ iPod

**Note**

In case of a transmission error without a status message appearing in the front panel of the receiver, check the connection to your iPod (see page 16).

Status message	Cause	Remedy	See page
Loading...	<p>The receiver is in the middle of recognizing the connection with your iPod.</p> <hr/> <p>The receiver is in the middle of acquiring song lists from your iPod.</p>		
Connect error	There is a problem with the signal path from your iPod to the receiver.	<p>Turn off the receiver and reconnect the YAMAHA iPod universal dock to the DOCK terminal of the receiver.</p> <hr/> <p>Try resetting your iPod.</p>	<p>16</p> <hr/> <p>—</p>
Unknown type	The iPod being used is not supported by the receiver.	Only iPod (Click and Wheel), iPod nano, and iPod mini are supported.	—
iPod connected	Your iPod is properly stationed in a YAMAHA iPod universal dock (such as YDS-10 sold separately) connected to the DOCK terminal of the receiver, and the connection between your iPod and the receiver is complete.		
Disconnected	Your iPod was removed from a YAMAHA iPod universal dock (such as YDS-10 sold separately) connected to the DOCK terminal of the receiver.	Station your iPod back in a YAMAHA iPod universal dock (such as YDS-10 sold separately) connected to the DOCK terminal of the receiver.	16
Unable to play	The receiver cannot play back the songs currently stored on your iPod.	<p>Check that the songs currently stored on your iPod are playable.</p> <hr/> <p>Store some other playable music files on your iPod.</p>	<p>—</p> <hr/> <p>—</p>

## CD player (CDX-E410)

Problem	Cause	Remedy	See page
<b>Power turns on but immediately shuts off.</b>	The power cable is not connected or the plug is not completely inserted.	Connect the power cable firmly.	17
<b>Power immediately shuts off during playback.</b>	Auto-standby function of the receiver works when the receiver can not receive the playing signal transmitted from the CD player with the system control cable for 30 minutes.	Check the connection of the system control cable between the receiver and the CD player.	12
<b>No sound or distorted sound</b>	The sampling rate of a MP3 or WMA file may not be compatible with the CD player.	Check the sampling rate and bit rate of an MP3 or WMA file are compatible with the CD player.	42
<b>No audio at digital output</b>	Incorrect digital cable connections.	Connect the digital cables properly.	15
	The disc being played back may not be compatible with the CD player.	Check that the disc is compatible with the CD player.	42
<b>Disc playback does not start.</b>	You may use a CD-R/RW that is not finalized.	Finalize the CD-R/RW.	—
	The disc label may not be facing up.	Check that the disc label is facing up.	—
	The disc may be defective.	Try to play back another disc. If the same problem does not happen, the disc you want to play back is defective.	—
	MP3/WMA disc may not contain sufficient music tracks to be played back.	Check that your MP3/WMA disc contains at least 5 MP3/WMA music files.	—
	The sampling rate of a MP3 or WMA file may not be compatible with the CD player.	Check the sampling rate and bit rate of an MP3 or WMA file are compatible with the CD player.	42
<b>The CD player does not read CDs.</b>	The disc lens may be dirty.	Use a lens cleaner to clean the lens.	42

## Remote control

Problem	Cause	Remedy	See page
<b>The remote control does not work nor function properly.</b>	Wrong distance or angle.	The remote control functions within a maximum range of 6 m (20 ft) and no more than 30 degrees off-axis from the front panel.	11
	Direct sunlight or lighting (from an inverter type of fluorescent lamp, etc.) is striking the remote control sensor of this unit.	Reposition this system.	—
	The batteries are weak.	Replace all batteries.	11
	The system control cable is disconnected from the system connector jack of the receiver and/or the CD player.	Connect the receiver and the CD player with the system control cable firmly.	12

# Notes on Discs

## Disc information

The following tables explain the disc types supported by the CD player. Also, the CD player can play back 8-cm (3-inch) compact discs.



Disc logo marks are printed on the disc and the disc jacket.

### Note

Do not load any other type of disc into the CD player. Doing so may damage the CD player.

**The CD player can play the following data discs (For MP3 and WMA files, the parenthetic words represent the compatible sampling rate and bit rate):**

- MP3 files, recorded on CD-R/RW (fs 44.1, 48 kHz/ 32, 64, 96, 128, 160, 192, 256, or 320 kbps and variable bit encoded MP3 files (CBR and VBR))
- WMA files, recorded on CD-R/RW (When in fs 44.1 kHz: 192 kbps or less and variable bit encoded WMA files (CBR and VBR))
- ISO 9660 for CD-R/RW

### Notes

- CD-R/RW cannot be played unless finalized.
- Some discs cannot be played depending on disc characteristics or recording conditions.
- Do not use any non-standard shaped discs (heart-shaped, etc.).
- Do not use discs with tape, seals, or paste on their surface.
- Do not use discs with many scratches on their surface.
- Copyright-protected WMA files cannot be played back with the CD player.

## Handling a disc

- Do not touch the surface of the disc. Hold a disc by its edge and center hole.
- Do not leave a disc in the tray when you are not playing it.
- Do not write on the disc with a pencil or other marker.
- Do not stick tape, seals or other attachments to a disc, and do not bring into contact with glue.
- Do not use a protective cover to prevent scratches.
- Do not use a disc whose surface can be printed with a commercially available label printer.
- Do not put a disc in a place with direct sunlight, high temperature, high humidity or a lot of dust.

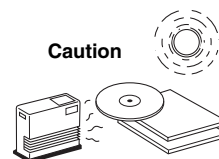
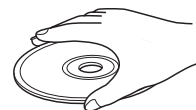

- If a disc becomes dirty, wipe it with a clean, dry cloth from the center out to the edge. Do not use record cleaner or paint thinner.
- To avoid malfunction, do not use a commercially available lens cleaner.

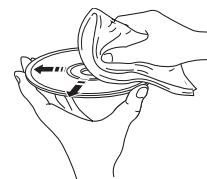

# Glossary

## Audio information

### ■ MP3 (MPEG Audio Layer-3)

One of the audio compression methods used by MPEG. It employs the irreversible compression method, which achieves a high compression rate by thinning out the data of hardly audible part to the human ears. It is said to be capable of compressing the data quantity by about 1/11 (128 kbps) while maintaining a similar audio quality to music CD.

### ■ PCM (Pulse Code Modulation)

A signal that is changed to digital format without compression. A CD is recorded with 16-bit sound at 44.1 kHz. This signal also has a type called Packed PCM (PPCM) that can be compressed without any loss of data.

### ■ Sampling frequency

The number of sampling (process for digitalizing analog signals) per second. In principle, the higher the sampling rate, the wider the frequency range that can be played back, and the higher the quantized bit rate, the finer the sound that can be reproduced.

### ■ Track

A CD can be divided into a number of segments (tracks). Each division is called a track number.

### ■ WMA (Windows Media Audio)

An audio compression method developed by Microsoft Corporation. It employs the irreversible compression method, which achieves a high compression rate by thinning out the data of hardly audible part to the human ears. It is said to be capable of compressing the data quantity by about 1/22 (64 kbps) while maintaining a similar audio quality to music CD.

## Copyright and logo marks

MPEG Layer-3 audio decoding technology licensed from Fraunhofer IIS and Thomson Multimedia.

### iPod®

“iPod” is a trademark of Apple Computer, Inc., registered in the U.S. and other countries.

# Specifications

## ■ RX-E410

### AMPLIFIER SECTION

- Minimum RMS output power per channel  
(6  $\Omega$  , 1 kHz, 0.1% THD)..... 55 W + 55 W
- Maximum RMS output power per channel  
(6  $\Omega$  , 1 kHz, 1% THD)..... 65 W + 65 W
- Input sensitivity/Impedance  
CD/TAPE/MD/AUX etc..... 150 mV/47 k $\Omega$
- Frequency Response  
CD etc. .... 20 Hz to 20 kHz  $\pm$  0.5 dB
- Total Harmonic Distortion (20 Hz to 20 kHz)  
CD etc. 20 W, 6  $\Omega$ .....0.04% or less
- Signal to Noise ratio (IHF-A network)  
CD etc. (150 mV, Input shorted) ..... 93 dB or more
- Output level/Impedance  
PHONES ..... 0.23 V/120  $\Omega$

### TUNER SECTION

#### FM Section

- Tuning Range ..... 87.50 to 108.00 MHz

#### AM Section

- Tuning Range ..... 531 to 1611 kHz
- Sensitivity  
FM (S/N 68 dB) ..... 6.0  $\mu$ V  
AM ..... 600  $\mu$ V/m

### GENERAL

- Power Supply ..... AC 230 V, 50 Hz
- Power consumption ..... 130 W
- AC Outlets  
U.K. model ..... 1 (Total 100 W max.)  
Europe model ..... 2 (Total 100 W max.)
- Standby Power consumption ..... 0.1 W
- Dimensions (W x H x D) ..... 215 x 108 x 363 mm
- Weight ..... 5.7 kg

## ■ CDX-E410

### PLAYBACK SYSTEM

- CD, CD-R/RW

### LASER

- Type ..... GaAlAs
- Wave length ..... 780 nm
- Emission Duration ..... continuous
- Laser Output ..... max. 44.6  $\mu$ W\*

\*This output is the value measured at a distance of about 200 mm from the objective lens surface on the Optical Pick-up Block.

### AUDIO PERFORMANCE

- Signal-Noise (1 kHz) ..... 105 dB or more
- Dynamic range (1 kHz) ..... 95 dB or more
- Distortion and Noise (1 kHz)..... 0.003 % or less

### GENERAL

- Power supply ..... AC 220-240 V, 50 Hz
- Power consumption ..... Approx. 13 W
- Dimensions (W x H x D) ..... 215 x 108 x 334 mm
- Weight ..... 2.8 kg

\*Specifications are subject to change without notice.

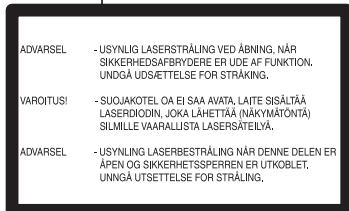
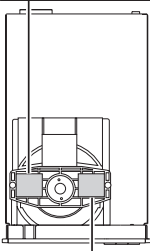
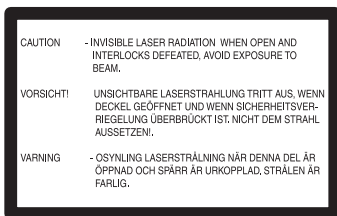
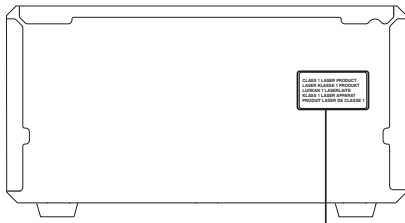

**CAUTION INVISIBLE LASER RADIATION WHEN OPEN AND INTERLOCKS DEFEATED. AVOID EXPOSURE TO BEAM.**



© 2006 YAMAHA CORPORATION All rights reserved.

**YAMAHA ELECTRONICS CORPORATION, USA** 6660 ORANGETHORPE AVE., BUENA PARK, CALIF. 90620, U.S.A.  
**YAMAHA CANADA MUSIC LTD.** 135 MILNER AVE., SCARBOROUGH, ONTARIO M1S 3R1, CANADA  
**YAMAHA ELECTRONIK EUROPA G.m.b.H.** SIEMENSSTR. 22-34, 25462 RELINGEN BEI HAMBURG, GERMANY  
**YAMAHA ELECTRONIQUE FRANCE S.A.** RUE AMBROISE CROIZAT BP70 CROISSY-BEAUBOURG 77312 MARNE-LA-VALLEE CEDEX02, FRANCE  
**YAMAHA ELECTRONICS (UK) LTD.** YAMAHA HOUSE, 200 RICKMANSWORTH ROAD WATFORD, HERTS WD18 7GQ, ENGLAND  
**YAMAHA SCANDINAVIA A.B.** J A WETTERGRENS GATA 1, BOX 30053, 400 43 VÄSTRA FRÖLUNDA, SWEDEN  
**YAMAHA MUSIC AUSTRALIA PTY, LTD.** 17-33 MARKET ST., SOUTH MELBOURNE, 3205 VIC., AUSTRALIA

**YAMAHA CORPORATION**  
Printed in China ◀ WH45490