

Remote control functions

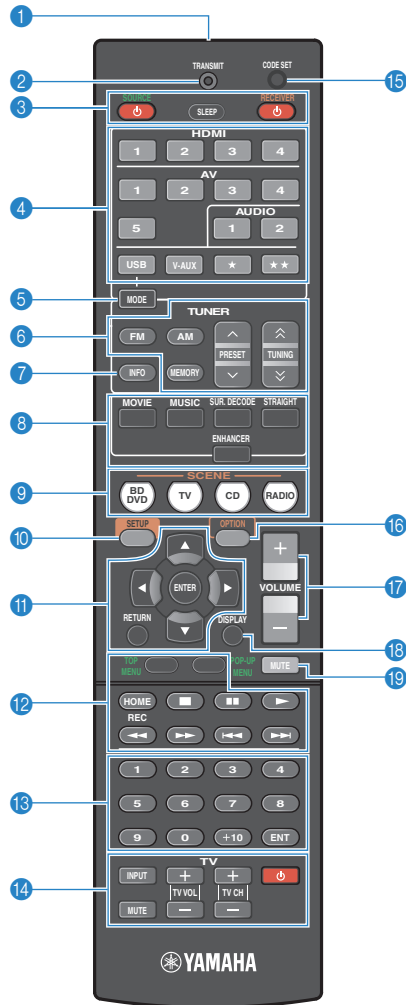

1 Remote control signal transmitter

Transmits infrared signals.

2 TRANSMIT indicator

Lights up when remote control signals are transmitted.

3 SOURCE key

Turns on/off an external device (p.3).

SLEEP key

Switches the unit to standby mode automatically after a specified period of time has elapsed (sleep timer). Press repeatedly to set the time (120 min, 90 min, 60 min, 30 min, off).

RECEIVER key

Turns on/off (standby) the unit.

4 Input selection keys

Select an input source for playback.

- HDMI 1-4** HDMI 1-4 jacks
- AV 1-5** AV 1-5 jacks
- AUDIO 1-2** AUDIO 1-2 jacks
- USB** USB jack (on the front panel)
- V-AUX** VIDEO AUX jacks (on the front panel)
- ★/★★** Change the external device to be controlled without switching the input source.

5 MODE key

Switches between "Stereo" and "Mono" for FM radio reception.

Switches the iPod operation modes.

6 Radio keys

Operate the FM/AM radio.

- FM** Switches to FM radio.
- AM** Switches to AM radio.
- MEMORY** Registers FM/AM radio stations as presets.
- PRESET** Select a preset station.
- TUNING** Select the radio frequency.

7 INFO key

Selects the information displayed on the front display.

8 Sound mode keys

Select a sound mode.

9 SCENE keys

Select the registered input source and sound program with one touch. Also, turns on the unit when it is in standby mode.

10 SETUP key

Displays the setup menu.

11 Menu operation keys

- Cursor keys** Select a menu or a parameter.
- ENTER** Confirms a selected item.
- RETURN** Returns to the previous screen.

12 External device operation keys

Let you play back and select menus and perform other operations for external devices (p.3).

13 Numeric keys

Let you enter numerical values (p.3).

14 TV operation keys

Let you select TV input and volume and perform other TV operations (p.2).

15 CODE SET button

Registers remote control codes of external devices on the remote control (p.2).

16 OPTION key

Displays the option menu.

17 VOLUME keys

Adjust the volume.

18 DISPLAY key

Switches between the browser and playback screens during playback of the iPod or USB storage device. Switches the display information for the external device (p.3).

19 MUTE key

Mutes the audio output.



- To operate external devices with the remote control, register a remote control code for each device before using (p.2).



Controlling external devices with the remote control

You can use the unit's remote control to operate external devices (such as BD/DVD players) if you have registered the remote control code of the external device.



- You cannot control an external device that does not have a remote control sensor.
- Ensure that the remote control ID of the external device is set to "ID1". If any other ID is selected, the remote control operations may not work properly.
- If the unit's remote control is without batteries for more than 2 minutes, the registered codes may be cleared. If this happens, insert new batteries and register the codes again.



- Under the unit's default settings, the amplifier code (Yamaha: 5098) is set for all the input selection keys. With this setting, you can control HDMI Control-compatible devices connected to the unit with the remote control. (This function may not work depending on the specification of the external device.)

Registering the remote control code for a TV

You can use the unit's remote control to operate a TV if you have registered its remote control code.



- You can also register your TV's remote control code to the unit's input selection keys (p.3). This would allow you to use the cursor keys or numeric keys to operate the TV (this function may not be available on some TV models).

1 See "List of remote control codes" (p.6) to find your TV's remote control code.



- If there are multiple remote control codes, register the first code in the list. If that does not work, try the other codes.

2 Press CODE SET using a pointed object such as the tip of a ballpoint pen.

The TRANSMIT indicator blinks twice.

Perform each of the following steps within 1 minute. Otherwise, the setting will be canceled. If this happens, repeat from Step 2.

3 Press TV

4 Use the numeric keys to enter the 4-digit remote control code.

Once the remote control code is successfully registered, the TRANSMIT indicator blinks twice.

If it blinks six times, registration has failed. Repeat from Step 2.

TV operations

Once you have registered the remote control code for your TV, you can control it using the TV operation keys, regardless of the input source selected on the unit.

| | | |
|-------------------|--------|--------------------------------------|
| | INPUT | Switches the video inputs of the TV. |
| | MUTE | Mutes the audio output of the TV. |
| TV operation keys | TV VOL | Adjust the volume of the TV. |
| | TV CH | Switch the channels of the TV |
| | TV | Turns on/off the TV. |

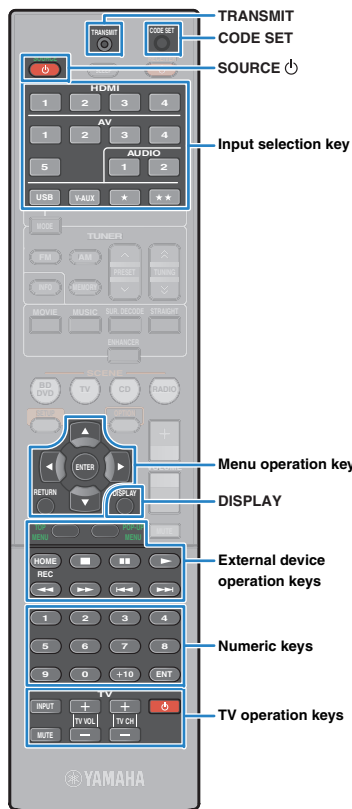

Registering the remote control codes for playback devices

You can use the unit's remote control to operate playback devices if you have registered their remote control codes. You can also use the input selection keys to change the playback devices that are controlled by the remote control, because their remote control codes are assigned to the input selection keys.



- If you assign the remote control code for an external device to the star (★ or ★★) key, you can operate the device with the remote control without switching the input source after pressing the star key.

1 See “List of remote control codes” (p.6) to find the remote control code for your playback device.



- If there are multiple remote control codes, register the first code in the list. If that does not work, try the other codes.

2 Press CODE SET using a pointed object such as the tip of a ballpoint pen.

The TRANSMIT indicator blinks twice.

Perform each of the following steps within 1 minute. Otherwise, the setting will be canceled. If this happens, repeat from Step 2.

3 Press the input selection key.

For example, press HDMI 1 to set the remote control code for the playback device connected to the HDMI 1 jack.

4 Use the numeric keys to enter the 4-digit remote control code.

Once the remote control code is registered successfully, the TRANSMIT indicator blinks twice.

If it blinks six times, registration has failed. Repeat from Step 2.



- For details on how to register a remote control code to a SCENE key, see “Changing the external device assigned to the SCENE keys” (p.4)

Playback device operations

Once you have registered the remote control code for your playback device, you can control it using the following keys after selecting the input source or scene.

| | | |
|--------------------------------|--------------------------------------|----------------------------------------------|
| SOURCE | Turns on/off the playback device. | |
| Menu operation keys | Cursor keys | Select an item. |
| | ENTER | Confirms a selected item. |
| | RETURN | Returns to the previous screen. |
| DISPLAY | Switches information on the display. | |
| External device operation keys | TOP MENU | Displays the top menu. |
| | POP-UP MENU | Displays the pop-up menu. |
| | HOME/REC | Displays the home menu. Starts recording. |
| | ■ | Stops playback. |
| | ■ | Stops playback temporarily. |
| | ▶ | Starts playback of the selected song/video. |
| | ◀▶ | Searches forward/backward (by holding down). |
| | ▶▶ | Skips forward/backward. |
| | ▶▶ | Skips forward/backward. |
| | Numeric keys | Enter numerical values. |
| TV operation keys | Control the TV (p.2). | |



- These keys work only if the corresponding function is available on your playback device and if the device can be operated with an infrared remote control.

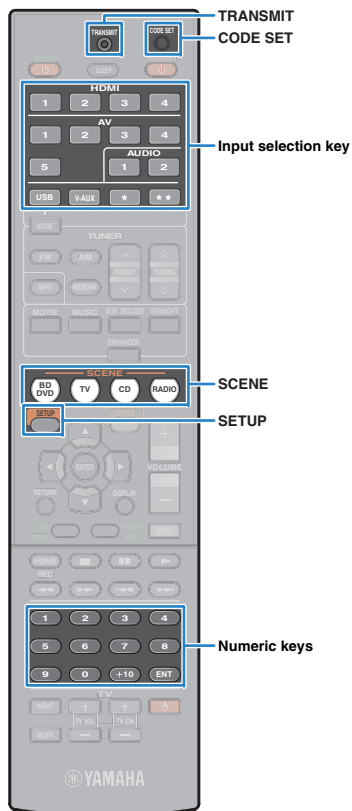

Changing the external device assigned to the SCENE keys

If you want to control your playback device after selecting a scene, follow the procedure below.

- 1 If you have not registered the remote control code for the device yet, follow “Registering the remote control codes for playback device” (p.3).**
- 2 Hold down the corresponding SCENE key and input selection key together for more than 3 seconds.**

Once the setting is successfully completed, the TRANSMIT indicator blinks twice.

If it blinks six times, the setting has failed. Repeat step 2.

Resetting remote control codes

You can reset a remote control code registered to each input selection key.

- 1 Press CODE SET using a pointed object such as the tip of a ballpoint pen.**
The TRANSMIT indicator blinks twice.
Perform each of the following steps within 1 minute. Otherwise, the setting will be canceled. If this happens, repeat from Step 1.
- 2 Press the input selection key.**
- 3 Use the numeric keys to enter “5098”.**

Once the remote control code is reset successfully, the TRANSMIT indicator blinks twice.

If it blinks six times, resetting has failed. Repeat from Step 1.

To reset the remote control to factory default settings

- ① Press CODE SET using a pointed object such as the tip of a ballpoint pen.
- ② Press SETUP.
- ③ Use the numeric keys to enter “9981”.

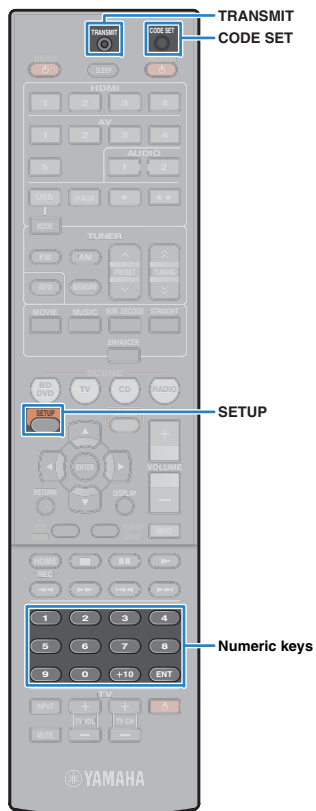

Changing the remote control ID of the remote control

Change the remote control's ID so that it matches the unit's remote control ID.



- Perform each of the following steps within 1 minute. Otherwise, the setting will be automatically canceled.

- 1 Press CODE SET on the remote control using a pointed object, such as the tip of a ballpoint pen.**
- 2 Press SETUP.**
- 3 Use the numeric keys to enter “5019” (ID1) or “5020” (ID2).**

Once the remote control ID is registered successfully, the TRANSMIT indicator blinks twice.

If it blinks six times, registration failed. Repeat from Step 1.



- The registered remote control codes are not cleared even if you change the remote control ID.
- You can change the unit's remote control ID in the “ADVANCED SETUP” menu. For details, refer to “Owner’s Manual”.

List of remote control codes

TV

| | | | | | | | |
|----------------|------------------------------------------------------------------------------|----------------|------------------------------------------------|----------------------|------------------------------------------------------------------------------------------------------------------------|----------------|------------------------------------------------------------------------------------------------------------------------|
| A.R. Systems | 0320 | Arthur Martin | 0321 | Bush | 0269, 0282, 0283, 0304, 0320, 0323, 0328, 0332, 0340, 0343, 0344, 0346, 0348, 0349, 0350, 0372, 0382, 0463, 0470, 0472 | Crown | 0058, 0161, 0171, 0179, 0320, 0323, 0343, 0349, 0350, 0351 |
| Acme | 0342 | ASA | 0339, 0347 | byd:sign | 0093 | CS Electronics | 0277, 0340, 0342 |
| Acura | 0323, 0343 | Asberg | 0171, 0320, 0350 | Candle | 0008, 0026, 0050, 0057 | CTC Clatronic | 0341 |
| ADC | 0337 | Astra | 0343 | Capsonic | 0337 | CTX | 0205 |
| Admiral | 0054, 0178, 0336, 0337, 0339, 0346, 0347 | Asuka | 0277, 0282, 0337, 0340, 0342 | Carena | 0320 | Curtis Mathes | 0007, 0008, 0010, 0019, 0021, 0026, 0049, 0050, 0178 |
| Advent | 0158 | Atlantic | 0277, 0320, 0342, 0349, 0350 | Carnivale | 0050 | CXC | 0058, 0179 |
| Adventura | 0057 | Atori | 0323, 0343 | Carrefour | 0344 | Cybertron | 0340 |
| Adyson | 0277, 0282, 0342 | Auchan | 0321 | Carver | 0010 | Cytron | 0152 |
| Agashi | 0277, 0282 | Audiosonic | 0161, 0282, 0320, 0340, 0342, 0343, 0349, 0350 | Cascade | 0320, 0323, 0343 | Daewoo | 0007, 0008, 0026, 0037, 0053, 0167, 0266, 0275, 0277, 0282, 0315, 0320, 0323, 0331, 0335, 0342, 0343, 0350, 0381, 0465 |
| Agazi | 0337 | AudioTon | 0161, 0282, 0342 | Casio | 0367 | Dainichi | 0277, 0340 |
| Aiko | 0277, 0282, 0320, 0323, 0342, 0343 | Ausind | 0171 | Cathay | 0320, 0349, 0350 | Dansai | 0277, 0282, 0320, 0337, 0349, 0350 |
| Aim | 0320 | Autovox | 0171, 0282, 0337, 0339, 0342 | CCE | 0183, 0282 | Dantax | 0161, 0349 |
| Aiwa | 0078, 0379 | Aventura | 0051 | Celebrity | 0055, 0107 | Dawa | 0320 |
| Akai | 0050, 0055, 0109, 0159, 0181, 0277, 0282, 0320, 0323, 0340, 0343, 0349, 0350 | Awa | 0277, 0282 | Celera | 0039 | Daytron | 0007, 0008, 0026, 0323, 0343 |
| Akiba | 0320, 0340 | Axion | 0156 | Centurion | 0320, 0349, 0350 | De Graaf | 0346 |
| Akura | 0320, 0323, 0337, 0340 | Baird | 0282 | Century | 0339 | Decca | 0282, 0320, 0342, 0349, 0350 |
| Alaron | 0277 | Bang & Olufsen | 0180, 0339 | CGE | 0161, 0171 | Dell | 0145, 0245 |
| Alba | 0161, 0277, 0320, 0323, 0340, 0342, 0343, 0344, 0349, 0351, 0372, 0382 | Basic Line | 0282, 0320, 0323, 0340, 0343, 0350 | Changhong | 0039 | Denver | 0358, 0362 |
| Albatron | 0140 | Bastide | 0282, 0342 | Chimei | 0273 | Desmet | 0320, 0349, 0350 |
| Alcyon | 0171 | Baur | 0320, 0349 | Cimline | 0323, 0343 | Diamant | 0320 |
| Alleron | 0059 | Bazin | 0282 | Citizen | 0007, 0008, 0026, 0050, 0058 | Diamond | 0277 |
| Allorgan | 0282 | Beko | 0161, 0269, 0294, 0302, 0311, 0320, 0328, 0351 | City | 0323, 0343 | DiamondVision | 0135, 0143 |
| Allstar | 0320, 0350 | Belcor | 0008 | Clarion | 0179 | Dimensia | 0049 |
| America Action | 0179 | Bell & Howell | 0019, 0054 | Clarivox | 0349 | Disney | 0219 |
| AMOi | 0276 | Benq | 0097, 0242, 0361 | Clatronic | 0161, 0171, 0282, 0320, 0323, 0337, 0340, 0342, 0343, 0350, 0351 | Dixi | 0282, 0320, 0323, 0343, 0349, 0350 |
| Amplivision | 0161, 0282, 0321, 0342 | Beon | 0320, 0349, 0350 | CMS | 0277 | Dream Vision | 0461, 0498 |
| Amstrad | 0320, 0323, 0337, 0340, 0343 | Best | 0161 | CMS Hightec | 0282 | DTS | 0323, 0343 |
| Amtron | 0058 | Bestar | 0161, 0320, 0350 | Coby | 0197 | Dual | 0282, 0320, 0342 |
| Anam | 0179, 0343 | Binatone | 0282, 0342 | Colorlyme | 0008, 0026 | Dual-Tec | 0342, 0343 |
| Anam National | 0052, 0058 | Blue Sky | 0320, 0340 | Commercial Solutions | 0021 | Dumont | 0008, 0030, 0062, 0282, 0339, 0341, 0342 |
| Anglo | 0323, 0343 | Blue Star | 0348 | Concerto | 0008, 0026 | Durabrand | 0031, 0051, 0179, 0215 |
| Anitech | 0171, 0320, 0323, 0337, 0343 | Boots | 0282, 0342 | Concorde | 0323, 0343 | Dux | 0349 |
| Ansonic | 0161, 0168, 0320, 0323, 0341, 0343 | BPL | 0320, 0348 | Condor | 0161, 0277, 0320, 0323, 0342, 0350, 0351 | Dwin | 0178 |
| AOC | 0008, 0026, 0050, 0053 | Bradford | 0058, 0179 | Contec | 0179, 0277, 0323, 0342, 0343, 0344 | Dynatron | 0320, 0349, 0350 |
| Apex | 0039, 0111, 0217 | Brandt | 0322, 0345 | Contec/Cony | 0012, 0058 | Dynex | 0228, 0231 |
| Arcam | 0277, 0282 | Brilliant | 0182 | Continental Edison | 0345 | EIZO | 0509 |
| Arcam Delta | 0342 | Brinkmann | 0320 | Cosmel | 0323, 0343 | Elbe | 0161, 0168, 0282, 0320 |
| Aristona | 0320, 0349, 0350 | Brionvega | 0320, 0339, 0349, 0350 | Craig | 0058, 0179 | Electa | 0339 |
| | | Britannia | 0277, 0282, 0342 | Crosley | 0010, 0037, 0171, 0339 | ELECTRO TECH | 0343 |
| | | Brockwood | 0008 | | | | |
| | | Broksonic | 0109, 0179 | | | | |
| | | Bruns | 0339 | | | | |
| | | BTC | 0340 | | | | |

| | | | | | | | |
|------------------|------------------------------------------------------------------------------------------------|-----------------|------------------------------------------------------------------------------------------------------|-----------------|------------------------------------------------------------------------------------------------------------------------------------------------------------------------------|----------------|-------------------------------------------------------------------------------------------|
| Electroband | 0055, 0107 | Fujitsu Siemens | 0504, 0505, 0507, 0510, 0511 | Harwood | 0320, 0323 | Intervision | 0161, 0282, 0320, 0337, 0341, 0342 |
| Electrograph | 0176 | Funai | 0051, 0058, 0059, 0112, 0113, 0115, 0118, 0119, 0179, 0337, 0488, 0489 | Havermy | 0178 | Irradio | 0171, 0320, 0323, 0340, 0343, 0349, 0350 |
| Electrohme | 0008, 0026, 0052, 0055 | | | HCM | 0282, 0320, 0323, 0337, 0342, 0343, 0348 | Isukai | 0320, 0340 |
| Element | 0230 | | | Hema | 0282, 0323 | ITC | 0282, 0342 |
| Elin | 0277, 0320, 0323, 0342, 0349, 0350 | Futuretech | 0058, 0179 | Hewlett Packard | 0192 | ITS | 0277, 0320, 0340, 0348, 0350 |
| Elite | 0320, 0340, 0350 | Galaxi | 0320, 0351 | Higashi | 0277 | ITT | 0343, 0347 |
| Elman | 0341 | Galaxis | 0161, 0320 | HiLine | 0320 | ITV | 0320, 0343, 0349 |
| Elta | 0277, 0323, 0343 | Gateway | 0176, 0177, 0241 | Hinari | 0320, 0323, 0340, 0343, 0344, 0349, 0350 | Janeil | 0057 |
| Emerson | 0000, 0007, 0008, 0012, 0013, 0019, 0026, 0031, 0037, 0051, 0058, 0059, 0161, 0179, 0320, 0339 | GBC | 0323, 0343, 0344 | Hisawa | 0321, 0340, 0348 | JBL | 0010 |
| | | GE | 0008, 0021, 0023, 0026, 0027, 0031, 0034, 0049, 0052, 0056, 0209 | Hisense | 0247 | JC Penney | 0007, 0008, 0026, 0027, 0049, 0053, 0056 |
| Emprex | 0154 | Geant Casino | 0321 | Hitachi | 0008, 0012, 0026, 0066, 0084, 0092, 0093, 0120, 0172, 0173, 0255, 0270, 0271, 0282, 0320, 0335, 0338, 0342, 0344, 0346, 0347, 0365, 0382, 0448, 0456, 0467, 0482, 0484, 0487 | JCB | 0055, 0107 |
| Envision | 0008, 0026, 0050 | GEC | 0282, 0320, 0342, 0347, 0349, 0350 | Hornyphon | 0320, 0350 | Jensen | 0008, 0026 |
| Epson | 0155, 0206, 0359 | Geloso | 0323, 0343, 0346 | Hoshai | 0340 | JVC | 0012, 0014, 0015, 0056, 0064, 0065, 0067, 0169, 0174, 0297, 0314, 0344, 0350, 0375 |
| Erres | 0320, 0349, 0350 | General Technic | 0323, 0343 | Huanyu | 0277, 0342 | Kaisui | 0277, 0282, 0320, 0323, 0340, 0342, 0343, 0348 |
| ESA | 0051 | Genexxa | 0320, 0340, 0347, 0350 | Hygashi | 0277, 0282, 0342 | Kamosonic | 0342 |
| ESC | 0282 | GFM | 0128, 0227 | Hypson | 0277, 0282, 0323, 0342, 0343 | Kamp | 0277, 0342 |
| Etron | 0343 | Giant | 0282 | Hypson | 0282, 0320, 0321, 0337, 0342, 0348, 0349, 0350 | Kapsch | 0347 |
| Eurofeel | 0282 | Gibralter | 0008, 0030, 0050, 0062 | Hyundai | 0141 | Karcher | 0161, 0320, 0342, 0343, 0349 |
| Euro-Feel | 0337 | GoldHand | 0277 | Iberia | 0320 | Kawasho | 0008, 0026, 0055, 0277 |
| Euroline | 0349 | Goldline | 0320 | ICE | 0277, 0282, 0320, 0323, 0337, 0340, 0342, 0343, 0350 | KEC | 0179 |
| Euroman | 0161, 0277, 0282 | GoldStar | 0007, 0008, 0012, 0026, 0031, 0050, 0053, 0161, 0277, 0282, 0320, 0323, 0342, 0343, 0346, 0349, 0350 | ICeS | 0277 | Kendo | 0161, 0320, 0341, 0346 |
| Euromann | 0320, 0337, 0342, 0350 | Goodmans | 0246, 0272, 0282, 0320, 0323, 0337, 0343, 0344, 0349, 0350, 0462, 0473, 0477 | Ilo | 0148, 0153 | Kenwood | 0008, 0026, 0050 |
| Europhon | 0277, 0282, 0320, 0341, 0342, 0350 | Gorenje | 0161, 0351 | IMA | 0058 | KIC | 0282 |
| Expert | 0321 | GPM | 0340 | Imperial | 0161, 0171, 0320, 0347, 0350, 0351 | Kingsley | 0277, 0342 |
| Exquisit | 0320 | GPX | 0129 | Indiana | 0320, 0349, 0350 | KLH | 0039 |
| Fenner | 0323, 0343 | Gradiente | 0240 | Infinity | 0010 | Kloss Novabeam | 0057, 0058 |
| Ferguson | 0322, 0345, 0349 | Graetz | 0347 | InFocus | 0250, 0327, 0363, 0479, 0508 | Kneissel | 0161, 0168, 0320 |
| Fidelity | 0277, 0320, 0342, 0346 | Granada | 0171, 0282, 0320, 0321, 0342, 0344, 0346, 0349, 0350 | Ingelen | 0347 | Kolster | 0320, 0350 |
| Filsai | 0282 | Grandin | 0340, 0343, 0348, 0349 | Ingersol | 0323, 0343 | Konka | 0340 |
| Finlandia | 0346 | Gronic | 0282 | Initial | 0153 | Korpel | 0320, 0349, 0350 |
| Finlux | 0171, 0282, 0320, 0339, 0341, 0342, 0349, 0350 | Grundig | 0160, 0161, 0171, 0310, 0320 | Inno Hit | 0171, 0282, 0320, 0323, 0340, 0342, 0343, 0349, 0350 | Korting | 0161, 0339 |
| FIRST LINE | 0342, 0343, 0350 | Grunpy | 0058, 0059, 0179 | Innovation | 0337, 0343 | Kosmos | 0320 |
| Firstline | 0277, 0282, 0320, 0323 | Haier | 0157, 0233 | Insignia | 0131, 0228, 0236, 0238 | Koyoda | 0343 |
| Fisher | 0019, 0161, 0282, 0339, 0342, 0344, 0351 | Hallmark | 0008, 0026, 0031 | Inteq | 0030 | KTV | 0007, 0050, 0058, 0179, 0183, 0282, 0342 |
| Flint | 0320, 0350 | Hampton | 0277, 0282, 0342 | Interactive | 0161 | Kyoto | 0277, 0282 |
| Formenti | 0171, 0277, 0336, 0339, 0342, 0349 | Hanseatic | 0161, 0168, 0282, 0320, 0323, 0342, 0343, 0344, 0349, 0350 | Interbuy | 0323, 0343 | Lasat | 0161 |
| Formenti/Phoenix | 0277 | Hantarex | 0320, 0323, 0343 | Interfunk | 0161, 0320, 0339, 0347, 0349, 0350 | Lenco | 0323, 0343 |
| Fortress | 0336, 0339 | Hantor | 0320 | International | 0277 | Lenoir | 0323, 0342, 0343 |
| Fraba | 0161, 0320 | Harman/Kardon | 0010 | | | Leyco | 0320, 0337, 0349, 0350 |
| Friac | 0161 | Harvard | 0058, 0179 | | | LG | 0031, 0053, 0066, 0116, 0117, 0140, 0161, 0164, 0175, 0195, 0269, 0277, 0282, 0300, 0309, |
| Frontech | 0282, 0323, 0337, 0343, 0346, 0347 | | | | | | |
| Fujitsu | 0059, 0069, 0074, 0075, 0282 | | | | | | |
| Fujitsu General | 0282 | | | | | | |

| | | | | | | | |
|--------------|------------------------------------------------------------------------------------------|-----------------|------------------------------------------------------------------------------------------------|--------------|------------------------------------------------------------------------------------------------------------------------------------------------------------------------------------------------------------------------------------------------------------------------------------------------------------|----------------------|------------------------------------------------------------------------------|
| | 0317, 0320, 0323, 0328, 0342, 0343, 0346, 0349, 0350, 0366, 0368, 0377, 0466, 0471, 0478 | Memphis | 0323, 0343 | Novatronic | 0320 | Phoenix | 0161, 0277, 0320, 0339, 0349, 0350 |
| LG/GoldStar | 0164 | Mercury | 0320, 0323 | Oceanic | 0321, 0347 | Phonola | 0277, 0320, 0339, 0349, 0350 |
| Liesenk | 0349 | Metz | 0339 | Okano | 0161, 0320, 0351 | Pilot | 0007, 0008, 0050 |
| Liesenkotter | 0320 | MGA | 0008, 0026, 0031, 0050, 0053 | Olevia | 0102, 0199, 0200, 0207, 0222 | Pioneer | 0008, 0026, 0094, 0095, 0161, 0320, 0345, 0347, 0349, 0350, 0458, 0480 |
| Life | 0337, 0343 | Micromaxx | 0337, 0343 | ONCEAS | 0342 | Plantron | 0320, 0323, 0337, 0350 |
| Lifetec | 0320, 0323, 0337, 0343 | Microstar | 0337, 0343 | Onwa | 0058, 0179 | Playsonic | 0282 |
| Lloyds | 0323 | Midland | 0007, 0021, 0023, 0027, 0030, 0056, 0062 | Opera | 0320 | Polaroid | 0039, 0142, 0202, 0234 |
| Loewe | 0161, 0168, 0265, 0320, 0330, 0352 | Minerva | 0171 | Oppo | 0130 | Poppy | 0323, 0343 |
| Loewe Opta | 0339, 0349, 0350 | Minoka | 0320, 0350 | Optimus | 0017, 0019 | Portland | 0007, 0008, 0026, 0053 |
| Logik | 0054 | Mintek | 0153 | Optoma | 0144 | Prandoni-Prince | 0171, 0346 |
| Luma | 0320, 0323, 0346, 0349 | Mitsubishi | 0008, 0026, 0031, 0053, 0066, 0084, 0093, 0098, 0150, 0178, 0289, 0320, 0339, 0344, 0350, 0376 | Optonica | 0178 | Precision | 0282, 0342 |
| Lumatron | 0282, 0320, 0346, 0349, 0350 | | | Orbit | 0320, 0350 | Prima | 0157, 0243, 0323, 0343, 0347 |
| Lux May | 0350 | Mivar | 0161, 0168, 0171, 0277, 0282, 0342 | Orion | 0043, 0146, 0283, 0320, 0323, 0328, 0343, 0349, 0350 | Princeton | 0140 |
| Luxman | 0008, 0026 | | | Orline | 0320 | Prism | 0023, 0056 |
| Luxor | 0282, 0342, 0346 | Monivision | 0140 | Osaki | 0282, 0320, 0337, 0340, 0342 | Profex | 0323, 0343 |
| LXI | 0010, 0019, 0021, 0026, 0027, 0031, 0049, 0111 | Montgomery Ward | 0054 | Oso | 0340 | Profi-Tronic | 0320, 0350 |
| M Electronic | 0342, 0343, 0345, 0347, 0349, 0350 | Motion | 0171 | Otto Versand | 0282, 0320, 0336, 0342, 0344, 0348, 0349, 0350 | Proline | 0320, 0350 |
| MAG | 0096 | Motorola | 0052, 0178 | Pael | 0277, 0342 | Proscan | 0021, 0027, 0049 |
| Magnadyne | 0339, 0341, 0349 | MTC | 0008, 0026, 0050, 0053, 0161, 0277 | Palladium | 0161, 0282, 0320, 0342, 0351 | Prosonic | 0161, 0277, 0282, 0320, 0342, 0349 |
| Magnafon | 0171, 0277, 0341, 0342 | | | Panama | 0277, 0282, 0320, 0323, 0337, 0342, 0343 | Protech | 0282, 0337, 0341, 0342, 0343, 0349, 0350 |
| Magnavox | 0008, 0009, 0010, 0013, 0026, 0032, 0033, 0048, 0050, 0128, 0211, 0212, 0224, 0226, 0239 | Multi System | 0349 | Panasonic | 0016, 0017, 0020, 0022, 0023, 0035, 0052, 0056, 0084, 0085, 0133, 0163, 0193, 0284, 0286, 0290, 0292, 0320, 0325, 0347, 0356, 0483, 0485, 0490 | Proton | 0008, 0012, 0026, 0031 |
| Magnum | 0337, 0343 | Multitech | 0058, 0161, 0179, 0183, 0277, 0282, 0320, 0323, 0341, 0342, 0343, 0344, 0346, 0349 | | | Prottron | 0196 |
| Majestic | 0054 | Murphy | 0277, 0342 | Panavision | 0320 | PROVIEW | 0096, 0246 |
| Mandor | 0337 | NAD | 0026, 0031, 0111 | Pathe Cinema | 0161, 0168, 0277, 0321, 0342 | Provision | 0320, 0349 |
| Manesth | 0282, 0320, 0337, 0342, 0349, 0350 | Naonis | 0346 | Pausa | 0323, 0343 | Pulsar | 0008, 0030, 0062 |
| Marantz | 0008, 0010, 0026, 0050, 0204, 0320, 0349, 0350 | NEC | 0008, 0026, 0050, 0052, 0053, 0072, 0103, 0282, 0344 | Penney | 0021, 0023, 0031, 0050, 0111 | Pye | 0256, 0320, 0349, 0350, 0378 |
| Marelli | 0339 | Neckermann | 0161, 0282, 0320, 0339, 0342, 0346, 0349, 0350, 0351 | Perdio | 0277, 0320 | Pymi | 0323, 0343 |
| Mark | 0277, 0282, 0320, 0323, 0349, 0350 | NEI | 0320, 0349, 0350 | Perfekt | 0320 | Quandra Vision | 0321 |
| Masuda | 0282 | Net-TV | 0176 | Philco | 0008, 0009, 0010, 0012, 0026, 0050, 0052, 0053, 0161, 0171, 0320, 0339 | Quasar | 0017, 0023, 0052, 0056 |
| Matsui | 0282, 0320, 0323, 0342, 0343, 0344, 0346, 0349, 0350, 0455 | Neufunk | 0320, 0323 | Philharmonic | 0282, 0342 | Quelle | 0282, 0320, 0337, 0342, 0349, 0350 |
| Matsushita | 0017 | New Tech | 0343, 0350 | Philips | 0008, 0009, 0010, 0011, 0012, 0032, 0048, 0049, 0052, 0122, 0128, 0134, 0186, 0187, 0213, 0221, 0224, 0226, 0239, 0256, 0257, 0259, 0261, 0263, 0267, 0280, 0281, 0287, 0296, 0299, 0301, 0303, 0305, 0313, 0319, 0320, 0324, 0333, 0339, 0342, 0349, 0350, 0353, 0357, 0360, 0380, 0383, 0452, 0459, 0460 | Questa | 0344 |
| Maxent | 0147, 0176 | New World | 0340 | | | Radialva | 0320 |
| Mediator | 0320, 0349, 0350 | NewTech | 0282, 0320, 0323 | | | RadioShack | 0019, 0021, 0031, 0050, 0179, 0320 |
| Medion | 0320, 0337, 0343 | Nicamagic | 0277, 0342 | | | RadioShack/Realistic | 0007, 0008, 0012, 0026, 0049, 0058 |
| Megapower | 0140 | Nikkai | 0277, 0282, 0320, 0323, 0337, 0340, 0342, 0349, 0350 | | | Radiola | 0282, 0320, 0349, 0350 |
| Megatron | 0026, 0031 | Nikko | 0026, 0031, 0050 | | | Radiomarelli | 0320, 0339 |
| MElectronic | 0277, 0282, 0320, 0323 | Noblisko | 0171, 0277, 0341, 0342 | | | Radiotone | 0161, 0320, 0323, 0350 |
| Melvox | 0321 | Nokia | 0347 | | | Rank | 0344 |
| Memorex | 0019, 0026, 0031, 0053, 0054, 0137, 0215, 0323, 0343 | Norcent | 0201 | | | RCA | 0008, 0021, 0024, 0025, 0026, 0027, 0042, 0049, 0052, 0053, 0063, 0136, 0225 |
| | | Nordic | 0282 | | | Realistic | 0019, 0031, 0050, 0179 |
| | | Nordmende | 0339, 0345, 0347, 0350 | | | | |
| | | Nordvision | 0349 | | | | |

| | | | | | | | |
|---------------|------------------------------------------------------------------------------------------------------------------------------------------------------------------------------------------------------------------------------------------------------|----------------|------------------------------------------------------------------------------------------------------------------------------------------------------------------------------------------------------------------|------------------|------------------------------------------------------------------------|-----------------|------------------------------------------------------------------------------------------------------------------------------------------------------------------------------------------|
| Recor | 0320 | Sentra | 0323 | Supra | 0323, 0343 | Tokai | 0282, 0320, 0350 |
| Redstar | 0320 | Serino | 0277 | Supre-Macy | 0057 | Tokyo | 0277, 0342 |
| Reflex | 0320 | Sharp | 0000, 0001, 0002, 0003, 0007, 0008, 0012, 0026, 0060, 0088, 0089, 0091, 0138, 0165, 0170, 0178, 0198, 0229, 0262, 0278, 0279, 0291, 0308, 0312, 0336, 0344, 0354, 0370, 0449, 0450, 0451, 0464, 0474, 0476, 0481 | Supreme | 0055, 0107 | Tomashi | 0348 |
| Revox | 0161, 0320, 0349, 0350 | | | Susumu | 0340 | Toshiba | 0018, 0019, 0040, 0041, 0046, 0073, 0100, 0103, 0108, 0109, 0111, 0121, 0132, 0166, 0208, 0210, 0214, 0217, 0260, 0268, 0282, 0283, 0293, 0304, 0306, 0307, 0329, 0344, 0355, 0454, 0491 |
| Rex | 0337, 0346, 0347 | | | Sutron | 0323, 0343 | | |
| RFT | 0161, 0168, 0339 | | | SVA | 0151 | | |
| Rhapsody | 0277 | | | Sydney | 0277, 0282, 0342 | | |
| R-Line | 0320, 0349, 0350 | | | Sylvania | 0008, 0009, 0010, 0011, 0013, 0026, 0048, 0050, 0051, 0128, 0227, 0253 | | |
| Roadstar | 0323, 0337, 0340, 0343 | | | Symphonic | 0051, 0058, 0062, 0128, 0179, 0215 | Totevision | 0007 |
| Robotron | 0339 | Sheng Chia | 0178 | | | Towada | 0282, 0347 |
| Rowa | 0277, 0282 | Shogun | 0008 | Syntax | 0199 | Trakton | 0282 |
| Royal Lux | 0161 | Siarem | 0320, 0339, 0341 | Syntax-Brilliant | 0199 | Trans Continens | 0282, 0320 |
| RTF | 0339 | Sierra | 0320, 0350 | Sysline | 0349 | Transtec | 0277 |
| Runco | 0030, 0050, 0062 | Siesta | 0161 | Sytong | 0277 | Trident | 0282 |
| Saba | 0298, 0322, 0339, 0345, 0347 | Signature | 0054 | Tandy | 0178, 0282, 0336, 0340, 0342, 0347 | Triumph | 0320 |
| Saisho | 0282, 0323, 0337, 0342, 0343 | Silva | 0277 | Tashiko | 0277, 0282, 0342, 0344, 0346 | Uher | 0161, 0171, 0320, 0347, 0350 |
| Salora | 0346, 0347 | Silver | 0344 | Tatung | 0052, 0177, 0282, 0320, 0342, 0349, 0350 | Ultravox | 0277, 0320, 0339, 0341, 0342 |
| Sambers | 0171, 0341 | Singer | 0321, 0339, 0341 | TCM | 0337, 0343 | Unic Line | 0320 |
| Sampo | 0007, 0008, 0026, 0050, 0176 | Sinudyne | 0320, 0339, 0341, 0349 | Teac | 0282, 0320 | United | 0349 |
| Samsung | 0004, 0005, 0006, 0007, 0008, 0012, 0026, 0031, 0036, 0050, 0053, 0076, 0077, 0079, 0114, 0124, 0125, 0126, 0127, 0139, 0161, 0183, 0185, 0190, 0191, 0258, 0264, 0277, 0282, 0320, 0323, 0334, 0337, 0342, 0343, 0349, 0350, 0351, 0373, 0453, 0468 | Skantic | 0347 | Tec | 0282, 0323, 0342, 0343 | Univox | 0320 |
| | | Solavox | 0347 | Technics | 0017, 0023, 0056 | Vector Research | 0050 |
| | | Sonitron | 0161, 0282 | TechniSat | 0274, 0496, 0497, 0499 | Vestel | 0282, 0320, 0346, 0347, 0349, 0350, 0351 |
| | | Sonoko | 0282, 0320, 0323, 0337, 0342, 0343, 0349, 0350 | Techwood | 0008, 0023, 0026, 0056 | Vexa | 0320, 0323, 0343, 0349 |
| | | Sonolor | 0321, 0347 | TEDELEX | 0282 | Victor | 0015, 0344, 0350 |
| | | Sontec | 0161, 0320, 0349, 0350 | Teknika | 0007, 0008, 0010, 0012, 0026, 0053, 0054, 0058, 0059, 0179 | VIDEOLOGIC | 0277 |
| | | Sony | 0038, 0044, 0045, 0047, 0055, 0090, 0104, 0105, 0107, 0110, 0123, 0184, 0220, 0248, 0249, 0251, 0252, 0254, 0326, 0343, 0344, 0371, 0374, 0457, 0475, 0486 | Teleavia | 0345 | Videologique | 0277, 0282, 0340, 0342 |
| Sandra | 0277, 0282, 0342 | | | Telecor | 0282, 0320 | VideoSystem | 0320, 0350 |
| Sansui | 0043, 0109, 0320, 0350 | Sound & Vision | 0340, 0341 | Telefunken | 0320, 0322, 0345, 0350 | Videotechnic | 0277, 0282 |
| Sanyo | 0008, 0019, 0068, 0070, 0071, 0099, 0161, 0168, 0223, 0237, 0277, 0282, 0288, 0295, 0323, 0342, 0344, 0369, 0469 | Soundesign | 0008, 0026, 0031, 0058, 0059, 0179 | Telegazi | 0320 | Vidikron | 0010 |
| | | Soundwave | 0320, 0349, 0350 | Telemeister | 0320 | Vidtech | 0008, 0026, 0031, 0053 |
| SBR | 0320, 0349 | Squareview | 0051 | Telesonic | 0320 | Viewsonic | 0176, 0203, 0232, 0364 |
| Sceptre | 0235, 0244 | SSS | 0008, 0058, 0179 | Telestar | 0320 | Viking | 0057 |
| Schaub Lorenz | 0347 | Standard | 0282, 0320, 0323, 0340, 0342, 0343, 0350 | Teletech | 0320, 0323, 0343, 0349 | Viore | 0148 |
| Schneider | 0282, 0316, 0318, 0320, 0333, 0340, 0342, 0349, 0350, 0382 | Starlite | 0058, 0179, 0320, 0323, 0349 | Teleton | 0282, 0342 | Visiola | 0277, 0342 |
| | | Stenway | 0348 | Televideon | 0277 | Vision | 0282, 0320, 0350 |
| Scotch | 0026, 0031 | Stern | 0346, 0347 | Televiso | 0321 | Vizio | 0008, 0177, 0218, 0242, 0500, 0501, 0502, 0503, 0506 |
| Scott | 0008, 0012, 0026, 0031, 0058, 0059, 0149, 0179 | Strato | 0320, 0323 | Tensai | 0282, 0320, 0323, 0340, 0343, 0350 | Vortec | 0320, 0349, 0350 |
| Sears | 0008, 0010, 0019, 0021, 0026, 0027, 0031, 0049, 0051, 0059, 0111 | Stylandia | 0282 | Tesmet | 0350 | Voxson | 0171, 0320, 0339, 0346, 0347, 0350 |
| SEG | 0277, 0282, 0320, 0323, 0337, 0341, 0342, 0344, 0349, 0382 | Sunkai | 0343 | Tevion | 0337, 0343 | Waltham | 0282, 0320, 0342 |
| | | Sunstar | 0320, 0323 | Textet | 0277, 0282, 0323, 0342 | Wards | 0008, 0009, 0010, 0026, 0031, 0048, 0049, 0050, 0053, 0054, 0059 |
| SEI | 0320 | Sunwood | 0320, 0323, 0343, 0350 | Thomson | 0162, 0188, 0189, 0285, 0320, 0322, 0342, 0345, 0350 | | |
| SEI-Sinudyne | 0339, 0341, 0347 | Superla | 0277, 0282, 0342 | Thorn | 0320, 0349 | | |
| Seleco | 0344, 0346, 0347 | Superscan | 0013, 0178 | TMK | 0008, 0026, 0031 | Watson | 0320, 0349, 0350 |
| Sencora | 0323, 0343 | SuperTech | 0277, 0320, 0323 | TNCi | 0030 | Watt Radio | 0277, 0341, 0342 |

Waycon 0111
Wega 0320, 0339, 0344
Wegavox 0323
Weltblick 0282, 0320, 0349, 0350
Westinghouse 0107, 0216, 0220
White Westinghouse
0037, 0090, 0277, 0320, 0341,
0342, 0349
Wincom 0101, 0106
Xrypton 0320
Yamaha 0008, 0026, 0050, 0053, 0080,
0081, 0082, 0083, 0086, 0087
Yamishi 0282, 0320
Yokan 0320
Yoko 0161, 0277, 0282, 0320, 0323,
0337, 0340, 0342, 0343, 0349,
0350
Yorx 0340
Zanussi 0282, 0346
Zenith 0008, 0028, 0029, 0030, 0031,
0054, 0061, 0062

VCR

ABS 1016
Adventura 1069
Adyson 1008
Aiwa 1024, 1026, 1027, 1069
Akai 1021, 1027
Akiba 1008, 1029
Akura 1008, 1027, 1029
Alba 1008, 1009, 1024, 1025, 1029,
1030
Alienware 1016
Ambassador 1030
American High 1068
Amstrad 1008, 1009, 1026
Anitech 1008, 1029
Apex 1088
ASA 1028, 1031
Asha 1070
Asuka 1008, 1026, 1028, 1029, 1031
Audio Dynamics 1064
Audiosonic 1009
Audiovox 1071
Baird 1009, 1025, 1026, 1027
Bang & Olufsen 1017
Basic Line 1008, 1009, 1024, 1025, 1029,
1030
Baur 1028

Beaumark 1070
Bell & Howell 1065
Bestar 1009, 1025, 1030
Black Panther Line
1009, 1025
Blaupunkt 1028
Bondstec 1008, 1030
Broksonic 1100
Bush 1008, 1009, 1024, 1025, 1029,
1049, 1051, 1063, 1217
Calix 1071
Candle 1070, 1071
Canon 1068
Cathay 1009
Catron 1030
CGE 1026, 1027
Cimline 1008, 1024, 1029
CineVision 1104
Citizen 1070, 1071
Clatronic 1008, 1030
Colorzyme 1064
Condor 1009, 1025, 1030
Craig 1070, 1071
Crown 1008, 1009, 1025, 1029, 1030
Curtis Mathes 1064, 1068, 1070
Cybernex 1070
CyberPower 1016
Daewoo 1009, 1025, 1030, 1038, 1069,
1223
Dansai 1008, 1009, 1029
Dantax 1024
Daytron 1009, 1025
DBX 1064
De Graaf 1028
Decca 1026, 1027, 1028
Dell 1016
Denko 1008
DiamondVision 1096
DigiFusion 1014
DIRECTV 1019, 1105, 1110, 1111, 1113,
1116, 1122
Dish Network 1018
Dishpro 1018
Dual 1009, 1027, 1028
Dumont 1026, 1028
Durabrand 1114
Dynatech 1069
Echostar 1018
Elbe 1009
Elcotech 1008
Electrohome 1071

Electroponic 1071
Elsay 1008
Elta 1008, 1009, 1029
Emerson 1008, 1020, 1068, 1069, 1071
ESC 1009, 1025
Etzuko 1008, 1029
Expressvu 1018
Ferguson 1027
Fidelity 1008, 1026
Finlandia 1028
Finlux 1026, 1027, 1028
Firstline 1008, 1024, 1029, 1031
Fisher 1065
Flint 1024
Formenti/Phoenix 1028
Frontech 1030
Fuji 1068
Fujitsu 1026
Funai 1026, 1069
Galaxy 1026
Garrard 1069
Gateway 1016
GBC 1029, 1030
GE 1068, 1070
GEC 1028
Geloso 1029
General 1030
General Technic 1024
GOI 1018
GoldHand 1008, 1029
Goldstar 1026, 1031, 1064, 1071
Goodmans 1008, 1009, 1025, 1026, 1029,
1030, 1031
Gradiente 1069
Graetz 1027
Granada 1028
Grandin 1008, 1009, 1025, 1026, 1029,
1030, 1031
Grundig 1028, 1029
Hanseatic 1009, 1028, 1031
Harley Davidson 1069
Harman/Kardon 1064
Harwood 1008
HCM 1008, 1029
Headquarter 1065
Hewlett Packard 1016
Hinari 1008, 1009, 1024, 1029
Hisawa 1024
Hitachi 1011, 1026, 1027, 1028, 1046,
1062
HNS 1110

Howard Computers
1016
HP 1016
HTS 1018
Hughes 1111, 1113, 1122
Hughes Network Systems
1110, 1116
Humax 1012, 1110, 1113
Hush 1016
Hypson 1008, 1009, 1024, 1029
iBUYPOWER 1016
Impego 1030
Imperial 1026
Inno Hit 1008, 1009, 1025, 1028, 1029,
1030
Innovation 1024
Instant Replay 1068
Interbuy 1008, 1031
Interfunk 1028
Intervision 1009, 1026
Irradio 1008, 1029, 1031
ITT 1027
ITV 1009, 1025, 1031
JC Penney 1064, 1065, 1068, 1070, 1071
JCL 1068
JVC 1007, 1018, 1027, 1039, 1064,
1065, 1066, 1067, 1078, 1089,
1092, 1093, 1094, 1095, 1113,
1208, 1209, 1212, 1213, 1215,
1218
Kaisui 1008, 1029
Karcher 1028
Kendo 1008, 1024, 1025, 1030
Kenwood 1027, 1064, 1065
Kodak 1068, 1071
Korpel 1008, 1029
Kyoto 1008
Lenco 1025
Leyco 1008, 1029
LG 1010, 1026, 1031, 1047, 1054,
1056, 1071, 1103, 1221
Lifetec 1024
Linksys 1016
Lloyd's 1069
Loewe Opta 1028, 1031
Logik 1008, 1029
Lumatron 1009, 1025
Luxor 1008
LXI 1071
M Electronic 1026
Magnavox 1020, 1068, 1114, 1126

| | | | | | | | |
|-----------------|------------------------------------------------------------------------|----------------------|------------------------------------------------------------------------------------------------------------------------------------|---------------|------------------------------------------------------------------------------|-------------------|------------------------------------------------------------------------------|
| Magnin | 1071 | Philco | 1008, 1068 | Schaub Lorenz | 1026, 1027 | Teleavia | 1027 |
| Manesth | 1008, 1029 | Philips | 1006, 1013, 1028, 1035, 1040, 1045, 1046, 1050, 1058, 1059, 1061, 1068, 1076, 1101, 1110, 1113, 1116, 1117, 1122, 1126, 1210, 1211 | Schneider | 1008, 1009, 1024, 1025, 1026, 1028, 1029, 1030, 1031 | Telefunken | 1027 |
| Marantz | 1028, 1064, 1065, 1068 | | | Sears | 1065, 1068, 1071 | Teletch | 1008, 1009 |
| Mark | 1009 | | | SEG | 1008, 1009, 1029 | Tenosal | 1008, 1029 |
| Marta | 1071 | | | SEI-Sinudyne | 1028 | Tensai | 1008, 1026, 1029, 1031 |
| Matsui | 1024, 1031 | | | Seleco | 1027 | Tevion | 1024 |
| Matsushita | 1068 | Philips Magnavox | 1076 | Sentra | 1008, 1030 | Thomson | 1005, 1027 |
| Media Center PC | 1016 | Phonola | 1028 | Sentron | 1008, 1029 | Thorn | 1027 |
| Mediator | 1028 | Pilot | 1071 | Sharp | 1003, 1033, 1077, 1107, 1127, 1219 | Tivo | 1108, 1110, 1111, 1113, 1117, 1118, 1119, 1122 |
| Medion | 1024 | Pioneer | 1028, 1036 | Shintom | 1008, 1029 | TMK | 1070 |
| MEI | 1068 | Polaroid | 1088, 1099 | Shivaki | 1031 | Tokai | 1008, 1029, 1031 |
| Memorex | 1023, 1026, 1031, 1065, 1068, 1069, 1070, 1071, 1098, 1114 | Portland | 1009, 1025, 1030 | Shogun | 1070 | Tonsai | 1029 |
| Memphis | 1008, 1029 | Prinz | 1026 | Siemens | 1031 | Toshiba | 1004, 1016, 1027, 1028, 1037, 1049, 1052, 1086, 1087, 1097, 1109, 1112, 1194 |
| MGN Technology | 1070 | Profex | 1029 | Silva | 1031 | Totevision | 1070, 1071 |
| Micromaxx | 1024 | Proline | 1026 | Silver | 1009 | Touch | 1016 |
| Microsoft | 1016 | Proscan | 1019 | Singer | 1068 | Towada | 1008, 1029 |
| Microstar | 1024 | Prosonic | 1009, 1024 | Sinudyne | 1028 | Towika | 1008, 1029 |
| Migros | 1026 | Pulsar | 1114 | Solavox | 1030 | TVA | 1030 |
| Mind | 1016 | Pye | 1028, 1102 | Sonac Blue | 1022, 1123 | Uher | 1031 |
| Mitsubishi | 1026, 1028, 1079 | Quarter | 1065 | Sonneclair | 1008 | UltimateTV | 1019 |
| Motorola | 1068 | Quartz | 1065 | Sonoko | 1009, 1025 | Ultravox | 1009 |
| MTC | 1070 | Quasar | 1068 | Sontec | 1031 | Unitech | 1070 |
| Multitech | 1008, 1026, 1028, 1029, 1030, 1069, 1070 | Quelle | 1026, 1028 | Sony | 1001, 1016, 1048, 1053, 1073, 1074, 1080, 1081, 1082, 1083, 1108, 1118, 1216 | United Quick Star | 1009, 1025 |
| Murphy | 1026 | Radialva | 1008 | Stack | 1016 | Universum | 1026, 1028, 1031 |
| NEC | 1027, 1064, 1065 | RadioShack | 1071 | Stack 9 | 1016 | Vector Research | 1064 |
| Neckermann | 1027, 1028 | RadioShack/Realistic | 1065, 1068, 1069, 1070, 1071 | Standard | 1009, 1025 | Video Concepts | 1064 |
| NEI | 1028 | Radiola | 1028 | Stern | 1009 | Videon | 1024 |
| Nesco | 1008, 1029 | Radix | 1071 | STS | 1068 | Videosonic | 1070 |
| Nikkai | 1008, 1009, 1030 | Randex | 1071 | Sunkai | 1024 | Viewsonic | 1016 |
| Nikko | 1071 | RCA | 1019, 1068, 1070, 1075, 1110, 1113, 1122, 1125 | Sunstar | 1026 | Voodoo | 1016 |
| Niveus Media | 1016 | Realistic | 1065, 1068, 1069, 1070, 1071 | Suntronic | 1026 | Wards | 1068, 1069, 1070, 1071 |
| Noblex | 1070 | ReplayTV | 1022, 1123 | Sunwood | 1008, 1029 | Weltblick | 1031 |
| Nokia | 1009, 1027 | Rex | 1027 | Superscan | 1020 | XR-1000 | 1068, 1069 |
| Nordmende | 1027 | RFT | 1008, 1028, 1030 | Sylvania | 1020, 1068, 1069, 1102, 1126 | Yamaha | 1064, 1065 |
| Northgate | 1016 | Ricavision | 1016 | Symphonic | 1008, 1069, 1126 | Yamishi | 1008, 1029 |
| Oceanic | 1026, 1027 | Roadstar | 1008, 1009, 1025, 1029, 1031 | Systemax | 1016 | Yokan | 1008, 1029 |
| Okano | 1008, 1009, 1024 | Royal | 1008 | Tagar Systems | 1016 | Yoko | 1008, 1029, 1030, 1031 |
| Olympus | 1068 | Runco | 1114 | Taisho | 1024 | Zenith | 1114 |
| Optimus | 1071 | Saba | 1027 | Tandberg | 1009 | ZT Group | 1016 |
| Orion | 1023, 1024, 1051, 1115, 1217 | Saisho | 1024, 1029 | Tandy | 1065 | | |
| Orson | 1026 | Samsung | 1002, 1034, 1041, 1043, 1057, 1060, 1070, 1084, 1110, 1116, 1122, 1124, 1220, 1222 | Tashiko | 1026, 1071 | | |
| Osaki | 1008, 1026, 1029, 1031 | | | Tatung | 1026, 1027, 1028 | DVD | |
| Otto Versand | 1028 | Samurai | 1008, 1030 | TCM | 1015, 1024, 1042 | 4Kus | 2051 |
| Palladium | 1008, 1027, 1029, 1031 | Sanky | 1114 | Teac | 1009, 1069 | Accurian | 2142 |
| Panasonic | 1000, 1022, 1044, 1055, 1068, 1072, 1085, 1090, 1091, 1120, 1121, 1214 | Sansui | 1023, 1027, 1106, 1115 | Tec | 1008, 1009, 1030 | Advent | 2155, 2251 |
| Pathe Marconi | 1027 | Sanyo | 1032, 1065, 1070 | Technics | 1068 | AEG | 2362 |
| Perdio | 1026 | Saville | 1009 | Teknika | 1068, 1069, 1071 | Airis | 2364 |
| | | SBR | 1028 | | | | |

| | | | | | | | |
|-----------------------|-------------------------------|----------------------|-------------------------------|----------------------|-------------------------------|--------------|-------------------------------|
| Aiwa | 2322 | Crown | 2362 | Global Sphere | 2355 | Lawson | 2355 |
| Akai | 2145, 2177, 2179, 2248 | C-Tech | 2355 | Go Video | 2133, 2213 | Lecson | 2381 |
| Akura | 2356 | Curtis Mathes | 2139 | Goodmans | 2165, 2280, 2291, 2358, 2371, | Lenco | 2358, 2362, 2367 |
| Alba | 2064, 2165, 2186, 2337, 2346 | CVG | 2377 | | 2376, 2382 | Lenoxx | 2136, 2153 |
| Alco | 2149 | CyberHome | 2022, 2098, 2138, 2187, 2336 | GPX | 2227 | LG | 2002, 2033, 2038, 2057, 2129, |
| Alize | 2361 | Cytron | 2244 | Gradiente | 2151 | | 2133, 2189, 2191, 2223, 2238, |
| Allegro | 2133 | Daenyx | 2363 | Graetz | 2380 | | 2270, 2288, 2335, 2373, 2375 |
| Amitech | 2362 | Daewoo | 2001, 2133, 2276, 2298, 2330, | Greenhill | 2131 | Life | 2182 |
| Amphion MediaWorks | | | 2362, 2363, 2377 | Grundig | 2349 | Lifetec | 2182 |
| | 2195 | Daewoo International | | Grunkel | 2362, 2366 | Limit | 2355 |
| AMW | 2195, 2363 | | 2363 | GVG | 2377 | Liquid Video | 2158 |
| Apex | 2030, 2124, 2125, 2126, 2127, | Dalton | 2357 | H&B | 2358 | Liteon | 2043, 2051, 2142 |
| | 2130, 2131 | Dansai | 2362, 2381 | H_her | 2364 | Loewe | 2320 |
| Apple | 2241 | Daytek | 2184, 2195, 2363 | Haaz | 2354, 2355 | LogicLab | 2355 |
| Arrgo | 2138 | Dayton | 2363 | Haier | 2254 | Magnavox | 2025, 2050, 2137, 2150, 2159, |
| Asono | 2364 | DEC | 2358 | Harman/Kardon | 2047, 2135 | | 2224, 2230, 2358 |
| Aspire | 2152, 2222 | Decca | 2362 | HiMAX | 2359 | Magnex | 2367 |
| Astar | 2240 | Denon | 2059, 2151, 2193, 2332 | Hitachi | 2062, 2090, 2115, 2274, 2316, | Majestic | 2360 |
| ATACOM | 2364 | Denver | 2356, 2358, 2360, 2370 | | 2359, 2380 | Marantz | 2328 |
| Audiovox | 2061, 2149 | Denzel | 2380 | Hiteker | 2130 | Marquant | 2362 |
| Avious | 2367 | Desay | 2205 | Home Tech Industries | | Matsui | 2148, 2378 |
| Awa | 2363 | Diamond | 2354, 2355 | | 2364 | McIntosh | 2199 |
| Axion | 2249 | DiamondVision | 2225, 2232 | Hyundai | 2366 | Mecotek | 2362 |
| Bang & Olufsen | 2128 | Disney | 2010, 2028 | Ilo | 2245 | Medion | 2182 |
| Baze | 2367 | DK Digital | 2339 | Initial | 2131, 2245 | Memorex | 2028, 2145, 2234 |
| BBK | 2364 | Dmtech | 2176 | Innovation | 2182 | MiCO | 2354, 2382 |
| Bellagio | 2363 | Dual | 2380 | Insignia | 2002, 2137, 2253 | Micromaxx | 2182 |
| Best Buy | 2359 | DUNE | 2473 | Integra | 2157 | Microsoft | 2156 |
| Blaupunkt | 2131 | Durabrand | 2136 | Irradio | 2053 | Microstar | 2182 |
| Blue Parade | 2157 | DVX | 2355 | iSymphony | 2246 | Minoka | 2362 |
| Boghe | 2382 | Easy Home | 2359 | JBL | 2135 | Minowa | 2367 |
| Brainwave | 2362 | Eclipse | 2354 | JVC | 2020, 2096, 2097, 2099, 2100, | Mintek | 2131, 2245 |
| Brandt | 2148, 2188 | E-Dem | 2364 | | 2101, 2102, 2103, 2106, 2107, | Mitsubishi | 2003 |
| Broksonic | 2145, 2146 | Electrohome | 2362 | | 2160, 2257, 2260, 2262, 2263, | Mizuda | 2358, 2359 |
| Bush | 2064, 2110, 2170, 2268, 2290, | Elin | 2362 | | 2321, 2324, 2326, 2327, 2343, | Monyka | 2380 |
| | 2346, 2358, 2367, 2383 | Elta | 2341, 2361, 2362 | | 2464, 2465, 2468, 2469, 2471 | Mustek | 2186 |
| California Audio Labs | | Emerson | 2129, 2137, 2150 | Jwin | 2198 | Mx Onda | 2354 |
| | 2151 | Enterprise | 2129 | Kansai | 2360 | Mystral | 2366 |
| Cambridge Audio | 2354 | Enzer | 2380 | Kawasaki | 2149 | Naiko | 2362 |
| CAT | 2352, 2353 | Epson | 2247 | Kennex | 2362 | Nesa | 2131 |
| CAVS | 2192 | ESA | 2137 | Kenwood | 2041, 2151, 2348 | Neufunk | 2380 |
| Centrum | 2353 | Finlux | 2354, 2362, 2367 | KeyPlug | 2362 | Nevir | 2362 |
| CGV | 2354, 2362 | Fintec | 2377 | Kiuro | 2362 | Next Base | 2143 |
| Changhong | 2140 | Fisher | 2134 | Kingavon | 2358 | Nexxtech | 2243 |
| Cinetec | 2363 | Funai | 2137 | Kiss | 2380 | NU-TEC | 2383 |
| CineVision | 2133, 2237 | Gateway | 2051 | KLH | 2131, 2149 | Onkyo | 2159, 2368 |
| Clatronic | 2358, 2367 | GE | 2029, 2131, 2156 | Koda | 2358 | Oopla | 2051 |
| Coby | 2031, 2046, 2360 | Gericom | 2351 | Koss | 2013, 2148, 2158 | Oppo | 2196, 2255 |
| Conia | 2383 | GFM | 2226 | KXD | 2359 | Optim | 2381 |
| Continental Edison | | Giec | 2382 | Landel | 2143 | Optimus | 2180 |
| | 2363 | Global Solutions | 2355 | Lasonic | 2132 | Orava | 2358 |

| | | | | | | | |
|------------|------------------------------------------------------------------------------------------------------------------------------------------------------------------------------------------------------------------------|-----------------|------------------------------------------------------------------------------------------------------------------------------------------------------------------------------------------------------------------|-----------------|------------------------------------------------------------------------------------------------------------------------------------------|--------|------------------------------|
| Orbit | 2363 | Rotel | 2203 | Sylvania | 2012, 2137, 2150, 2178, 2230, 2239 | Yukai | 2186 |
| Orion | 2073, 2110 | Rowa | 2154, 2383 | | | Zenith | 2002, 2129, 2133, 2159, 2223 |
| Oritron | 2148, 2158 | Rownsonic | 2353 | Symphonic | 2108, 2230 | | |
| P&B | 2358 | Saba | 2148, 2188 | Synn | 2355 | | |
| Pacific | 2355 | Sabaki | 2355 | T.D.E. Systems | 2366 | | |
| Panasonic | 2011, 2024, 2034, 2042, 2058, 2062, 2066, 2067, 2093, 2116, 2117, 2118, 2119, 2120, 2121, 2122, 2123, 2151, 2159, 2164, 2166, 2167, 2172, 2173, 2175, 2209, 2214, 2275, 2277, 2278, 2281, 2282, 2283, 2301, 2374, 2470 | Saivod | 2362 | Tatung | 2001, 2362 | | |
| | | Sampo | 2141 | TCM | 2182, 2297 | | |
| Parasound | 2197 | Samsung | 2000, 2045, 2077, 2112, 2113, 2114, 2115, 2151, 2200, 2216, 2219, 2228, 2264, 2265, 2271, 2279, 2294, 2303, 2329, 2365 | Teac | 2149, 2333, 2355, 2383 | | |
| peeKTON | 2364 | | | Tec | 2356 | | |
| Philips | 2008, 2012, 2025, 2044, 2050, 2051, 2053, 2060, 2072, 2108, 2111, 2147, 2159, 2163, 2169, 2174, 2181, 2185, 2230, 2261, 2266, 2267, 2286, 2287, 2289, 2295, 2300, 2302, 2317, 2328, 2338, 2342, 2350, 2467 | Sansui | 2073, 2145, 2354, 2355, 2362 | Technics | 2151 | | |
| | | Sanyo | 2134, 2145, 2217, 2292 | Technika | 2362, 2367 | | |
| Phonotrend | 2367 | ScanMagic | 2186 | Telefunken | 2353 | | |
| Pioneer | 2016, 2017, 2018, 2019, 2035, 2092, 2094, 2095, 2109, 2157, 2180, 2190, 2212, 2269, 2272, 2299, 2304, 2305, 2306, 2307, 2308, 2309, 2310, 2311, 2344, 2345, 2347, 2379 | Schaub Lorenz | 2362 | Tensai | 2362 | | |
| | | Schneider | 2176 | Tevion | 2182, 2355, 2357 | | |
| Pointer | 2362 | Scientific Labs | 2355 | Theta Digital | 2157 | | |
| Polaroid | 2125, 2215, 2235 | Scott | 2161, 2357 | Thomson | 2183, 2188, 2334, 2372 | | |
| Portland | 2362 | Seeltech | 2364 | Tokai | 2356, 2380 | | |
| Powerpoint | 2363 | SEG | 2161, 2355, 2363, 2380 | Top Suxess | 2364 | | |
| Prima | 2252 | Sharp | 2006, 2040, 2088, 2091, 2182, 2194, 2220, 2221, 2231, 2236, 2293, 2340 | Toshiba | 2032, 2036, 2037, 2039, 2048, 2049, 2054, 2055, 2072, 2073, 2076, 2078, 2079, 2086, 2145, 2159, 2218, 2233, 2256, 2259, 2296, 2369, 2472 | | |
| Proceed | 2130 | Shinsonic | 2245 | TRANScontinents | 2363, 2367 | | |
| Proscan | 2156 | Sigmathek | 2359, 2364 | Transonic | 2367 | | |
| Prosonic | 2360, 2377 | Silva | 2356 | Trio | 2362 | | |
| Protron | 2202 | Singer | 2354, 2355 | Trutech | 2242 | | |
| Provision | 2358 | Skymaster | 2325, 2355 | TruVision | 2359 | | |
| Pye | 2144 | Skyworth | 2356 | TSM | 2364 | | |
| Qwestar | 2148 | Slim Art | 2362 | Umax | 2361 | | |
| Raite | 2380 | SM Electronic | 2355 | United | 2367 | | |
| RCA | 2021, 2029, 2104, 2105, 2131, 2149, 2156, 2157, 2229 | Sonic Blue | 2133 | Urban Concepts | 2159 | | |
| | | Sontech | 2366 | US Logic | 2245 | | |
| RedStar | 2356, 2360, 2362 | Sony | 2004, 2005, 2007, 2009, 2014, 2015, 2023, 2026, 2027, 2052, 2068, 2069, 2070, 2071, 2074, 2075, 2084, 2085, 2087, 2168, 2171, 2208, 2210, 2211, 2258, 2273, 2284, 2285, 2312, 2313, 2314, 2315, 2318, 2319, 2466 | Venturer | 2149 | | |
| Regent | 2153 | Soundmaster | 2355 | Viewmaster | 2364 | | |
| Reoc | 2355 | Soundmax | 2355 | Vocopro | 2206 | | |
| Rimax | 2361 | Spectra | 2363 | VocoStar | 2207 | | |
| Rio | 2133 | Spectroniq | 2201 | Waitec | 2364 | | |
| Roadstar | 2331, 2358 | Standard | 2355 | Welltech | 2382 | | |
| Ronin | 2363 | Star Cluster | 2355 | Westinghouse | 2063, 2250 | | |
| | | Starmedia | 2358, 2364 | Wharfedale | 2354, 2355 | | |
| | | Sungale | 2204 | Woxter | 2361, 2364 | | |
| | | Sunkai | 2362 | Xbox | 2156, 2183 | | |
| | | Superscan | 2150 | Xlogic | 2355, 2362 | | |
| | | Supervision | 2355 | XMS | 2362 | | |
| | | | | Xoro | 2382 | | |
| | | | | Yamada | 2051, 2361, 2363 | | |
| | | | | Yamaha | 2056, 2064, 2065, 2080, 2081, 2082, 2083, 2089, 2118, 2151, 2323 | | |
| | | | | Yamakawa | 2363, 2380 | | |

Blu-ray Disc

| | |
|--------------|------------------------------------------|
| Denon | 2452, 2500, 2501 |
| Hitachi | 2460, 2461, 2463 |
| JVC | 2472, 2473, 2475, 2478, 2496, 2499, 2511 |
| LG | 2033, 2456, 2457 |
| Marantz (US) | 2454, 2455 |
| Mitsubishi | 2450, 2451 |
| Onkyo | 2504 |
| Panasonic | 2011, 2209, 2214, 2476, 2477, 2479 |
| Philips | 2510 |
| Pioneer | 2212, 2506 |
| Samsung | 2045, 2113, 2498 |
| Sharp | 2194, 2220, 2221, 2497, 2502, 2503 |
| Sony | 2075, 2453, 2458, 2459, 2507 |
| Toshiba | 2462 |
| Yamaha | 2064, 2448, 2449, 2474, 2505 |

DVR

| | |
|-----------|------------------------------------------------------|
| Bush | 2110 |
| Hitachi | 2090 |
| Panasonic | 2066, 2067, 2093, 2116, 2117, 2119, 2120, 2122, 2123 |
| Philips | 2108, 2111 |
| Pioneer | 2016, 2017, 2018, 2019, 2092, 2094, 2095, 2109 |
| RCA | 2105 |
| Samsung | 2113, 2219 |
| Sharp | 2088, 2091 |
| Sony | 2084, 2085, 2087 |
| Toshiba | 2086, 2218 |
| Victor | 2475 |
| Yamaha | 2089, 2118 |

DVD Recorder

| | |
|-----------|------|
| Aspire | 2222 |
| Astar | 2240 |
| Broksonic | 2146 |
| Go Video | 2213 |
| Hitachi | 2062 |
| Insignia | 2002 |

| | |
|-----------|------------------------------------------------------------------|
| Irradio | 2053 |
| JVC | 2100, 2101, 2106, 2107 |
| LG | 2033, 2057, 2223, 2238 |
| Liteon | 2043 |
| Panasonic | 2011, 2034, 2058, 2062, 2116, 2117, 2119, 2120, 2121, 2123 |
| Philips | 2008, 2044, 2050, 2051, 2147 |
| Pioneer | 2017, 2035 |
| Pye | 2144 |
| Samsung | 2000, 2112, 2216 |
| Sansui | 2073 |
| Sanyo | 2217 |
| Sony | 2004, 2005, 2007, 2052, 2068, 2069, 2074, 2208, 2210, 2211, 2239 |
| Sylvania | 2239 |
| Toshiba | 2032, 2036, 2037, 2039, 2049, 2054, 2055, 2076 |
| Yamaha | 2056 |

Cable

| | |
|-------------------|------------------------------------------------------|
| ABC | 3002, 3003, 3017, 3066, 3067, 3086, 3093, 3119, 3122 |
| ADB | 3020 |
| Adelphia | 3081 |
| Alcatel | 3016 |
| Americast | 3124 |
| Amstrad | 3022, 3098 |
| Antronix | 3065, 3070 |
| Archer | 3070 |
| Arcon | 3098 |
| AT&T | 3095 |
| Axis | 3098 |
| Bell South | 3124 |
| Cable Vision | 3092 |
| Cableteenna | 3065 |
| Cabletime | 3104 |
| Cableview | 3087 |
| Clearmaster | 3127 |
| ClearMax | 3127 |
| Clyde Cablevision | 3105 |
| Colour Voice | 3068 |
| Comcast | 3084, 3088, 3117 |
| Comcrypt | 3107 |
| Comtronics | 3069 |
| Contec | 3074 |
| Coolmax | 3127 |
| COX | 3084 |
| Cryptovision | 3110 |
| Director | 3084 |

| | |
|--------------------|------------------------------------------------------------|
| Eastern | 3075 |
| Everquest | 3123 |
| Fidelity | 3098 |
| Filmnet | 3107 |
| Filmnet Cablecrypt | 3111 |
| Filmnet Comcrypt | 3111 |
| Finlux | 3097 |
| FIOS | 3004 |
| Focus | 3126 |
| Foxtel | 3022 |
| France Telecom | 3100, 3101 |
| Freebox | 3023 |
| GC Electronics | 3070 |
| GE | 3066, 3093 |
| GEC | 3105 |
| Gemini | 3072, 3123 |
| General Instrument | 3017, 3025, 3066, 3084, 3090, 3096, 3117 |
| Goldstar | 3120 |
| Gooding | 3099 |
| Grundig | 3098, 3099 |
| Hamlin | 3073, 3078 |
| Hirschmann | 3097 |
| Hitachi | 3066 |
| HomeChoice | 3106 |
| Humax | 3021, 3080, 3083 |
| ITT Nokia | 3097 |
| Jasco | 3123 |
| Jerrold | 3017, 3018, 3025, 3066, 3072, 3084, 3090, 3096, 3119, 3123 |
| JVC | 3099 |
| Kabel Deutschland | 3024, 3027, 3121 |
| Macab | 3101 |
| Magnavox | 3079 |
| Maspro | 3099 |
| Matsui | 3099 |
| MegaCable | 3117 |
| Memorex | 3076, 3122 |
| Minerva | 3099 |
| Mnet | 3107 |
| Motorola | 3025, 3026, 3084, 3088, 3090, 3095, 3117 |
| Movie Time | 3077, 3109 |
| Mr Zapp | 3101 |
| Multichoice | 3107 |
| Multitech | 3127 |
| NEC | 3064 |

| | |
|--------------------------|------------------------------------------------------------------------------|
| NET Brazil | 3085 |
| Nokia | 3097 |
| Noos | 3101 |
| NSC | 3077 |
| Oak | 3074 |
| Pace | 3006, 3089, 3121 |
| Palladium | 3099 |
| Panasonic | 3112, 3118, 3122 |
| Paragon | 3122 |
| Philips | 3068, 3071, 3079, 3099, 3100, 3101, 3103 |
| Pioneer | 3001, 3006, 3094, 3098, 3114, 3116, 3120 |
| Popular Mechanics | 3126 |
| Proscan | 3066, 3093 |
| Pulsar | 3122 |
| PVP Stereo Visual Matrix | 3018 |
| Quasar | 3122 |
| RadioShack | 3123, 3127 |
| RCA | 3030, 3031, 3087, 3118 |
| Realistic | 3070 |
| Recoton | 3126 |
| Regal | 3078 |
| Regency | 3075 |
| Rembrandt | 3066 |
| Runco | 3122 |
| Sagem | 3101 |
| Samsung | 3069, 3089, 3114, 3120 |
| SAT | 3098 |
| Scientific Atlanta | 3000, 3001, 3002, 3003, 3006, 3028, 3029, 3081, 3086, 3089, 3094, 3095, 3108 |
| Signal | 3072, 3123 |
| Signature | 3066 |
| Sony | 3092, 3125 |
| Sprucer | 3118 |
| Standard Component | 3115 |
| Starcom | 3017, 3072, 3119, 3123 |
| Stargate | 3072, 3123 |
| Starquest | 3072, 3123 |
| Supercable | 3090 |
| Supermax | 3127 |
| Tele+1 | 3107, 3111 |
| TELENET | 3007 |
| Telepiu | 3107 |
| Thomson | 3082, 3091 |
| TIME WARNER | 3084 |
| Tocom | 3067 |

| | |
|--------------|------------------|
| Torx | 3017 |
| Toshiba | 3122 |
| Tristar | 3127 |
| Tudi | 3102 |
| Tusa | 3072, 3123 |
| TV86 | 3077 |
| Unika | 3065, 3070 |
| United Cable | 3018, 3119 |
| Universal | 3065, 3070 |
| Universum | 3097, 3099 |
| V2 | 3127 |
| Videoway | 3019 |
| View Star | 3074, 3077, 3079 |
| Viewmaster | 3127 |
| Vision | 3127 |
| Visiopass | 3097, 3100, 3101 |
| Vortex View | 3127 |
| Wittenberg | 3098 |
| Zenith | 3113, 3122, 3124 |
| Zentek | 3126 |

Satellite

| | |
|---------------|------------------------------------|
| AB Sat | 4216, 4217 |
| AccessHD | 4104 |
| ADB | 4220 |
| AGS | 4216 |
| Akai | 4053, 4055 |
| Alba | 4001, 4004, 4006, 4007, 4062, 4217 |
| Aldes | 4005, 4007, 4010 |
| Allsat | 4048, 4053, 4055 |
| Allsonic | 4005, 4008, 4024 |
| Alltech | 4217 |
| Alpha | 4053 |
| Alpha Digital | 4104 |
| Alphastar | 4077 |
| Amitronica | 4217 |
| Amstrad | 4011, 4035, 4217, 4218 |
| Anglo | 4217 |
| Ankaro | 4005, 4008, 4024, 4217 |
| Antron | 4001, 4004 |
| Apollo | 4001 |
| Armstrong | 4011, 4053 |
| Artec | 4100 |
| Asat | 4053, 4055 |
| ASLF | 4217 |
| Astacom | 4216 |
| Astra | 4009, 4011, 4054, 4217, 4219 |

| | | | | | | | |
|-------------------|------------------------------------------------|--------------|------------------------------------------------------------------------------------------------------------------------------------------------------------------------------|------------------------|------------------------------------------------|-------------------|------------------------------------------------------|
| Astro | 4004, 4008, 4010, 4015, 4024, 4213, 4218, 4219 | DIRECTV | 4056, 4064, 4067, 4068, 4070, 4071, 4074, 4107, 4116, 4119, 4121, 4122, 4123, 4127, 4192, 4193, 4194, 4195, 4196, 4197, 4198, 4199, 4200, 4201, 4202, 4203, 4206, 4207, 4221 | Fuba | 4001, 4008, 4014, 4015, 4024, 4055, 4215 | JVC | 4029, 4065, 4089, 4117 |
| AudioTon | 4004, 4048 | Discoverer | 4212 | Galaxis | 4005, 4008, 4009, 4024, 4048, 4050, 4215, 4222 | Kamm | 4217 |
| Aurora | 4222 | Discovery | 4216 | GE | 4066, 4093, 4111, 4197 | Kathrein | 4015, 4034, 4042, 4053, 4055, 4063, 4215, 4216, 4217 |
| Austar | 4222 | Diseqc | 4216 | General Instrument | 4019, 4073 | Kathrein Eurostar | 4215 |
| Axiel | 4216 | Dish Network | 4018, 4065, 4089, 4092, 4094, 4095, 4117 | GMI | 4011 | Klap | 4216 |
| Axis | 4008, 4009, 4024, 4050 | Dishpro | 4018, 4117 | GOI | 4117 | Konig | 4219 |
| BBK | 4205 | Distrisat | 4053 | Goldbox | 4213 | Kosmos | 4049 |
| Best | 4008, 4024 | Ditristrad | 4048 | GoldStar | 4049 | KR | 4004 |
| Blaupunkt | 4015 | DNT | 4014, 4053, 4055 | Goodmans | 4002, 4006, 4029 | Kreiselmeier | 4015 |
| Blue Sky | 4217 | Drake | 4072 | Goodmind | 4111 | K-SAT | 4217 |
| Boca | 4011, 4054, 4059, 4217 | DSTv | 4222 | Grandin | 4031 | Kyostar | 4001 |
| Boston | 4216 | Dune | 4024, 4240, 4242 | Grothusen | 4001, 4049 | L&S Electronic | 4024 |
| Brain Wave | 4013 | Echostar | 4014, 4018, 4065, 4089, 4117, 4217 | Grundig | 4004, 4006, 4015, 4035, 4211, 4218, 4222 | Lasat | 4008, 4010, 4024, 4054, 4212, 4215, 4219 |
| Broadcast | 4012 | Einhell | 4001, 4005, 4011, 4217, 4218 | Hänsel & Gretel | 4219 | Lasonic | 4108 |
| Broco | 4217 | Elap | 4216, 4217 | Hantor | 4001, 4013 | Lenco | 4001, 4024, 4049, 4215, 4217, 4219 |
| BSkyB | 4035, 4041 | Elekta | 4010 | Hanuri | 4010 | Leng | 4013 |
| BT | 4216 | Elsat | 4217 | Hauppauge | 4044 | Lennox | 4048 |
| Bubu Sat | 4217 | Elta | 4001, 4008, 4024, 4048, 4053, 4055 | Heliocom | 4219 | Lenson | 4218 |
| Bush | 4006, 4045 | Emanon | 4001 | Helium | 4219 | Lexus | 4053 |
| Cambridge | 4218 | Emme Esse | 4008, 4024 | Hinari | 4007 | LG | 4049, 4103, 4107 |
| Canal Satellite | 4213 | Engel | 4217 | Hirschmann | 4015, 4024, 4210, 4216, 4218, 4219 | Lifesat | 4008, 4024, 4212, 4217 |
| Canal+ | 4213 | Ep Sat | 4006 | Hisawa | 4013 | Lifetec | 4008 |
| CaptiveWorks | 4099 | EURIEULT | 4031 | Hisense | 4016 | Lorenzen | 4219 |
| Channel Master | 4007, 4110 | Eurodec | 4052 | Hitachi | 4006, 4114, 4199, 4203 | Lorraine | 4049 |
| Chaparral | 4075 | Europa | 4053, 4218, 4219 | Homecast | 4084, 4085, 4087 | Lupus | 4008, 4024 |
| CHEROKEE | 4216 | Europhon | 4219 | Houston | 4048 | Luxor | 4218 |
| Chess | 4212, 4217 | Eurosat | 4011 | HTS | 4117 | Lyonnaise | 4052 |
| CityCom | 4006, 4215, 4219 | Eurosky | 4008, 4011, 4215, 4218, 4219, 4024 | Hughes | 4064, 4068, 4192, 4194, 4196, 4202 | Macab | 4052 |
| Clatronic | 4013 | Eurostar | 4011, 4215, 4219 | Hughes Network Systems | 4202 | Magnavox | 4127, 4101 |
| CNT | 4010 | Eutelsat | 4217 | Humax | 4025, 4030, 4060, 4097 | Manata | 4031, 4216, 4217 |
| Comag | 4080, 4081, 4082, 4083, 4086 | Exator | 4001, 4004 | Huth | 4005, 4011, 4012, 4013, 4048, 4050, 4219, 4223 | Manhattan | 4006, 4010, 4048, 4216 |
| Commlink | 4005 | Expressvu | 4117 | Hypson | 4031 | Marantz | 4055 |
| Comtech | 4050 | Fenner | 4024, 4212, 4217 | Ilo | 4016 | Mascom | 4010 |
| Condor | 4008, 4024, 4219 | Ferguson | 4006, 4052, 4214 | Imex | 4031 | Maspro | 4006, 4217 |
| Connexions | 4014, 4024 | Fidelity | 4218 | Innovation | 4008 | Matsui | 4216 |
| Conrad | 4024, 4215, 4218, 4219 | Finlandia | 4006 | Insignia | 4107 | Max | 4219 |
| Conrad Electronic | 4217, 4219 | Finlux | 4006 | Intertronic | 4011 | Mediabox | 4213 |
| Contec | 4050 | FinnSat | 4050, 4052 | Intervision | 4048, 4219 | Mediamarkt | 4011 |
| Coolsat | 4096 | Flair Mate | 4217 | ITT Nokia | 4006 | Mediasat | 4009, 4213, 4218 |
| Cosat | 4048 | Foxtel | 4222 | Jerrold | 4019 | Medion | 4008, 4024, 4217 |
| Cosat | 4048 | Freecom | 4001, 4049, 4218 | Johansson | 4013 | Medison | 4217 |
| Coship | 4109 | FTEmaximal | 4024, 4217 | JOK | 4216 | Mega | 4053, 4055 |
| Crown | 4011 | | | JSR | 4048 | Memorex | 4127 |
| Daeryung | 4014 | | | | | Metronic | 4001, 4004, 4005, 4010, 4028, 4031, 4217 |
| Daewoo | 4057, 4217 | | | | | Metz | 4015 |
| DDC | 4007 | | | | | Micro electronic | 4217, 4218, 4219 |
| Delega | 4007 | | | | | Micro Technology | 4217 |
| Dew | 4050 | | | | | | |
| Diamond | 4051 | | | | | | |
| Digiality | 4219 | | | | | | |
| Digital Stream | 4105 | | | | | | |

| | | | | | | | |
|--------------|------------------------------------------------------------------------------------------------|-------------|------------------------------------------------------------------------|---------------|---------------------------------------------------------------|------------|---------------------------------------------------------------|
| MicroGem | 4106 | Phonotrend | 4006, 4005, 4048 | Seemann | 4009, 4011, 4014 | Televés | 4006, 4218 |
| Micromaxx | 4008, 4024 | Pioneer | 4046, 4213 | SEG | 4001, 4008, 4013, 4024 | Telewire | 4048 |
| Microstar | 4008 | Polsat | 4052 | Seleco | 4048 | Tempo | 4223 |
| Microtec | 4217 | Predki | 4013 | Servi Sat | 4031, 4217 | Tevion | 4008, 4217 |
| Minerva | 4015 | Premiere | 4048, 4213 | Siemens | 4015 | Thomson | 4006, 4020, 4052, 4058, 4208, 4213, 4215, 4216, 4217, 4219 |
| Mitsubishi | 4006, 4015, 4202 | Priesner | 4011 | Silva | 4049 | Thorens | 4051 |
| Mitsumi | 4054 | Primestar | 4076 | Skantin | 4217 | Thorn | 4006 |
| Morgan's | 4011, 4053, 4054, 4055, 4217 | Profile | 4216 | Skardin | 4009 | Tivax | 4104 |
| Motorola | 4019, 4088, 4090, 4091 | Promax | 4006 | Skinsat | 4218 | Tivo | 4196 |
| Multichoice | 4222 | Prosat | 4005, 4007 | SKR | 4217 | Tokai | 4053 |
| Multitec | 4212 | Proscan | 4066, 4093, 4122, 4197 | Skymaster | 4005, 4017, 4022, 4212, 4217 | Tonna | 4006, 4012, 4048, 4217, 4218 |
| Muratto | 4049 | Protek | 4051 | Skymax | 4053, 4055 | Toshiba | 4194, 4202, 4203 |
| Mysat | 4217 | Proton | 4016 | SkySat | 4212, 4217, 4218, 4219 | Triad | 4049 |
| Navax | 4013 | Provision | 4010 | Skyvision | 4048 | Triasat | 4218 |
| Neuhaus | 4009, 4048, 4217, 4218, 4219 | Quadral | 4005, 4007, 4008, 4216, 4024 | SM Electronic | 4212, 4217 | Triax | 4015, 4215, 4217, 4218 |
| Neusat | 4217 | Quelle | 4015, 4215, 4219 | Smart | 4215, 4217 | Turnsat | 4217 |
| Next Level | 4019 | Quiero | 4052 | Sony | 4067, 4070, 4213 | Tvonic | 4214 |
| NextWave | 4223 | RadioShack | 4019 | SR | 4011, 4054 | Twiner | 4031, 4217 |
| Nikko | 4011, 4217 | Radiola | 4053, 4055 | Star Choice | 4019 | UEC | 4222 |
| Nokia | 4006, 4040 | Radix | 4014, 4037 | Starland | 4217 | Uher | 4212 |
| Nordmende | 4001, 4006, 4007, 4010, 4052 | Rainbow | 4004 | Starring | 4013 | UltimateTV | 4070 |
| Nova | 4222 | RCA | 4066, 4093, 4112, 4113, 4116, 4118, 4119, 4197, 4122, 4207 | Start Trak | 4001 | Uniden | 4079, 4127 |
| Novis | 4013 | Realistic | 4078 | Strong | 4001, 4004, 4008, 4024, 4049, 4222 | Unisat | 4011, 4050, 4053 |
| Oceanic | 4051 | Redpoint | 4009 | STS | 4115 | Unitor | 4013 |
| Octagon | 4001, 4004, 4050 | Redstar | 4008, 4024 | STVI | 4031 | Universum | 4015, 4215, 4219 |
| Okano | 4011 | RFT | 4005, 4053, 4055 | Sumida | 4011 | US Digital | 4016 |
| Optex | 4048 | Roadstar | 4217 | Sunny Sound | 4024 | Variosat | 4015 |
| Optus | 4213, 4222, 4223 | Roch | 4031 | Sunsat | 4217 | Vega | 4024 |
| Orbitech | 4001, 4212, 4213, 4218 | Rover | 4024, 4217 | Sunstar | 4011, 4024, 4054 | Ventana | 4053, 4055 |
| OSat | 4004 | Saba | 4010, 4215, 4216, 4219 | Supermax | 4223 | Viewsat | 4098 |
| Otto Versand | 4015 | Sabre | 4006 | Tandberg | 4052 | Visiosat | 4013, 4048, 4216, 4217 |
| Pace | 4006, 4015, 4035, 4043, 4047, 4204, 4216, 4243 | Sagem | 4023, 4052 | Tandy | 4004 | Voom | 4019 |
| Pacific | 4051 | Sakura | 4050 | Tantec | 4006 | Vortec | 4001 |
| Packsat | 4216 | Samsung | 4000, 4001, 4003, 4032, 4064, 4069, 4071, 4120, 4123, 4196, 4200 | TCM | 4008 | Welltech | 4212 |
| Palcom | 4007 | SAT | 4007, 4218 | Techniland | 4012 | WeTeKom | 4212, 4218 |
| Palladium | 4011, 4218 | Sat Cruiser | 4223 | TechniSat | 4014, 4021, 4026, 4027, 4038, 4039, 4053, 4212, 4213, 4218 | Wevasat | 4006 |
| Palsat | 4212, 4218 | Sat Partner | 4001, 4004, 4010, 4013, 4049, 4218 | Technology | 4222 | Wewa | 4006 |
| Panasat | 4222 | Sat Team | 4217 | Technosat | 4223 | Winersat | 4013 |
| Panasonic | 4006, 4035, 4036, 4121, 4124, 4126, 4198, 4221 | Satcom | 4012, 4219 | Technowelt | 4219 | Wisi | 4006, 4014, 4015, 4218, 4219 |
| Panda | 4006, 4219 | Satec | 4217 | Teco | 4011, 4054 | Woorisat | 4010 |
| Pansat | 4125 | Satelco | 4024 | Telanor | 4007 | Worldsat | 4216 |
| Patriot | 4216 | Satford | 4012 | Telasat | 4215, 4219 | Xrypton | 4024 |
| Paysat | 4127 | Satmaster | 4012 | Telecom | 4217 | XSat | 4217 |
| PCT | 4110 | Satplus | 4212 | Telefunken | 4001, 4017, 4216 | Zehnder | 4008, 4209, 4010, 4215, 4024 |
| Philco | 4101 | Schneider | 4008, 4212, 4216 | Teleka | 4004, 4011, 4014, 4218, 4219 | Zenith | 4102, 4107, 4195 |
| Philips | 4006, 4033, 4053, 4055, 4061, 4068, 4071, 4127, 4196, 4201, 4202, 4203, 4206, 4213, 4216 | Schwaiger | 4051, 4212, 4219 | Telemaster | 4010 | Zodiac | 4004 |
| Phoenix | 4050 | SCS | 4215 | TELENET | 4241 | | |
| | | | | Telesat | 4219 | | |
| | | | | Telestar | 4212, 4213, 4218 | | |

CD

Yamaha 5082, 5095

CD Recorder

Yamaha 5083

MD

Yamaha 5080, 5081, 5086

Tape

Yamaha 5084, 5087

Tuner

Yamaha 5066, 5085, 5088, 5090, 5092

LD

Yamaha 2080

Amplifier

Yamaha 5019, 5020, 5098

Apple TV

Apple 2241

“Apple TV” is a trademark or registered mark of Apple Inc.