



DESKTOP AUDIO SYSTEM

TSX-B141

OWNER'S MANUAL



ABL

CAUTION: READ THIS BEFORE OPERATING YOUR UNIT.

- 1 To assure the finest performance, please read this manual carefully. Keep it in a safe place for future reference.
- 2 Install this unit in a well ventilated, cool, dry, clean place – away from direct sunlight, heat sources, vibration, dust, moisture and cold. For proper ventilation, allow the following minimum clearances.
Top: 15 cm (6 in)
Rear: 10 cm (4 in)
Sides: 10 cm (4 in)
- 3 Locate this unit away from other electrical appliances, motors, or transformers to avoid humming sounds.
- 4 Do not expose this unit to sudden temperature changes from cold to hot (or vice versa), and do not locate this unit in an environment with high humidity (i.e., a room with a humidifier) to prevent condensation inside this unit, which may cause an electrical shock, fire, damage to this unit, and/or personal injury.
- 5 Avoid installing this unit where foreign object may fall onto this unit and/or this unit may be exposed to liquid dripping or splashing. On the top of this unit, do not place:
 - Other components, as they may cause damage and/or discoloration on the surface of this unit.
 - Burning objects (i.e., candles), as they may cause fire, damage to this unit, and/or personal injury.
 - Containers with liquid in them, as they may fall and liquid may cause electrical shock to the user and/or damage to this unit.
- 6 Do not cover this unit with a newspaper, tablecloth, curtain, etc. in order not to obstruct heat radiation. If the temperature inside this unit rises, it may cause fire, damage to this unit, and/or personal injury.
- 7 Do not plug in this unit to a wall outlet until all connections are complete.
- 8 Do not operate this unit upside-down. It may overheat, possibly causing damage.
- 9 Do not use force on switches, knobs and/or cords.
- 10 When disconnecting the power cable from the wall outlet, grasp the plug; do not pull the cable.
- 11 Do not clean this unit with chemical solvents; this might damage the finish. Use a clean, dry cloth.
- 12 Only voltage specified on this unit must be used. Using this unit with a higher voltage than specified is dangerous and may cause fire, damage to this unit, and/or personal injury. Yamaha will not be held responsible for any damage resulting from use of this unit with a voltage other than specified.
- 13 To prevent damage by lightning, keep the power cable and outdoor antennas disconnected from a wall outlet or this unit during a lightning storm.
- 14 Do not attempt to modify or fix this unit. Contact qualified Yamaha service personnel when any service is needed. The cabinet should never be opened for any reasons.
- 15 When not planning to use this unit for long periods of time (i.e., vacation), disconnect the AC power plug from the wall outlet.
- 16 Be sure to read the “TROUBLESHOOTING” section on common operating errors before concluding that this unit is faulty.
- 17 Before moving this unit, press  to set the unit to off, and disconnect the AC power plug from the wall outlet.
- 18 Condensation will form when the surrounding temperature changes suddenly. Disconnect the power cable from the outlet, then leave this unit alone.
- 19 When using this unit for a long time, this unit may become warm. Turn the unit off, then leave this unit alone for cooling.
- 20 Install this unit near the wall outlet and where the AC power plug can be reached easily.
- 21 The batteries shall not be exposed to excessive heat such as sunshine, fire or the like.
 - Keep the batteries in a location out of reach of children. Batteries can be dangerous if a child were to put in his or her mouth.
 - If the batteries grow old, the effective operation range of the remote control decreases considerably. If this happens, replace the batteries with two new ones as soon as possible.
 - Do not use old batteries together with new ones.
 - Do not use different types of batteries (such as alkaline and manganese batteries) together. Read the packaging carefully as these different types of batteries may have the same shape and color.
 - Exhausted batteries may leak. If the batteries have leaked, dispose of them immediately. Avoid touching the leaked material or letting it come into contact with clothing, etc. Clean the battery compartment thoroughly before installing new batteries.
 - If you plan not to use the unit for a long period of time, remove the batteries from the unit. Otherwise, the batteries will wear out, possibly resulting in a leakage of battery liquid that may damage the unit.
 - Do not throw away batteries with general house waste. Dispose of them correctly in accordance with your local regulations.
- 22 Be sure to use the AC adaptor supplied with this unit. Using an AC adaptor other than the one provided may cause fire or damage to this unit.
- 23 Excessive sound pressure from earphones and headphones can cause hearing loss.

This unit is not disconnected from the AC power source as long as it is connected to the wall outlet, even if this unit itself is turned off by . In this state, this unit is designed to consume a very small quantity of power.

WARNING

TO REDUCE THE RISK OF FIRE OR ELECTRIC SHOCK, DO NOT EXPOSE THIS UNIT TO RAIN OR MOISTURE.

CAUTION

Danger of explosion if battery is incorrectly replaced. Replace only with the same or equivalent type.

- This unit's speakers use magnets. Do not place items that are sensitive to magnetism, such as CRT-type TVs, clocks, credit cards, floppy disks, etc., on or beside this unit.
- There is a chance that placing this unit too close to a CRT-based (Braun tube) TV set might impair picture color. Should this happen, move this unit away from the TV set.

Bluetooth

- *Bluetooth* is a technology for wireless communication between devices within an area of about 10 meters (33 ft) employing the 2.4 GHz frequency band, a band which can be used without a license.
- *Bluetooth* is a registered trademark of the *Bluetooth* SIG and is used by Yamaha in accordance with a license agreement.

Handling Bluetooth communications

- The 2.4 GHz band used by *Bluetooth* compatible devices is a radio band shared by many types of equipment. While *Bluetooth* compatible devices use a technology minimizing the influence of other components using the same radio band, such influence may reduce the speed or distance of communications and in some cases interrupt communications.
- The speed of signal transfer and the distance at which communication is possible differs according to the distance between the communicating devices, the presence of obstacles, radio wave conditions and the type of equipment.
- Yamaha does not guarantee all wireless connections between this unit and devices compatible with *Bluetooth* function.

LASER SAFETY

This unit employs a laser. Due to possible eye injury, only a qualified service person should remove the cover or attempt to service this device.

DANGER

This unit emits visible laser radiation when open. Avoid direct eye exposure to beam. When this unit is plugged into the wall outlet, do not look inside the unit through the disc slot and other openings.

The laser component in this product is capable of emitting radiation exceeding the limit for Class 1.

◆ For U.K. customers

If the socket outlets in the home are not suitable for the plug supplied with this appliance, it should be cut off and an appropriate 3 pin plug fitted. For details, refer to the instructions described below.

The plug severed from the mains lead must be destroyed, as a plug with bared flexible cord is hazardous if engaged in a live socket outlet.

◆ Special Instructions for U.K. Model**IMPORTANT**

THE WIRES IN MAINS LEAD ARE COLOURED IN ACCORDANCE WITH THE FOLLOWING CODE:

Blue: NEUTRAL

Brown: LIVE

As the colours of the wires in the mains lead of this apparatus may not correspond with the coloured markings identifying the terminals in your plug, proceed as follows:

The wire which is coloured BLUE must be connected to the terminal which is marked with the letter N or coloured BLACK. The wire which is coloured BROWN must be connected to the terminal which is marked with the letter L or coloured RED.

Make sure that neither core is connected to the earth terminal of the three pin plug.

We, Yamaha Music Europe GmbH hereby declare that this unit is in compliance with the essential requirements and other relevant provisions of Directive 1999/5/EC.

Yamaha Music Europe GmbH

Siemensstr. 22-34 25462 Rellingen,

Germany

Tel: +49-4101-303-0

**CAUTION**

Use of controls or adjustments or performance of procedures other than those specified herein may result in hazardous radiation exposure.

Information for Users on Collection and Disposal of Old Equipment and Used Batteries



These symbols on the products, packaging, and/or accompanying documents mean that used electrical and electronic products and batteries should not be mixed with general household waste.



For proper treatment, recovery and recycling of old products and used batteries, please take them to applicable collection points, in accordance with your national legislation and the Directives 2002/96/EC and 2006/66/EC.



Pb

By disposing of these products and batteries correctly, you will help to save valuable resources and prevent any potential negative effects on human health and the environment which could otherwise arise from inappropriate waste handling.

For more information about collection and recycling of old products and batteries, please contact your local municipality, your waste disposal service or the point of sale where you purchased the items.

[Information on Disposal in other Countries outside the European Union]

These symbols are only valid in the European Union. If you wish to discard these items, please contact your local authorities or dealer and ask for the correct method of disposal.

Note for the battery symbol (bottom two symbol examples):

This symbol might be used in combination with a chemical symbol. In this case it complies with the requirement set by the Directive for the chemical involved.

If there should be color blotching or noise when used near a TV, move this unit away from the TV when using it.

Do not use this unit within 22 cm (9 inches) of persons with a heart pacemaker implant or defibrillator implant.

Radio waves may affect electro-medical devices. Do not use this unit near medical devices or inside medical facilities.

The user shall not reverse engineer, decompile, alter, translate or disassemble the software used in this unit, whether in part or in whole. For corporate users, employees of the corporation itself as well as its business partners shall observe the contractual bans stipulated within this clause. If the stipulations of this clause and this contract cannot be observed, the user shall immediately discontinue using the software.

- The name plate is located on the bottom of the unit.

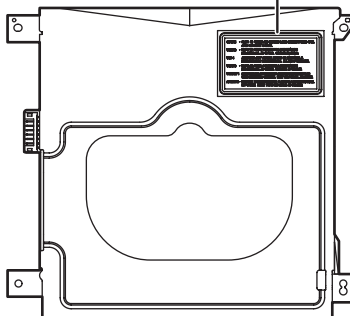
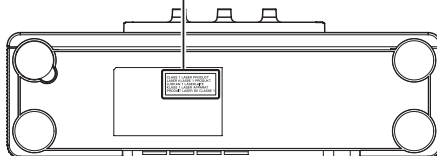

FEATURES

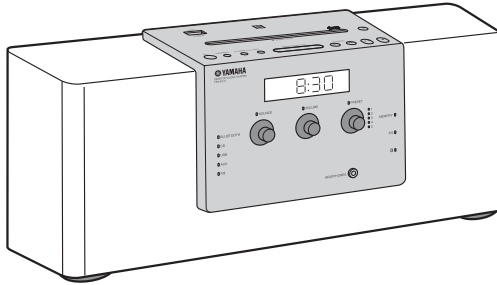

Various music sources that emphasize sound quality

- Play back music on external devices such as audio/data CDs, USB devices (USB flash drives), and those connected via AUX, and tune in to the radio.
- By the *Bluetooth* technology, you can enjoy clear sound without wired connections (☞ P. 11).
- The 3-band equalizer (bass, middle, treble) can be set so that music sounds exactly how you want it (☞ P. 15).

Convenient functions with enhanced usability

- One touch pairing (☞ P. 12).
- Storing/calling your five favorite radio stations easily.
- Charging smartphones, tablets, etc., via the USB port on the top panel.

Start your days with your favorite music (IntelliAlarm)

Use your favorite music or set of beeps as an alarm. The music you select is played at a volume of your own choice at the set alarm time, giving you the best possible start to the day (☞ P. 16).

Easy operations using a dedicated application

By using the free application, "DTA CONTROLLER," you can operate the unit on the application or use various alarm features (☞ P. 2).

Supplied accessories

Remote control

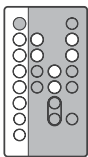

(With CR2025 battery)

Power cable

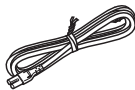

AC adaptor

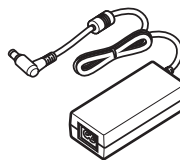

(DC 15 V, more than 2.56 A
Model number:
EADP-38EB A)

FM antenna



USB cap



Note

Keep the USB cap out of reach of children so as to ensure that it is not mistakenly swallowed.

CONTENTS

GETTING STARTED

INSTALLING “DTA CONTROLLER”	2
NAMES OF PARTS AND THEIR FUNCTIONS	3
ADJUSTING THE CLOCK	7

PLAYING MUSIC

LISTENING TO CD AND USB DEVICE	8
LISTENING TO MUSIC FROM YOUR <i>Bluetooth</i> DEVICE	11
LISTENING TO RADIO STATIONS	14
LISTENING TO EXTERNAL SOURCE	15
TONE CONTROL	15

OTHER FUNCTIONS AND INFORMATION

USING ALARM FUNCTION	16
USING THE SLEEP TIMER	21
ADJUSTING BRIGHTNESS OF FRONT PANEL DISPLAY	21
TROUBLESHOOTING	22
NOTES ON DISCS AND USB DEVICES	26
SPECIFICATIONS	27

◆ About this manual

- If both the unit and remote control buttons can be used to operate a feature, the manual will describe steps using the buttons on the unit.
- **Note** indicates supplementary explanations for better use.
-  indicates precautions for use of the unit and its feature limitations.

INSTALLING “DTA CONTROLLER”

Installing the DTA CONTROLLER application on a mobile device, such as a smartphone, iPhone, or tablet computer, allows you to use a variety of additional convenient features of this unit.

Features

- Changing the source
- Controlling the volume and tone
- Setting of the alarm function (IntelliAlarm) (P. 19)
- Playing back songs stored in a smartphone/iPhone/tablet computer.



The mobile device needs to be connected with the unit via *Bluetooth* connection (P. 11).

Due to product improvements, specifications and appearance are subject to change without notice.



Google Play™



<http://itunes.com/app/dtacontroller>



<https://play.google.com/store/apps/details?id=com.yamaha.av.dtacontroller>

Note

If you cannot access the above information, search for “DTA CONTROLLER” on App Store or Google Play.

NAMES OF PARTS AND THEIR FUNCTIONS

Remote control

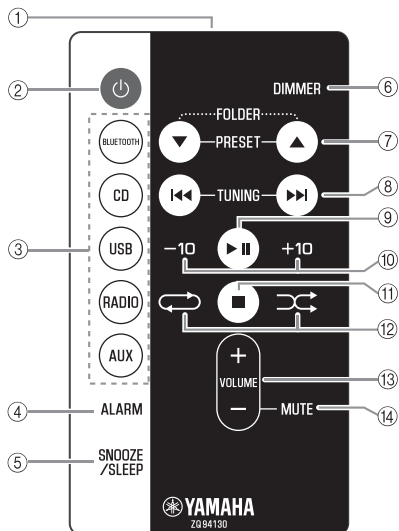

- ① **Infrared signal transmitter**
- ② **⏻ (Power)**
Press to turn on the system or enter standby mode.
- ③ **Source buttons**
Changes sources.
- ④ **ALARM**
Turns on/off the alarm.
- ⑤ **SNOOZE/SLEEP**
Sets snooze/sleep (☞ P. 18, 21).

- ⑥ **DIMMER**
Adjusts the brightness of the front panel display (☞ P. 21).
- ⑦ **▲/▼**
 - **PRESET**
Selects the preset radio station when using the radio.
 - **FOLDER**
Switches the playback folder during playback of CDs or USB devices.
- ⑧ **⏮/⏭**
During playback: Skips the playback track/file. Holding the button down while playing a track/file will search backward/forward the track/file (☞ P. 8).
During receiving radio: Tunes radio (☞ P. 14).
- ⑨ **⏸**
Play/pause.
- ⑩ **+10/-10**
Skips 10 tracks.
- ⑪ **■**
Stops playback.
- ⑫ **⏮ (Repeat)/⏭ (Shuffle)**
Plays music on an audio/data CD or USB device in repeat/shuffle (☞ P. 10).
- ⑬ **VOLUME +/-**
Controls volume.
- ⑭ **MUTE**
Mutes/resumes the sound.

Using the remote control

Point the remote control at the remote control signal receiver (on the front panel) and use within the range shown below.

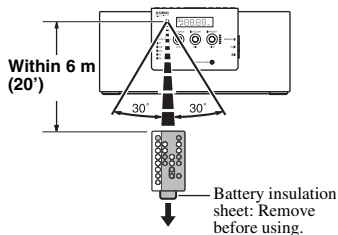

Replacing the remote control battery

While pushing the release tab in direction (A), slide out the battery holder in direction (B).

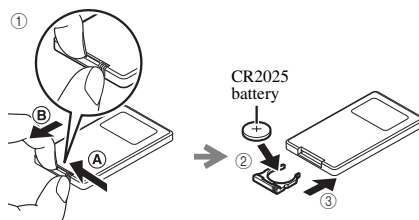

Top panel

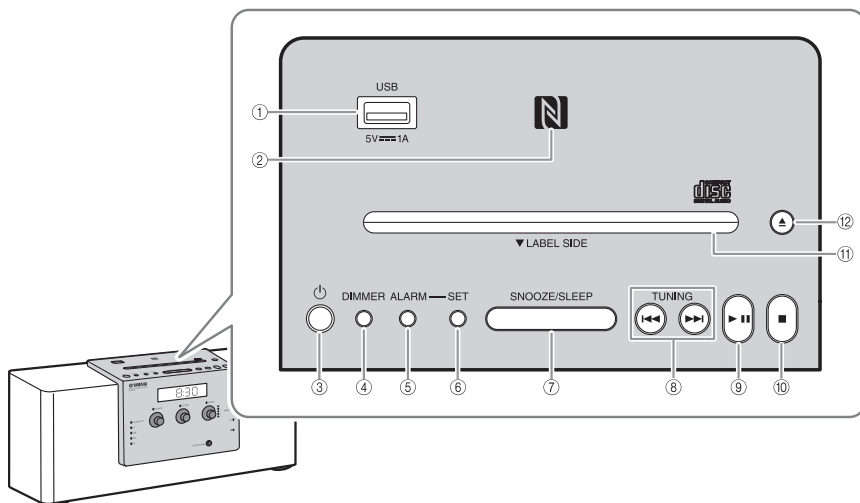

① **USB port**

- Connect a USB device for playback (☞ P. 9).
- Supplies 5 V/1 A to a portable device, such as a smartphone, when it is connected with a USB cable (☞ P. 10).

② **NFC mark**

Allows easy pairing with NFC technology (☞ P. 12).

③ **Power**

Press to turn on the unit or enter standby mode. Time is displayed on the front panel even when the unit is in standby mode.



- Press and hold **Power** on the unit for more than 3 seconds to set the unit to Eco Standby mode. No information on the front panel is displayed in this mode. This can reduce power consumption. To cancel Eco Standby mode, press **Power** again.
- Even in standby mode or Eco Standby mode, the alarm function is available.

④ **DIMMER**

Sets brightness of the front panel display (☞ P. 21).

A (auto) → 3 (brightest) → 2 → 1 (darkest) → back to A



When A (auto) is set, the brightness of the front panel display is adjusted automatically depending on the brightness of the room.

⑤ **ALARM**

Turns the alarm on/off (☞ P. 18).

⑥ **SET**

Use to configure the alarm setting (☞ P. 17, 20).

⑦ **SNOOZE/SLEEP**

Sets the sleep timer or switches the alarm to snooze mode (☞ P. 18, 21).

⑧ **TUNING (◀▶)**

Skips the playback track/file, or tunes the radio. Holding the button down while playing a track/file will search backward/forward the track/file (☞ P. 8, 14).

⑨ **▶||**

Plays/pauses the track being played (☞ P. 8).

⑩ **■**

Stops playback.

⑪ **Disc slot**

Insert a CD (☞ P. 8).

⑫ **▲**

Ejects the CD (☞ P. 8).

Front panel

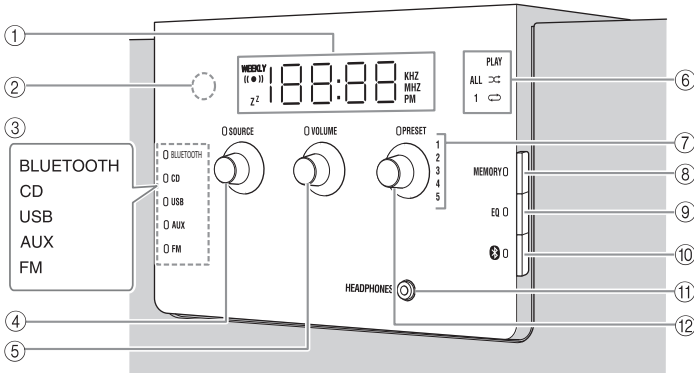

① **Front panel display**

Displays the clock and various information.

② **Illumination sensor**

Measures surrounding illuminance. Do not cover this sensor.

③ **Source indicator**

Shows the selected source.

④ **SOURCE**

Changes sources.

⑤ **VOLUME**

Controls volume.

⑥ **PLAY indicator**

Shuffle indicator

Repeat indicator

Shows playback status (☞ P. 9).

⑦ **Preset indicator**

Shows preset radio station number (☞ P. 14).

⑧ **MEMORY**

Memorizes radio stations (☞ P. 14).

⑨ **EQ**

Controls tone (☞ P. 15).

⑩ **Bluetooth**

Connect/disconnect *Bluetooth* devices (☞ P. 13).

⑪ **HEADPHONES**

Connect headphones.

⑫ **PRESET**

- During playing data CD/USB: Changes folders (☞ P. 9).
- During receiving radios: Selects the preset radio station (☞ P. 14).

◆ Auto Standby

- With the Auto Standby function, the unit behaves as described below when the unit is turned on (default setting):
 - This unit enters standby mode when playback of CD/USB is paused, when no signal is input from the tuner or a connected device, or when playback continues at quite a low volume for a certain period of time (about 20 minutes).
 - This unit enters standby mode when no operation is performed for more than 8 hours.
- Activating/Deactivating Auto Standby
 - 1 Plug in the unit while pressing and holding**
 - 2 Keep holding** .

The Auto Standby status changes, the , **TUNING**, **SOURCE**, **VOLUME**, and **PRESET** LEDs blink, and the message is displayed on the front panel display.

 - When activating Auto Standby: On
 - When deactivating Auto Standby: Off

Rear panel

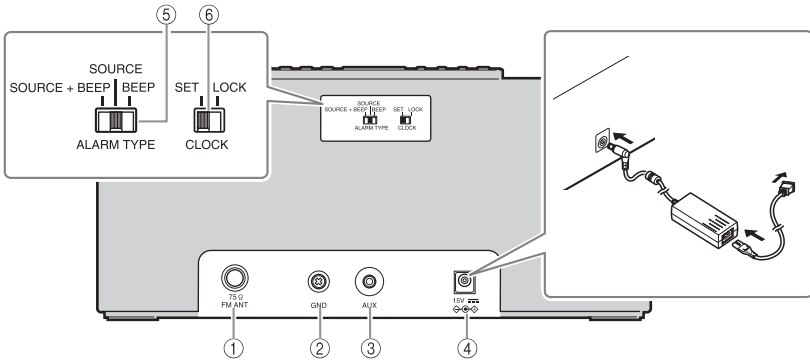

① **FM antenna terminal**

Connect the supplied FM antenna.

② **GND**

Connect the cable core of the FM antenna (see below).

③ **AUX**

Connect an external device (P. 15).

④ **15V**

Connect the supplied AC adaptor and power cable.

⑤ **ALARM TYPE**

Sets the alarm type of the IntelliAlarm function (P. 17).

⑥ **CLOCK**

Adjusts the clock (P. 7).

Connecting the FM antenna

It is recommended to connect the FM antenna to the GND terminal before connecting to the FM antenna terminal.

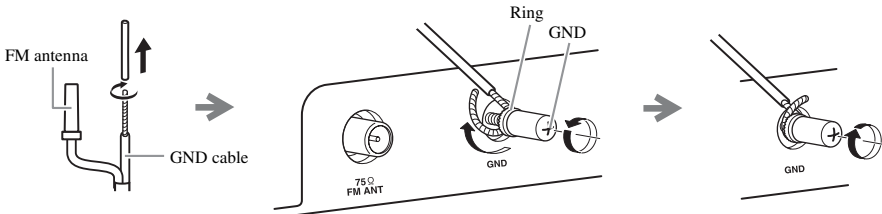

① Remove insulation and twist the edge of the cord.

② Fully unscrew the GND terminal, then wind the cord inside the ring part of the GND terminal.

③ Tighten the GND terminal taking care not to slip the cord off from the terminal.

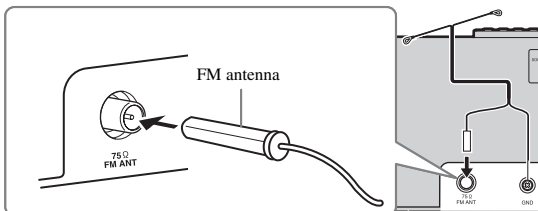

④ Connect the supplied FM antenna to the unit.

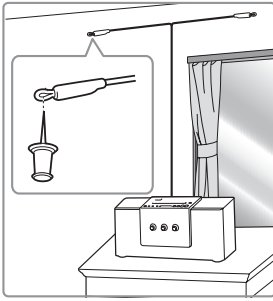

- 5 Pin the antenna where the best reception is obtained.

Note

- The antenna should be stretched out.
- If you use an outdoor antenna instead of the supplied antenna, reception will be better.
- If radio reception is poor, change the height, direction, or placement of the antenna.
- If you listen to an FM radio station while USB charging, noise may interfere with the radio reception. In this case, disconnect the USB cable from the unit.

ADJUSTING THE CLOCK

Rear panel

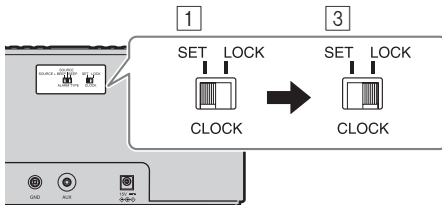

Front panel

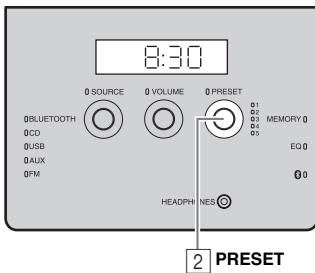

- 1 Set **CLOCK** to **SET**.

- 2 Set the time.
Set the time with **PRESET**.



- Press **SNOOZE/SLEEP** in step 2 to switch between the 12 and 24 hour clock display.
- The “PM” indicator will be shown only when you select the 12 hour clock display.

- 3 Set **CLOCK** to **LOCK** to complete.
At the time **LOCK** is set, it will be 00 second and time count starts.

Note

The time settings are lost about one week after unplugging the unit.

LISTENING TO CD AND USB DEVICE

The unit will operate as follows when playing back tracks/files on CD/USB devices.

- If the CD/USB device being played back is stopped, the track that was being played back will start playing from the beginning of the track the next time playback begins.
- If you press ■ on the remote control while playback is stopped, the next time playback begins, the unit will play tracks as follows:
 - For audio CD: from the first track of the CD.
 - For data CD/USB device: from the first track of the folder that contains the track that was played last.
- When Auto Standby is activated, this unit enters standby mode automatically if no operation is performed for 20 minutes after CD/USB device playback is stopped.



For details on playable discs and files, refer to “NOTES ON DISCS AND USB DEVICES” (P. 26).

Use the following buttons to control the unit while playing back tracks on CD/USB devices.

Button	Function	
Top panel/ Remote control	▶	Play/Pause
	⏮/⏭	Skip Search backward/forward (press and hold down)
	■	Stop
Top panel	▲	Eject the CD

Button	Function	
Remote control	↺	Repeat playback (P. 3)
	↻	Shuffle playback (P. 3)
	+10/-10	Skip 10 tracks/files
	▲/▼	Change folders to play (only for data CDs or USB devices)

◆ Listening to CD

Top/front panel

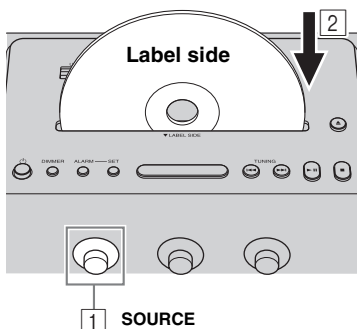

1 Set **SOURCE** to CD.

2 Insert the CD into the disc slot with the label side facing toward the front of the unit.

Playback starts automatically. Playback operations are available with the remote control or this unit.

Note

- Insert the CD with the label side facing toward the front of the unit.
- CDs cannot be inserted or ejected when the system is in Eco Standby mode (P. 4).

◆ Listening to USB device

Top/front panel

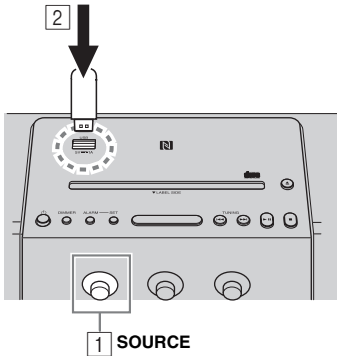

1 Set **SOURCE** to **USB**.

2 Connect a **USB device**.

Playback starts automatically. Playback operations are available with the remote control or this unit.



Stop playback before disconnecting the USB device.

◆ Display information

Front panel

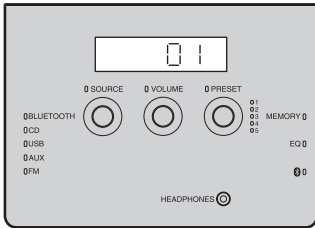

Skip folders to select the desired one with **PRESET** while the data CD/USB device is played back.

Track or folder and file numbers appear for a while when playback starts.

Playing back audio CD



Track number

Playing back data CD/USB device

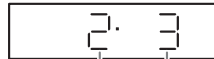

Folder number

File number

Repeat/shuffle playback

The playback mode can be checked with the play/shuffle/repeat indicator on the front panel display.

Remote control

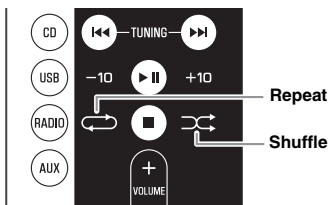

If the selected source contains folders, the playback mode of repeat/shuffle can also be set by folder.

◆ Repeat playback

Press (Repeat) on the remote control to select a playback mode from the following.

- : 1 track
- : All tracks within the folder (data CD/USB device only)
- : All tracks

No display: Repeat mode off

◆ Shuffle playback

Press (Shuffle) on the remote control to select a playback mode from the following.

- : All tracks within the folder (data CD/USB device only)
- : All tracks

No display: Shuffle mode off

◆ Notes about power supply via the USB port

Supplies 5 V/1 A to a portable device, such as a smartphone, when it is connected with a USB cable.

Top panel

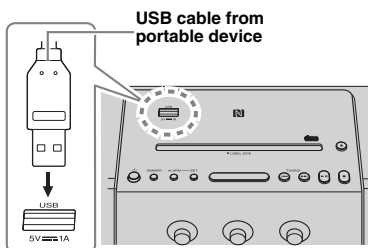

Note

- Charging may not be possible depending on the portable device.
- This unit does not support iPad charging.
- The power is supplied while the unit is turned on (no matter what source is selected), even in standby mode.
- Yamaha will not be held responsible for any damage to the portable device or data loss occurred while using this unit.
- Disconnect the USB cable immediately after charging completes, since power continues to be supplied to the connected device.

LISTENING TO MUSIC FROM YOUR *Bluetooth* DEVICE

This unit provides *Bluetooth* functionality. You can enjoy wireless music playback from your *Bluetooth* device (smartphone, digital audio player, etc.). Please also refer to the owner's manual of your *Bluetooth* device.

Pairing this unit with your *Bluetooth* device

Pairing is an operation that registers the communicating device (hereafter called “the connecting device”) with this unit. You'll need to perform the pairing operation the first time you use your *Bluetooth* device with this unit, or if the pairing settings have been deleted. Once pairing has been completed, subsequent reconnection will be easy even after the *Bluetooth* connection is disconnected. If pairing is not successful, refer to the item “*Bluetooth*” in “TROUBLESHOOTING” (P. 24).



- This unit can be paired with up to eight connecting devices. When pairing with the ninth device has succeeded, pairing data for the device with the oldest connection date will be deleted.
- If this unit is connected via *Bluetooth* to another device, disconnect the *Bluetooth* connection before you perform the pairing operation (P. 13).

Note

Yamaha does not guarantee all connections between this unit and *Bluetooth* device.

Front panel

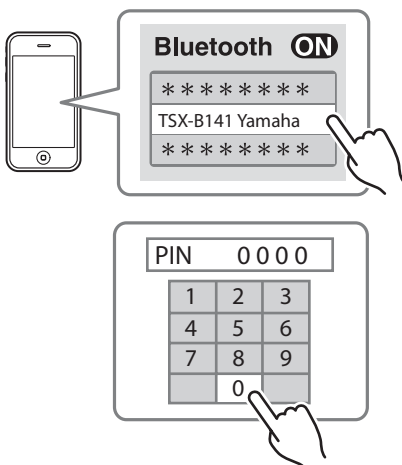
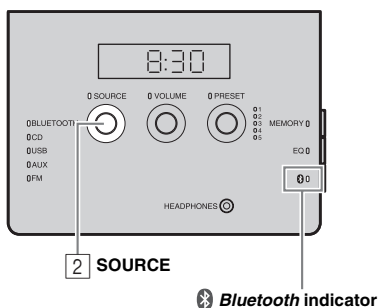

- 1 Press to turn on the unit.
- 2 Set SOURCE to BLUETOOTH.

◆ If using an iPod touch/iPhone/iPad

- 3 On your iPod touch/iPhone/iPad, turn [Settings] → [Bluetooth] on.

The *Bluetooth* connection list will appear in [Devices]. (This procedure or display may differ depending on the type of your iPod touch/iPhone/iPad.)

- 4 From the *Bluetooth* connection list of the connecting device, choose this unit (TSX-B141 Yamaha).

When pairing has been completed, your iPod touch/iPhone/iPad will indicate “Connected”. The *Bluetooth* indicator on the front panel display of this unit will light.

◆ If using other than an iPod touch/iPhone/iPad

- 3 Perform *Bluetooth* pairing on the connecting device.

For details refer to the owner's manual of the connecting device.

- 4 From the *Bluetooth* connection list of the connecting device, choose this unit (TSX-B141 Yamaha).

When pairing has been completed, the *Bluetooth* indicator on the front panel display of this unit will light for about 1 second.



If you are asked to enter a password, enter the numerals “0000”.

◆ Easy pairing

For the smartphone with NFC (Near Field Communication) function, you can easily perform the pairing operation just by holding the smartphone over the NFC mark (you need to turn the unit on and turn on the NFC function of the smartphone beforehand).

Top panel

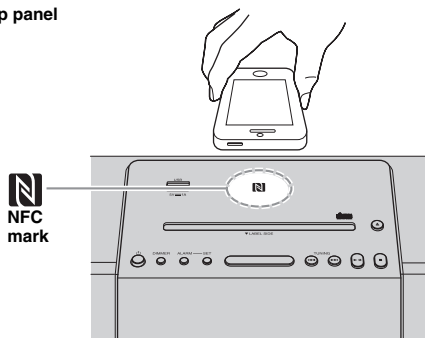

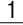
- 1 Press  to turn the unit on.
- 2 Hold the smartphone over the NFC mark.
- 3 Perform the pairing operation at the smartphone (for details, please read the owner's manual of the smartphone).

This unit is indicated as "TSX-B141 Yamaha" on the smartphone.



- If you are prompted for a passkey, enter the numerals "0000".
- If the connection fails, move the smartphone slowly on the NFC mark.
- If the smartphone is equipped with a case, remove the case.

Listening to a Bluetooth device

Front panel

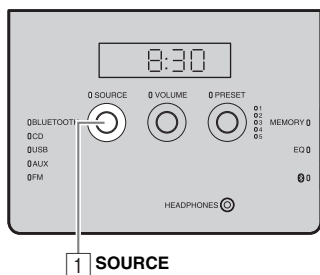

- 1 Set **SOURCE** to **BLUETOOTH**.
- 2 Connect this unit and your connecting device via **Bluetooth**.
- 3 Play back music from your **Bluetooth** device.

Note

Take care that the volume setting of this unit is not too high.



- If you connect via **Bluetooth** from your connecting device and play back music while the unit is in standby mode, the unit will automatically turn on.
- If you disconnect the **Bluetooth** connection from your connecting device while the playback source is set to **Bluetooth**, the unit will automatically enter standby mode.
- If the Auto Standby is enabled and **Bluetooth** is selected as the playback source, 20 minutes with no **Bluetooth** connection and no operation makes the unit enter standby mode automatically.

Connecting an already-paired device via *Bluetooth*

Once pairing has been completed, connecting a *Bluetooth* will be easy the next time.

◆ Connecting from this unit

Front panel

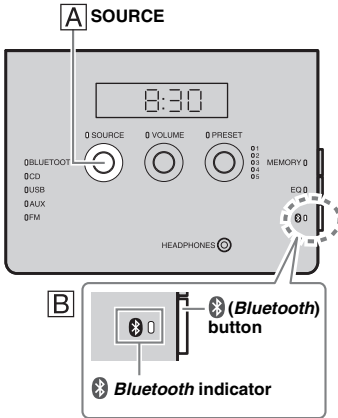

Follow procedure **A** or **B** below to connect the device.

A Set SOURCE to BLUETOOTH.

B Press the  (*Bluetooth*) button on the right side of the front control panel.

The *Bluetooth* indicator will blink on the front panel display; this unit will search for the connecting device that was most recently connected via *Bluetooth*, and will then establish a connection (You must first turn on the *Bluetooth* setting of the connecting device).

When the *Bluetooth* connection has been established, the *Bluetooth* indicator will light.

◆ Connecting from the connecting device

1 In the *Bluetooth* settings of the connecting device, turn *Bluetooth* on.

2 From the *Bluetooth* connection list of the connecting device, choose this unit (TSX-B141 Yamaha).

The *Bluetooth* connection will be established, and the *Bluetooth* indicator on the front panel display of this unit will light.

◆ Connecting with the NFC function



When using an already-paired smartphone with the NFC function, holding it over the NFC mark establishes a *Bluetooth* connection.

Note

Bluetooth connections cannot be established from the connecting device when this unit is in Eco Standby mode. Turn the unit on.

Disconnecting a *Bluetooth* connection

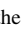
If any of the following operations are performed while a *Bluetooth* connection is established, the *Bluetooth* connection will be disconnected.

- Press the  (*Bluetooth*) button on the unit. (Or hold down  on the remote control.)
- Set the unit to standby mode.
- Turn off the *Bluetooth* setting of the connecting device.
- Hold the smartphone with the NFC function over the NFC mark during *Bluetooth* connection.

LISTENING TO RADIO STATIONS

Tuning radio stations

Top/front panel

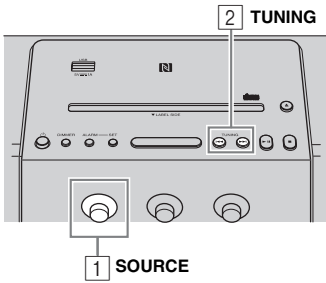

- 1 Set **SOURCE** to FM.
- 2 Press **◀◀/▶▶** to tune the FM station.

Tuning type	Operation of TUNING
Automatic tuning	Press and hold down ◀◀ or ▶▶ .
Manual tuning	Press ◀◀ or ▶▶ repeatedly.

Note

If you tune to an FM station manually, the sound will be in monaural.

Storing FM stations (preset)

You can store 5 favorite FM stations with the preset function.

Front panel

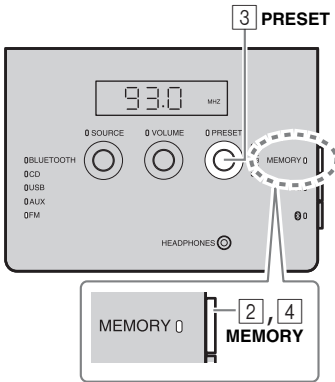

- 1 Tune into a favorite radio station.
- 2 Press **MEMORY**.
- 3 Select the preset number you want to store to with **PRESET**.



To cancel the preset, press **TUNING** again.

- 4 Press **MEMORY** to complete. Presetting completes.

Selecting preset radio stations

Front panel

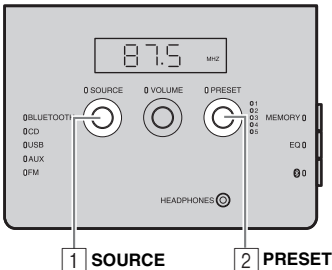

- 1 Set **SOURCE** to FM.
- 2 Select the preset radio station with **PRESET**.

(Or press  /  on the remote control.)

LISTENING TO EXTERNAL SOURCE

Rear panel

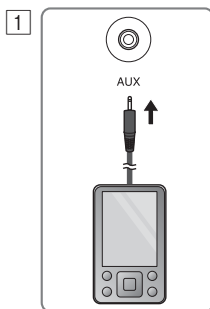

Top/front panel

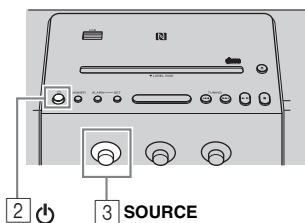

Set the unit to standby mode before connecting audio cables.

- 1 Connect external audio device to AUX on the rear panel using a commercially available 3.5 mm (1/8 in) stereo mini plug cable.

Note

Turn down the volume of the unit and your external audio device before connection.

- 2 Press **⏻** to turn the unit on.
- 3 Set **SOURCE** to **AUX**.
- 4 Start playback on the connected external audio device.

TONE CONTROL

Front panel

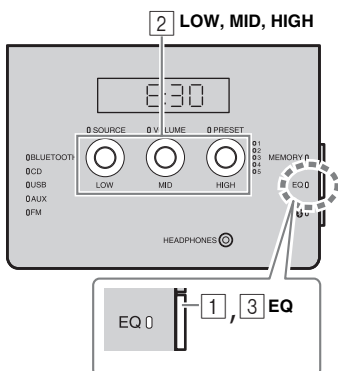

- 1 Press **EQ** during playback. LOW, MID and HIGH flash.
- 2 Adjust the tone with **LOW**, **MID** and **HIGH**. Each tone can be adjusted from -5 to +5.
- 3 Press **EQ** to complete.

USING ALARM FUNCTION

IntelliAlarm

The unit includes an alarm function (IntelliAlarm) that plays back music sources or set of beeps (built-in alarm) at the set time in a variety of different methods. The alarm function has following features.

◆ 3 types of alarms

Select from 3 alarm types, combining music and beep sounds.

SOURCE + BEEP	The selected audio source and beep sound are played at the set time. This mode is recommended for the best possible start to the day. 3 minutes before the set time: the source music begins to fade in and the volume gradually increases as the alarm time approaches. Alarm time: a beeping sound also begins playing.
SOURCE	The selected audio source is played at the set time. The volume fades in gradually and increases to the set volume.
BEEP	Only beep sound is played back at the set time.

◆ Music sources

Audio CD, data CD, USB device and radio can be selected. The following can also be selected depending on the audio source:

Source	Playback method	Function
Audio CD	Track	The selected track is played repeatedly.
	Resume	The track you listened to last time is played back.
Data CD/USB	Folder	The selected folder is played repeatedly.
	Resume	The track you listened to last time is played back.
FM radio	Preset station	The selected preset radio station is played.
	Resume	The radio station you listened to last time is played back.

◆ Snooze

The snooze function can be enabled to replay the alarm after 5 minutes (Ⓢ P. 18).

Alarm setting

◆ Setting the alarm time and sound

Top/front panel

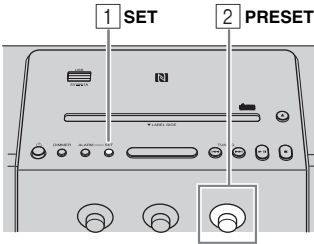

1 Press **SET**.

Alarm indicator ((●)) and setting items flash.



Alarm indicator

2 Set the alarm time with **PRESET**.

Rear panel

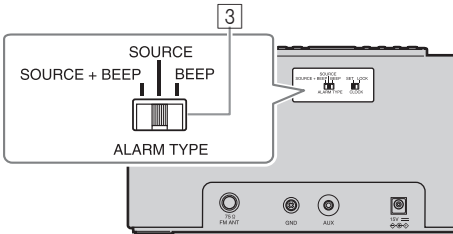

3 Set the alarm type with **ALARM TYPE**.

Select from SOURCE+BEEP, SOURCE or BEEP. For the details on alarm type, refer to “3 types of alarms” (P. 16).

Top/front panel

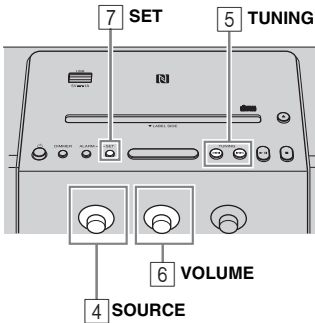

4 Select the source with **SOURCE** (as required).

When you select SOURCE+BEEP or SOURCE, select the music source. A source other than *Bluetooth* or AUX can be selected.

5 Select a track, folder or radio station with **TUNING** (as required).

When the source is CD/USB/FM, select a track, folder or radio station for alarm with \lll/\ggg .



- When CD/USB is selected and “0” is set as track/folder number, the track you listened to last time is resumed.

- When FM is selected and no preset indicator (P. 5) is lit, the radio station you listened to last time is played.

6 Set the alarm volume with **VOLUME**.

7 Press **SET** to complete.

Alarm is set and the alarm indicator ((●)) lights up.

Turning the alarm on/off

Top panel

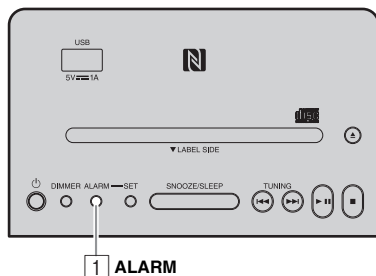

1 Press **ALARM**.

When the alarm is on, the alarm indicator ((●)) is shown, and the alarm time is shown for a while. If you press **ALARM** again, the alarm indicator ((●)) and the alarm will turn off.

When alarm mode is Weekly Alarm (see P. 19), the Weekly Alarm indicator (WEEKLY) will also turn on/off.



The alarm setting will be saved even if the alarm is turned off. If the alarm is turned on again by pressing **ALARM**, the alarm will sound with the previous alarm settings.

Operations while alarm is sounding

At the set time, the alarm sounds. During playback, the following operations are available.

◆ Stopping the alarm for a short time (snooze)

Top panel

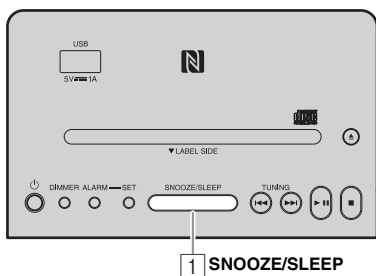

1 Press **SNOOZE/SLEEP**.

Snooze function will stop the alarm and resume again in 5 minutes.



• Press **SNOOZE/SLEEP**.

Once: Beep stops.

Twice: Music source stops (snooze function).



Four minutes after the music source is stopped, it will start fading in.



After one additional minute after the music source starts fading in, the beep is emitted.

- The alarm indicator will flash when the snooze function is activated.

◆ Turning the alarm off

Top panel

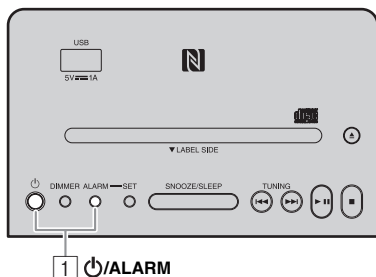

1 Press **ALARM** or **⏻**.



- The alarm stops automatically after 60 minutes unless you stop the alarm.
- The alarm setting will be saved even if the alarm is turned off. If the alarm is turned on again by pressing **ALARM**, the alarm will sound with the previous alarm settings.

Setting Weekly Alarm

◆ Setting Weekly Alarm with DTA CONTROLLER

With DTA CONTROLLER (P. 2), you can use Weekly Alarm, which allows you to set alarm times respectively for each day of the week. First, make the Weekly Alarm settings on DTA CONTROLLER.

IntelliAlarm setting screen

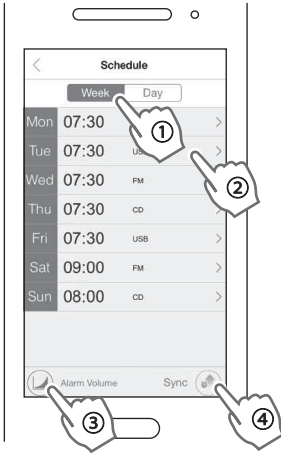

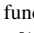
- 1 Tap  (IntelliAlarm icon) in DTA CONTROLLER to open the IntelliAlarm setting screen.
- 2 Perform the operations below on the IntelliAlarm setting screen.
 - ① Select [Week] (Weekly Alarm).
 - ② Set the alarm time for each day of the week.
 - ③ Set the alarm volume or IntelliAlarm advanced settings.
 - ④ Tap [Sync] to transfer the settings to the unit. The Weekly Alarm function is activated and the alarm indicator () and Weekly Alarm indicator (WEEKLY) turn on.



◆ Setting Weekly Alarm on the unit

Once you have set Weekly Alarm by DTA CONTROLLER, you can select the Weekly Alarm mode in the alarm mode select display of this unit.

Top panel

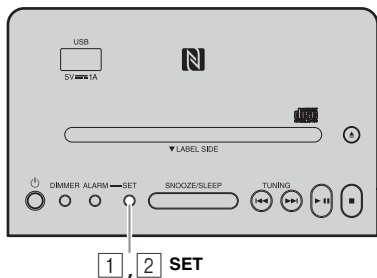

Front panel

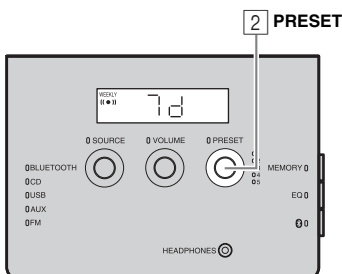

1 Press SET.

The alarm indicator ((●)) will flash and the alarm mode select display will appear.

2 Select the alarm mode.

Rotate **PRESET** to select the alarm mode, and press **SET** to confirm it.

1d (One Day Alarm mode):

An alarm that sounds only once at the specified time.



Alarm indicator

7d (Weekly Alarm mode):

An alarm whose time can be specified for each day of the week (settable only using "DTA CONTROLLER").



Weekly Alarm indicator

Alarm indicator

If you have chosen Weekly Alarm mode, this completes the alarm setting. The alarm indicator ((●)) and the Weekly Alarm indicator (WEEKLY) will light up.

Note

The Weekly Alarm mode cannot be selected when all the days of the Weekly Alarm setting are turned off. Turn on any day of the Weekly Alarm setting.

USING THE SLEEP TIMER

You can set the time until the unit automatically enters standby mode.

Top panel

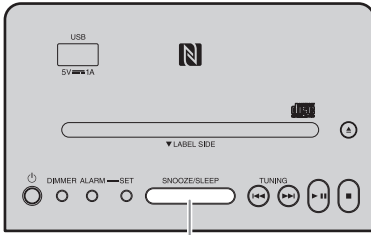

1 SNOOZE/SLEEP

- 1 Press **SNOOZE/SLEEP** a number of times to set the time until the system enters standby mode.

The sleep timer can be set to 30, 60, 90 and 120 minutes.

When the time is set, the sleep indicator (z^z) is shown on the front panel display.



Sleep indicator



If you press **SNOOZE/SLEEP** while the sleep timer is activated, the sleep timer setting will be canceled.

ADJUSTING BRIGHTNESS OF FRONT PANEL DISPLAY

Top panel

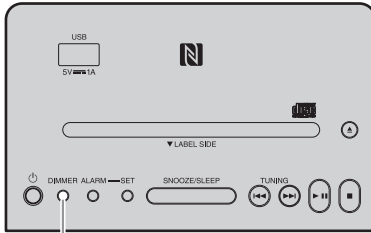

1 DIMMER

- 1 Press **DIMMER**.

Each time the button is pressed, the setting changes in the following order:

A (auto) → 3 (brightest) → 2 → 1 (darkest) → back to A

Note

When AUTO is set, the brightness of the front panel display is adjusted automatically with the illumination sensor (see P. 5). Ensure that the sensor is not covered.



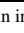

TROUBLESHOOTING

If there is a problem with the unit, check the following list first. If the problem you are experiencing is not listed below or if the instructions below do not help, turn off the unit, disconnect the power cable, and contact the nearest authorized Yamaha dealer or service center.

General

Problem	Cause	Solution
Cannot turn on the unit.	The power cable is not connected firmly.	Reconnect the power cable into the wall outlet and the unit firmly.
	The unit may have received a strong electrical shock such as lightning or excessive static electricity.	Disconnect the power cable. Wait about 30 seconds, reconnect the power cable, and turn on the unit.
The speakers make no sound.	The volume may be set to the minimum level.	Adjust the volume level.
	The source may be incorrect.	Select the correct source.
	Auto Standby is activated.	Turn on the unit again.
Sound suddenly turns off.	The sleep function (Ⓔ P. 21) may be set.	Turn on the unit and play the source again.
	Auto Standby is activated.	Turn on the unit again.
Sound is cracked/distorted or there is abnormal noise.	Input source volume is excessive, or volume of this unit is excessive (especially Bass).	Adjust volume with VOLUME , or adjust Bass with EQ (Ⓔ P. 15).
The unit does not operate properly.	The unit may have received a strong electrical shock such as lightning or excessive static electricity, or power supply may have dropped.	Set the unit to standby mode and disconnect the power cable. Wait about 30 seconds, reconnect the power cable, and turn the unit on.
The unit turns on but immediately enters standby mode.		
A digital or high-frequency equipment produces noises.	The unit may be placed too close to the digital or high-frequency equipment.	Place the unit further away from the equipment.
The clock setting has been cleared.	The unit is left more than one week after you disconnect the power cable from the wall outlet.	Plug the power cable into the wall outlet firmly, and set the clock again (Ⓔ P. 7).
The selected source does not play back at the alarm time.	No CD or USB device is inserted.	Insert a CD or USB device.
	ALARM TYPE switch is set to BEEP.	Set ALARM TYPE to SOURCE + BEEP or SOURCE (Ⓔ P. 16).
Clock flashes and the unit cannot be operated.	CLOCK switch on the rear panel is set to SET, and this unit is in clock setting mode.	Set CLOCK switch to LOCK (Ⓔ P. 7).
Auto Standby is inactive.	The unit may have picked up ambient noise.	If the unit is close to portable phones, wireless devices, microwave ovens, fluorescent light, place the unit further away from them.
The front display becomes dim.	The front display setting is set to AUTO.	Set the brightness of the front panel display to a setting other than AUTO. Or, do not cover the illumination sensor.
Cannot charge the connected portable USB device.	An incompatible USB device is connected to the unit. Or the USB device is not connected to this unit properly.	Press  to enter standby mode, and reconnect the USB device to the unit. If it does not resolve the problem, the USB device is not chargeable with the unit.

CD playback

Problem	Cause	Solution
Disc cannot be inserted.	The unit is set to Eco Standby mode.	Press  to cancel Eco Standby mode (☞ P. 4).
	A disc is already inserted.	Press  to eject the disc.
Some button operations do not work.	The disc loaded into the unit may not be compatible.	Use a disc supported by the unit (☞ P. 26).
Playback does not start after pressing  (playback stops immediately).	The disc may be dirty.	Wipe the disc clean.
	The disc loaded into the unit may not be compatible.	Use a disc supported by the unit (☞ P. 26).
	If the unit was moved from a cold to warm place, condensation may have formed on the disc reading lens.	Wait for an hour or two until the unit adjusts to the room temperature, and try again.
The CD indicator flashes twice, and repeated 3 times, and the disc is ejected.	The disc loaded into the unit may not be compatible.	Use a disc supported by the unit (☞ P. 26).
	The disc may be dirty.	Wipe the disc clean.
	The disc does not contain playable files.	Use a disc contains playable files (☞ P. 26, 27).
	The disc is loaded back to front.	Insert a disc facing the label side to near side.
“Err” is displayed in the front panel display after loading a disc.	An error occurs in the unit.	Eject the disc with  .

USB device playback

Problem	Cause	Solution
MP3/WMA file in the USB device does not play.	The USB device is not recognized.	Set the unit to standby mode and disconnect the USB device. Then, turn the unit on and reconnect the USB device.
		Connect an AC adaptor if supplied with the device.
The USB indicator flashes twice, and repeated 3 times, after connecting a USB device.	An incompatible USB device is connected to the unit.	Set the unit to standby mode and reconnect the USB device to the unit. If it does not resolve the problem, the USB device is not playable on the unit.
	The USB device does not contain playable files.	Use a USB device contains playable files (☞ P. 26, 27).

Bluetooth

Problem	Cause	Solution
Cannot make this unit paired with the connecting device.	The unit is already connected with another device.	Disconnect the already connected <i>Bluetooth</i> device.
	The connecting device does not support A2DP.	Perform pairing operations with a device which supports A2DP.
	A <i>Bluetooth</i> adaptor, etc. that you want to pair with this unit has a password other than "0000".	Use a <i>Bluetooth</i> adaptor, etc. whose password is "0000".
	This unit and the connecting device are too far apart.	Move the connecting device closer to this unit.
	There is a device (microwave oven, wireless LAN, etc.) outputs signals in the 2.4 GHz frequency band nearby.	Move this unit away from the device that is emitting radio-frequency signals.
Cannot establish a <i>Bluetooth</i> connection.	This unit is not registered on the connecting device's <i>Bluetooth</i> connection list.	Perform pairing operations again (☞ P. 11).
	Another <i>Bluetooth</i> device is already connected.	Terminate the current <i>Bluetooth</i> connection.
	The <i>Bluetooth</i> function of the device is turned off.	Turn on the <i>Bluetooth</i> function of the device.
	The pairing information has been deleted.	Perform pairing again (☞ P. 11). This unit can be paired with up to eight connecting devices. When pairing with the ninth device has succeeded, pairing data for the device with the oldest connection date will be deleted. On iPhone, iPad, or iPod touch, delete the pairing history with this unit and perform pairing again.
No sound is produced or the sound is interrupted during playback.	The <i>Bluetooth</i> connection of this unit with the connecting device is disconnected.	Perform <i>Bluetooth</i> connection operations again (☞ P. 13).
	This unit and the connecting device are too far apart.	Move the connecting device closer to this unit.
	There is a device (microwave oven, wireless LAN, etc.) outputs signals in the 2.4 GHz frequency band nearby.	Move this unit away from the device that is emitting radio-frequency signals.
	The connecting device's <i>Bluetooth</i> function is off.	Turn on the <i>Bluetooth</i> function of the connecting device.
	The connecting device is not set to send <i>Bluetooth</i> audio signals to this unit.	Check that the <i>Bluetooth</i> function of the connecting device is set properly.
	The pairing setting of the connecting device is not set to this unit.	Set the pairing setting of the connecting device to this unit.
	The connecting device's volume is too low.	Increase the volume level.

FM radio reception

Problem	Cause	Solution
Too much noise.	The antenna may be connected improperly.	Make sure the antenna is connected properly (☞ P. 6) or use a commercially available outdoor antenna.
Too much noise during stereo broadcast	The radio station you selected may be far from your area, or the radio wave reception is weak in your area.	Try manual tuning to improve the signal quality (☞ P. 14) or use a commercially available outdoor antenna.
Even with an outdoor antenna, radio wave reception is weak. (Sound is distorted.)	Multipath reflection or other radio interferences may have occurred.	Change the height, direction, or placement of the antenna.

Remote control

Problem	Cause	Solution
The remote control does not work properly.	The remote control may be operated outside its operation range.	For information on the remote control operation range, refer to "Using the remote control" (☞ P. 3).
	The remote control signal receiver on the unit (☞ P. 3) may be exposed to direct sunlight or lighting.	Change the lighting or orientation of the unit.
	The battery may be worn out.	Replace the battery with a new one.
	There are obstacles between the remote control signal receiver on the unit and the remote control.	Remove the obstacles.

NOTES ON DISCS AND USB DEVICES

CD information

This unit is designed for use with audio CD, CD-R*, and CD-RW* with the logos followings.



* ISO 9660 format CD-R/RW



A disc logo mark is printed on the disc and the disc jacket.

Note

- Do not load any other type of disc into this unit. Doing so may damage this unit.
- CD-R/RW cannot be played back unless finalized.
- Some discs cannot be played back depending on the disc characteristics or recording conditions.
- Do not use any non-standard shaped discs such as a heart-shaped disc.
- Do not use discs with many scratches on their surface.
- Do not load a cracked, warped, or glued disc.
- Do not use 8-cm discs.

Handling a disc

- Do not touch the surface of the disc. Hold a disc by its edge (and the center hole).
- Do not use a pencil or pointed marker to write on the disc.
- Do not put a tape, seal, glue, etc., on a disc.
- Do not use a protective cover to prevent scratches.
- Do not load more than one disc into this unit at one time. This can cause damage to both this unit and the discs.
- Do not insert any foreign objects into the disc slot.
- Do not expose a disc to direct sunlight, high temperature, high humidity, or a lot of dust.



Caution

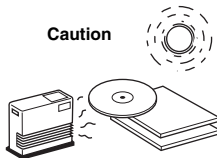

- If a disc becomes dirty, wipe it with a clean, dry cloth from the center out to the edge. Do not use record cleaner or paint thinner.
- To avoid malfunction, do not use a commercially available lens cleaner.

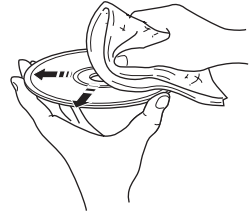

USB device information

About the USB devices playable with this unit

This unit supports USB mass storage class devices (e.g., flash memories or portable audio players) using FAT16 or FAT32 format.

About power supply to USB devices: This unit supplies power (max. 1A) to USB devices (other than in Eco standby mode).

Note

- Some devices may not work properly even if they meet the requirements.
- Do not connect devices other than USB mass storage class devices (such as USB chargers or USB hubs), PCs, card readers, an external HDD, etc.
- Yamaha will not be held responsible for any damage to or data loss on the USB device occurring while the device is connected to this unit.
- Playability of and power supply to all kind of USB devices are not guaranteed.
- USB devices with encryption cannot be used.

About MP3 or WMA files

Note

- The unit can play back:

File	Bitrate (kbps)	Sampling frequency (kHz)
MP3	8 - 320**	16 - 48
WMA	16 - 320**	22.05 - 48

** Both constant and variable bitrates are supported.

- The maximum numbers of files/folders that can be played on the unit are as follows.

	Data CD	USB
Maximum total number of file	512	9999
Maximum folder number	255	128
Maximum file number per folder	511	255

- Copyright-protected files cannot be played back.

SPECIFICATIONS

◆ PLAYER

CD

- Media CD, CD-R/RW
- Audio format Audio CD, MP3, WMA

Laser

- Type Semiconductor laser GaAs/GaAlAs
- Wave length 790 nm
- Output power 7 mW

USB

- Audio format MP3, WMA

AUX

- Input connector 3.5 mm (1/8 in) STEREO mini jack

◆ Bluetooth

- *Bluetooth* version Ver. 2.1 +EDR
- Supported protocols A2DP
- Supported codecs SBC, AAC, aptX®
- Wireless output *Bluetooth* Class 2
- Maximum communication distance 10 m (without obstructions)

◆ NFC (Near Field Communication)

- Supported model NFC-ready Android device Ver. 4.1 or later
- * Some models may not work or be different in the required distance for connection.

◆ TUNER

- Tuning range
FM 87.5 to 108.0 MHz

◆ GENERAL

- Power Supply AC 100 to 240 V, 50/60 Hz
- Power consumption 17 W
- Standby consumption (clock display on, *Bluetooth* Ready) 2.4 W
- Eco Standby consumption (clock display off) 0.4 W
- Time of power management (Auto Standby)
..... No signal input: about 20 minutes
..... No operation: about 8 hours
- Headphones 3.5 mm STEREO mini Jack
(Adaptive Impedance 16 to 32 Ω)
- Dimensions (W × H × D) 400 × 180 × 137 mm
(15 3/4 × 7 1/8 × 5 3/8 in)
- Weight 3.0 kg (6.6 lbs.)

Specifications are subject to change without notice.

iPad, iPhone, and iPod touch are trademarks of Apple Inc., registered in the U.S. and other countries.

Android and Google Play are trademarks of Google, Inc.



© 2013 CSR plc and its group companies.

The aptX® mark and the aptX logo are trade marks of CSR plc or one of its group companies and may be registered in one or more jurisdictions.

AVEEA71102A

Important Notice: Guarantee Information for customers in EEA* and Switzerland

English

For detailed guarantee information about this Yamaha product, and Pan-EEA* and Switzerland warranty service, please either visit the website address below (Printable file is available at our website) or contact the Yamaha representative office for your country. * EEA: European Economic Area

<http://europe.yamaha.com/warranty/>



© 2015 Yamaha Corporation

YAMAHA CORPORATION
Printed in China ZR52550